



**DESIGN**

## **MANUAL DE INSTRUCCIONES**

COMBO ESCRITORIO + CAJONERA + LIBRERO NA

COMBO ESCRITORIO + CAJONERA + LIBRERO BCO

COMBO ESCRITORIO + CAJONERA + LIBRERO B/N

MODELO: MB0444TT18-1

MODELO: MB2702TT99-3-1

MODELO: MB2702TT99-3-2

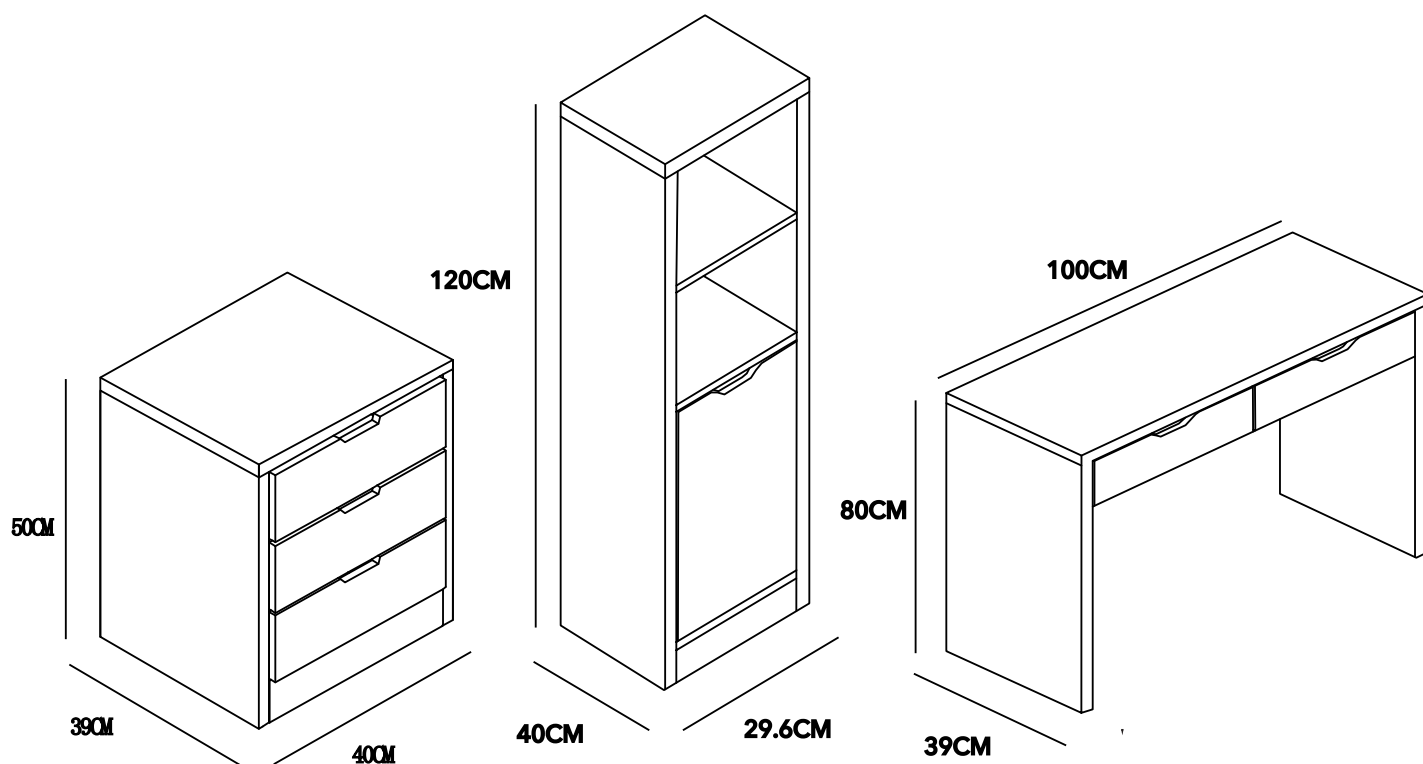

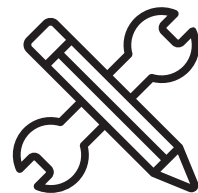

## ADVERTENCIA

Siga las instrucciones que se detallan en el manual, si presenta alguna diferencia en el contenido de sus piezas pongase en contacto con la tienda donde fue adquirido.

## RECOMENDACIONES

- Estudie atentamente las instrucciones antes del montaje.
- Ordene las piezas que componen el mueble.
- Agrupe y ordene la quincallería.
- Prepare una zona despejada para el montaje.
- Monte las piezas sin forzar los ensambles, una vez armada toda la estructura, reaprete de forma definitiva.
- Volver a apretar los tornillos después de un tiempo de uso.
- Conserve estas instrucciones de montaje.



Herramientas requeridas  
(no incluidas)



1 persona para  
el armado



Producto contenido  
en 3 cajas

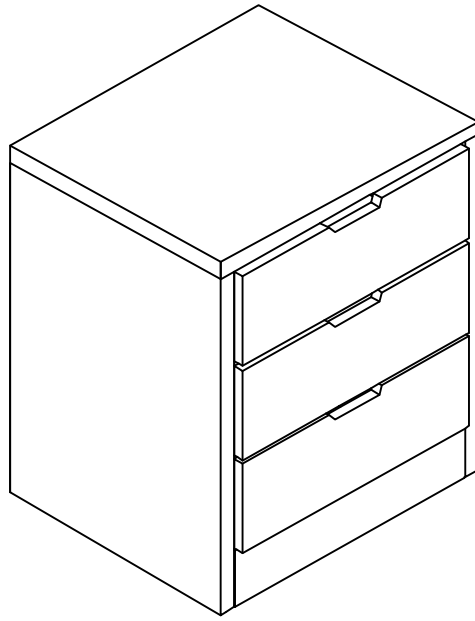

### QUINCALLERÍA

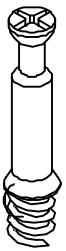

Ax10



Bx10

60mm



Cx8

30mm



Dx10



Ex8

12mm



Fx30

15mm

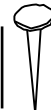

Gx12

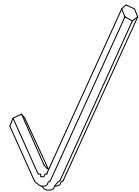

Hx1

30mm



Kx12

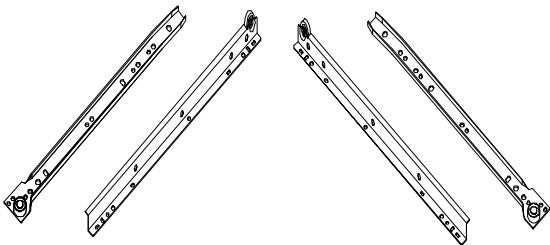

Ox3sets

# PIEZAS

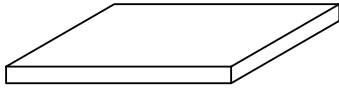

① x1

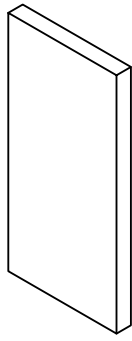

② x1

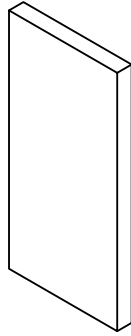

③ x1

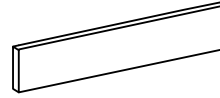

④ x1

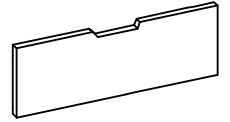

⑤ x3

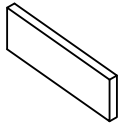

⑥ x3

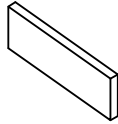

⑦ x3



⑧ x3



⑨ x3

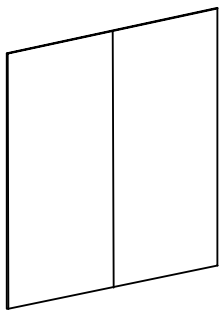

⑩ x1



⑪ x1

# PASO 1

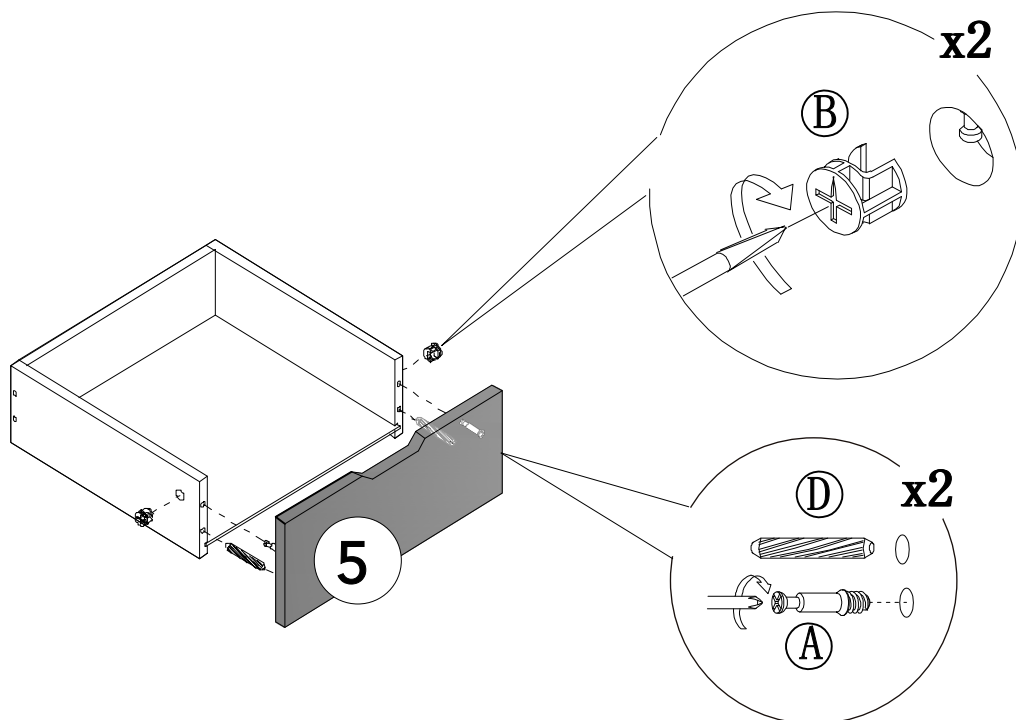
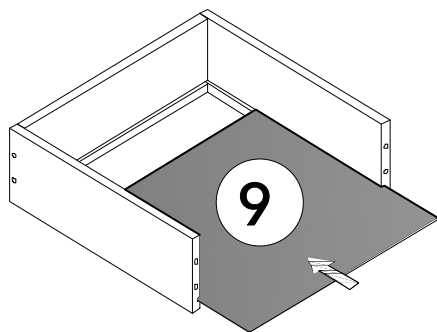
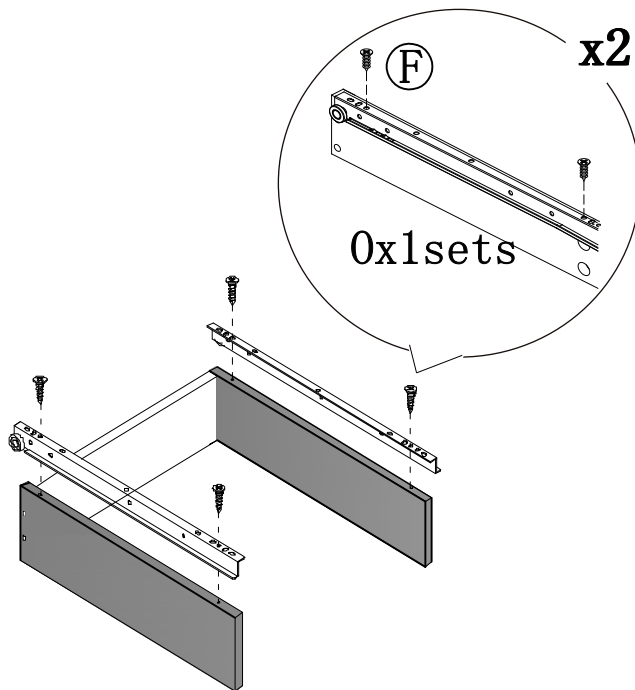
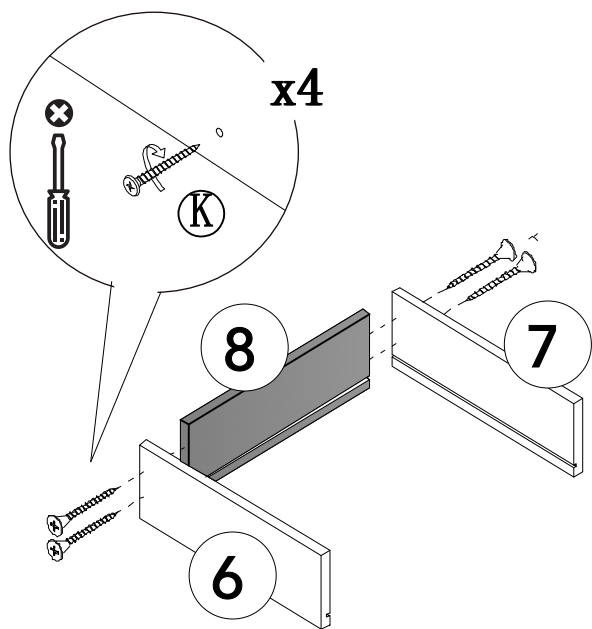

**X3**

# PASO 2

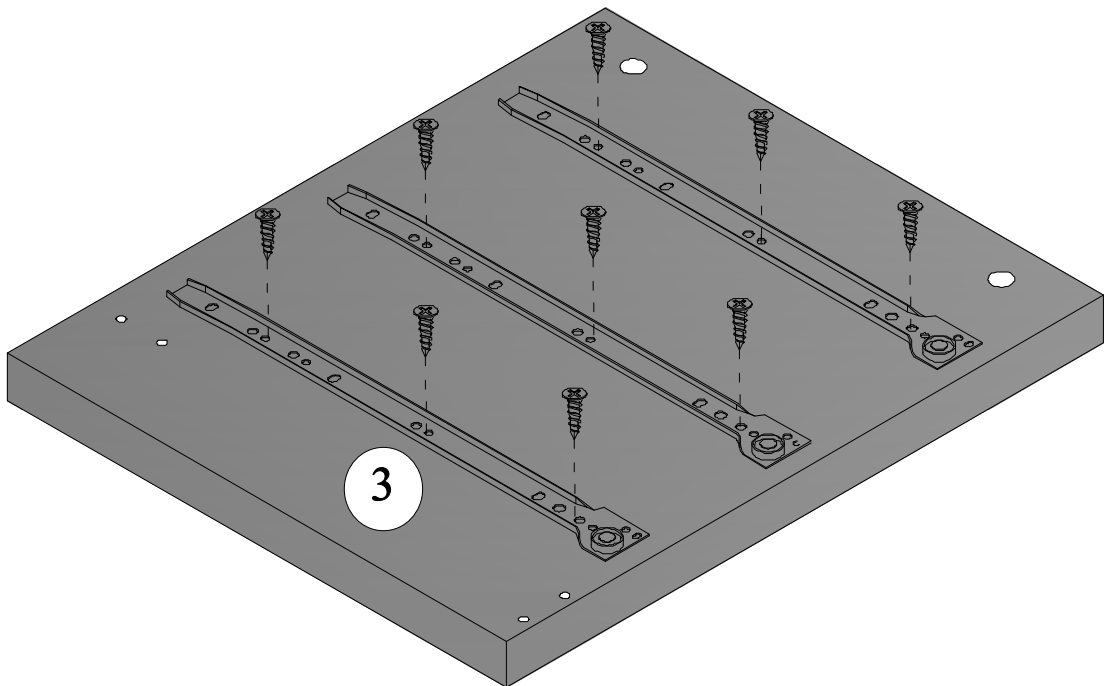
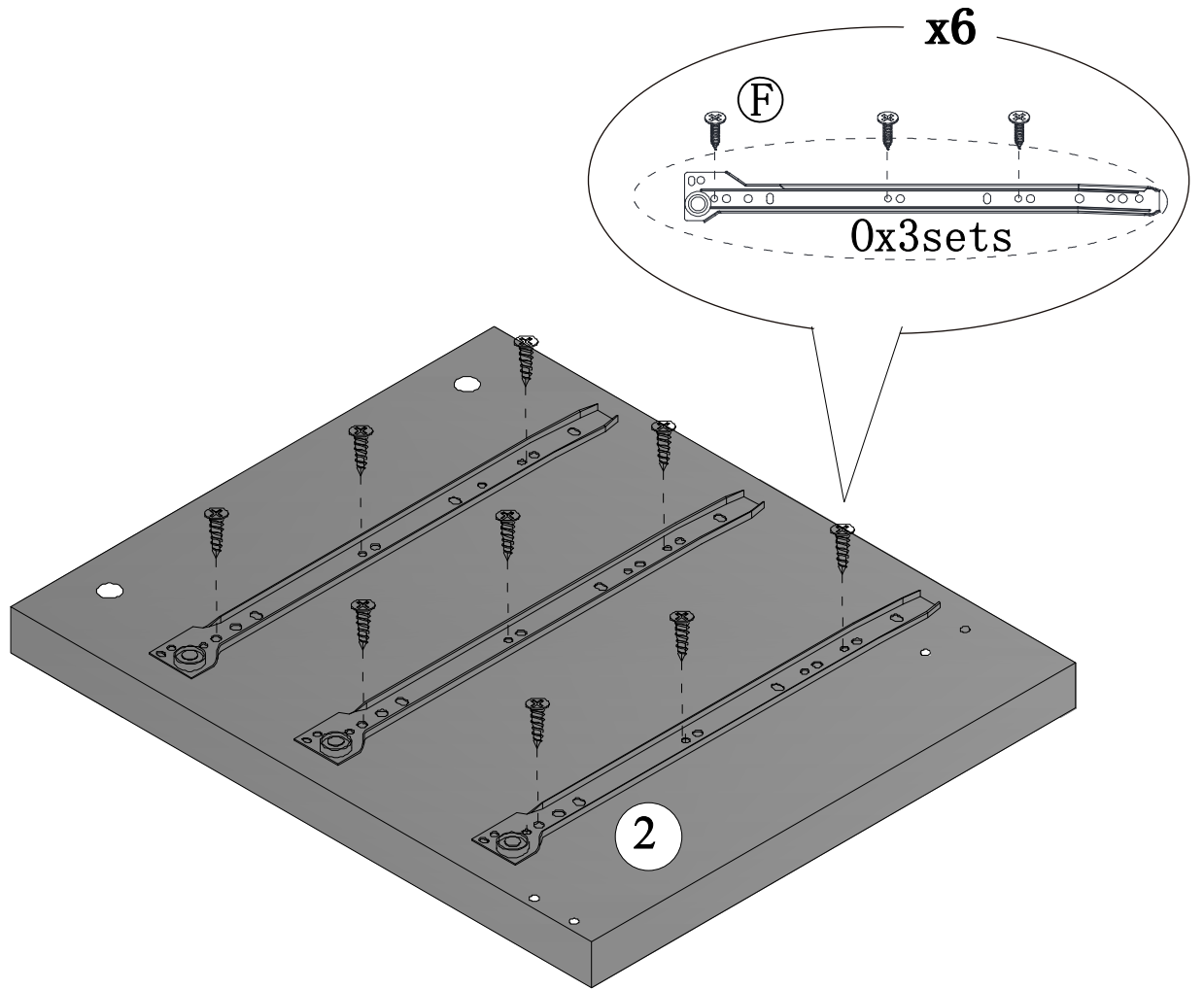

# PASO 3

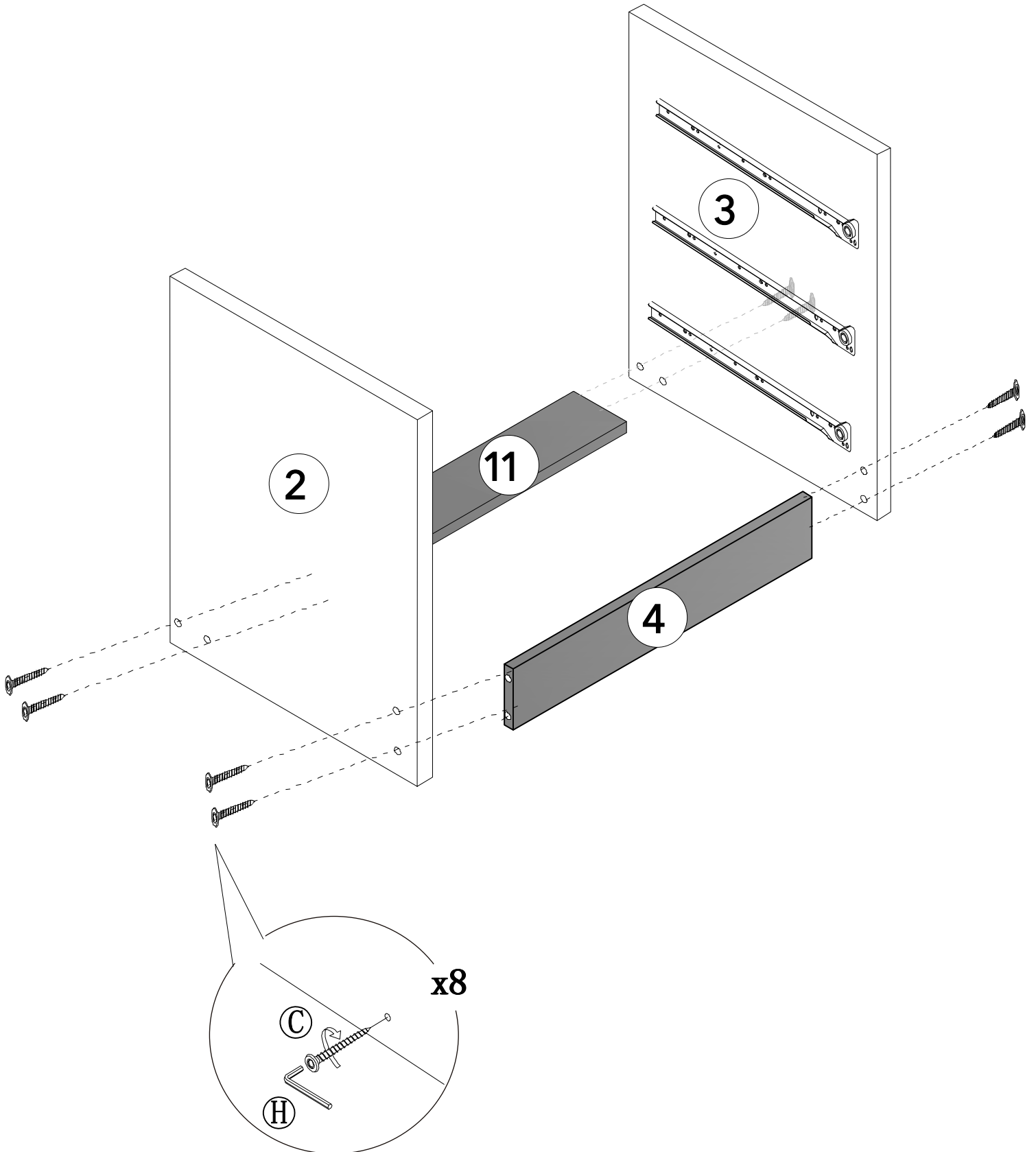

# PASO 4

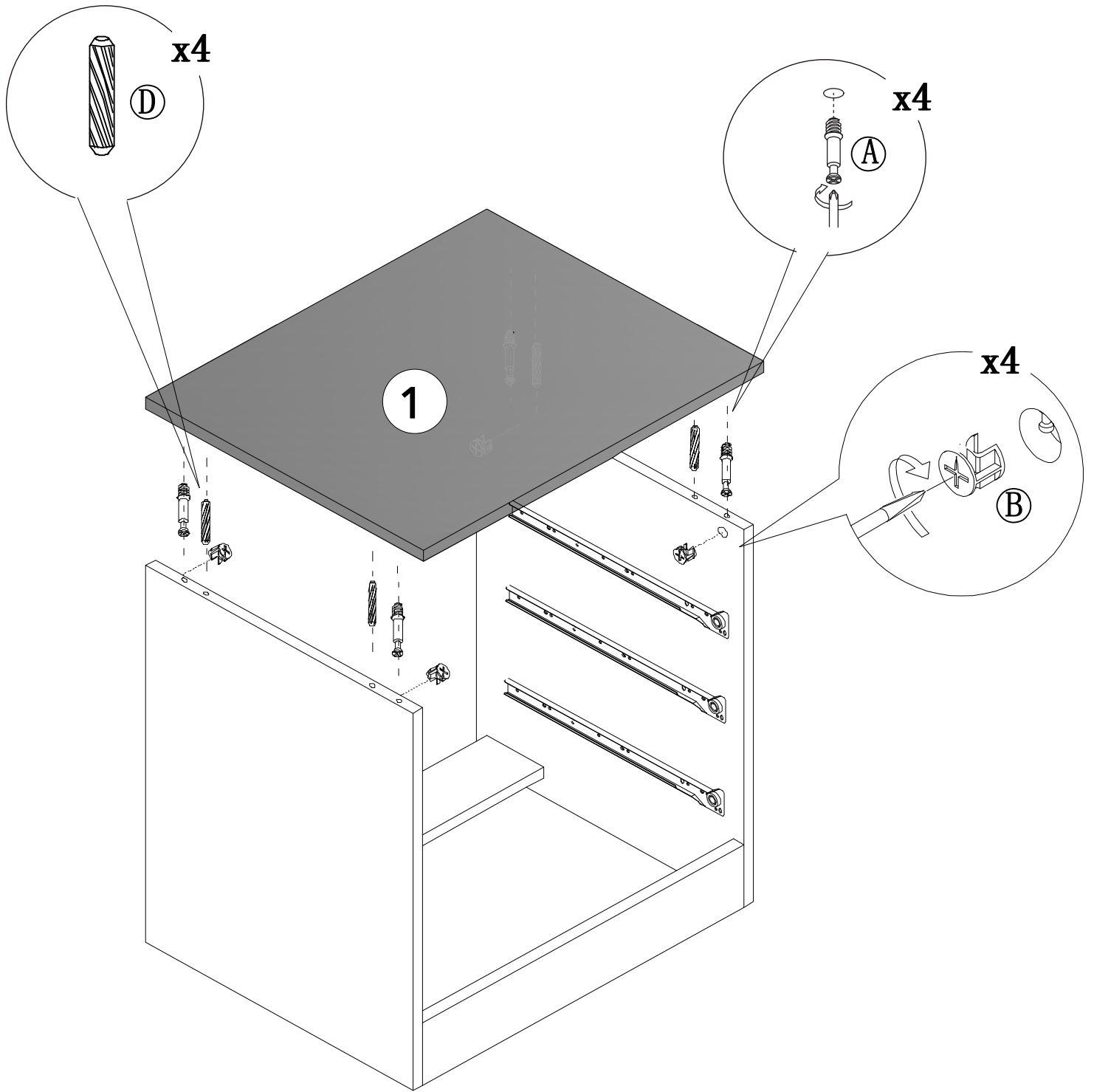

# PASO 5

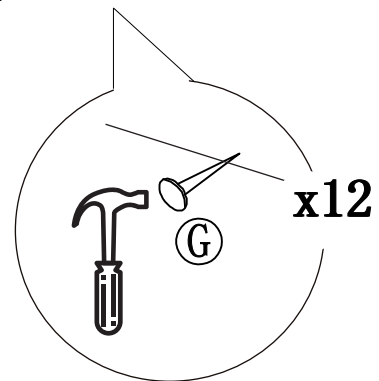
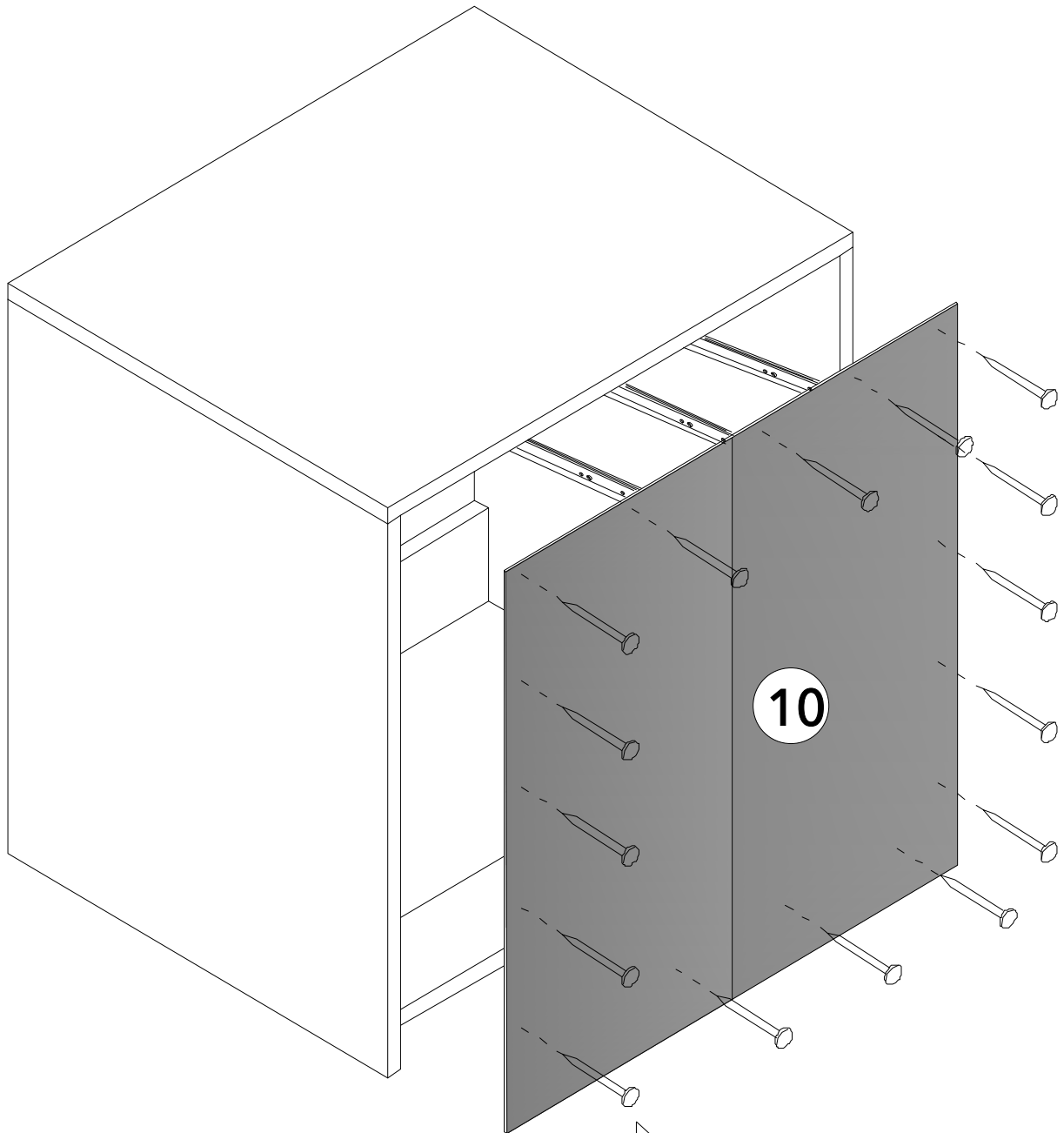

# PASO 6

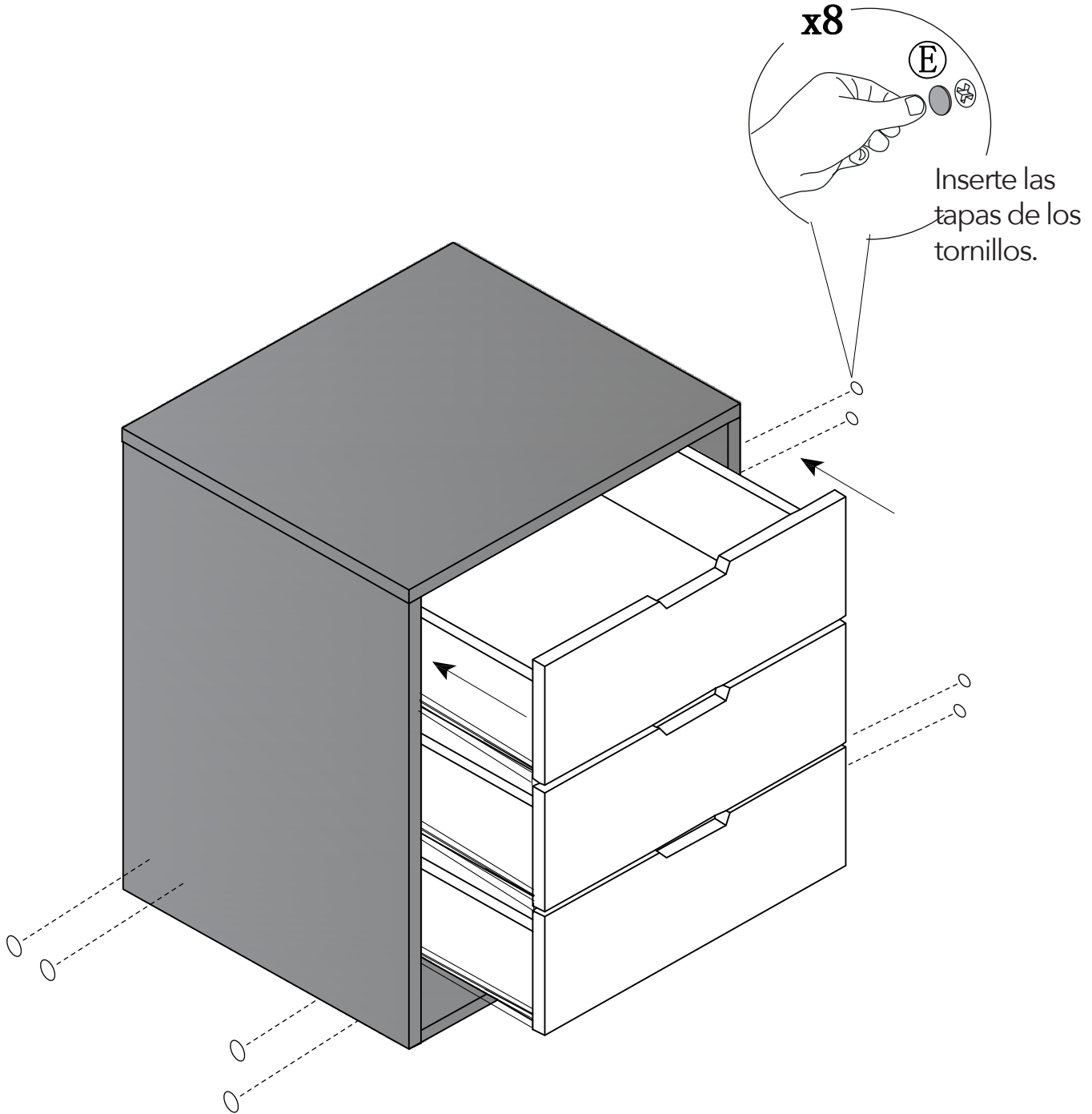

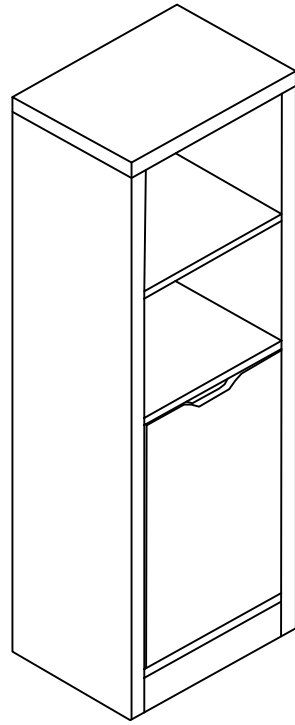

## QUINCALLERÍA

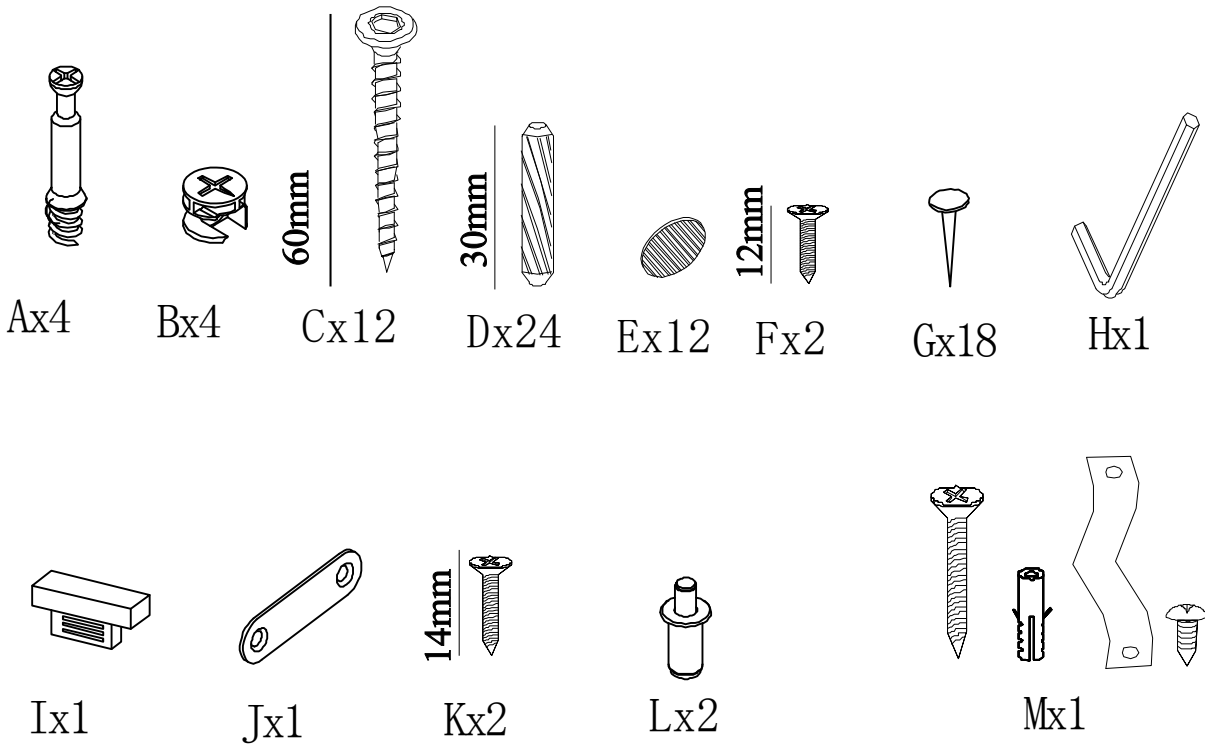

# PIEZAS

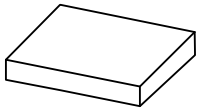

① x1

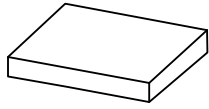

⑩ x1

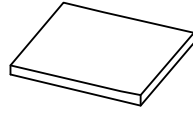

④ x1

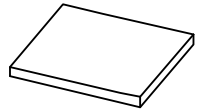

⑤ x1

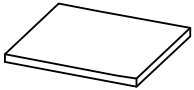

⑨ x1

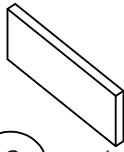

⑥ x1

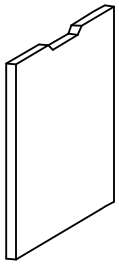

⑦ x1



⑧ x1

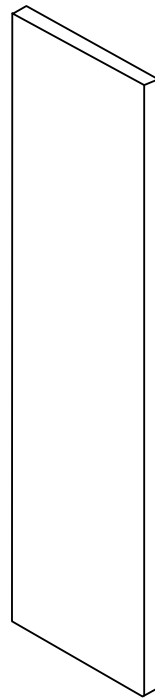

② x1

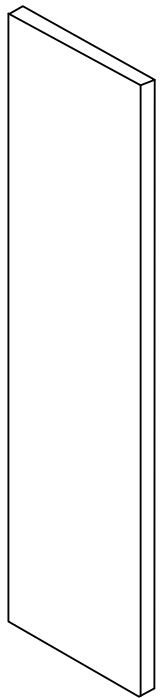

③ x1

# PASO 1

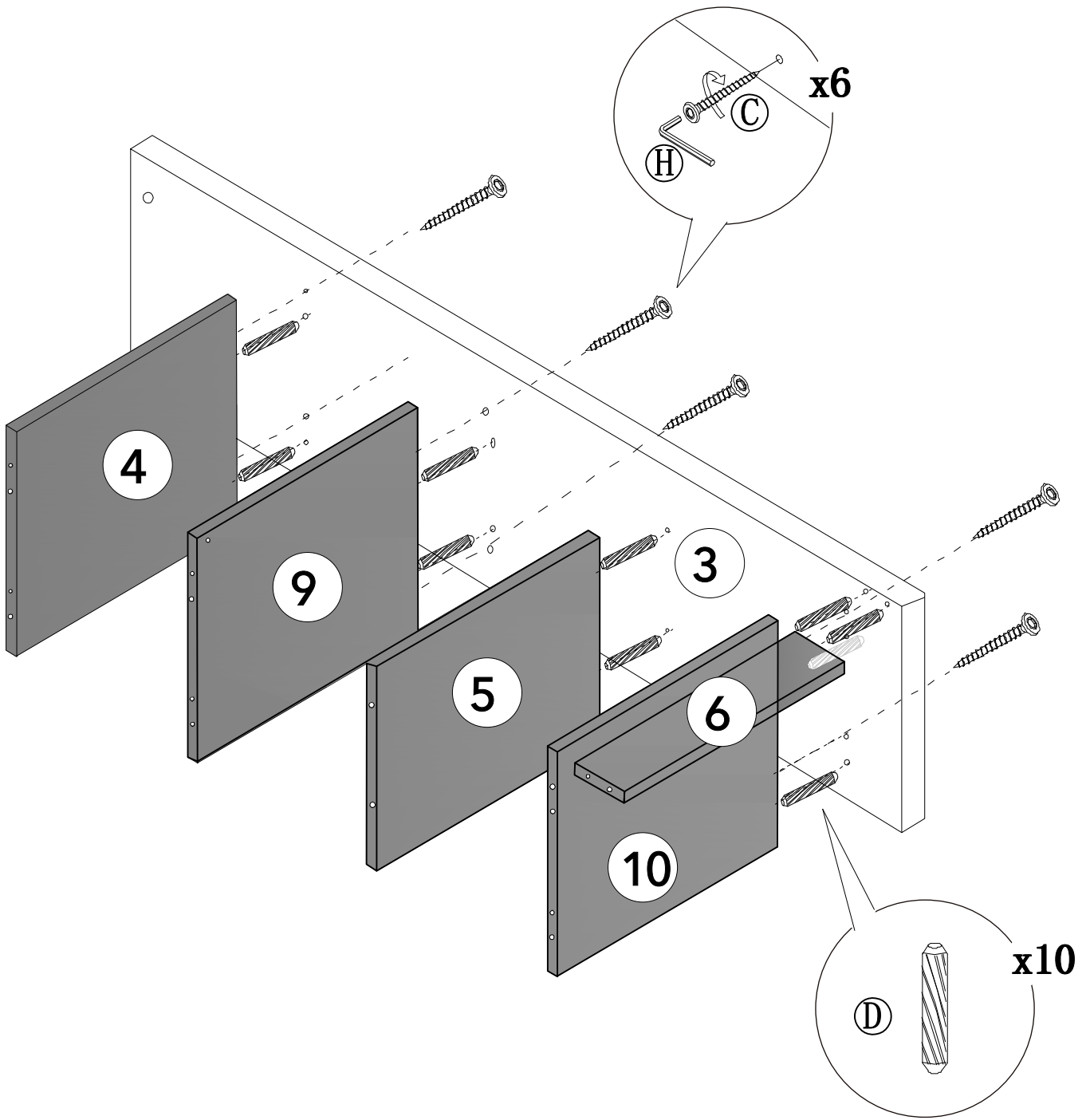

## PASO 2

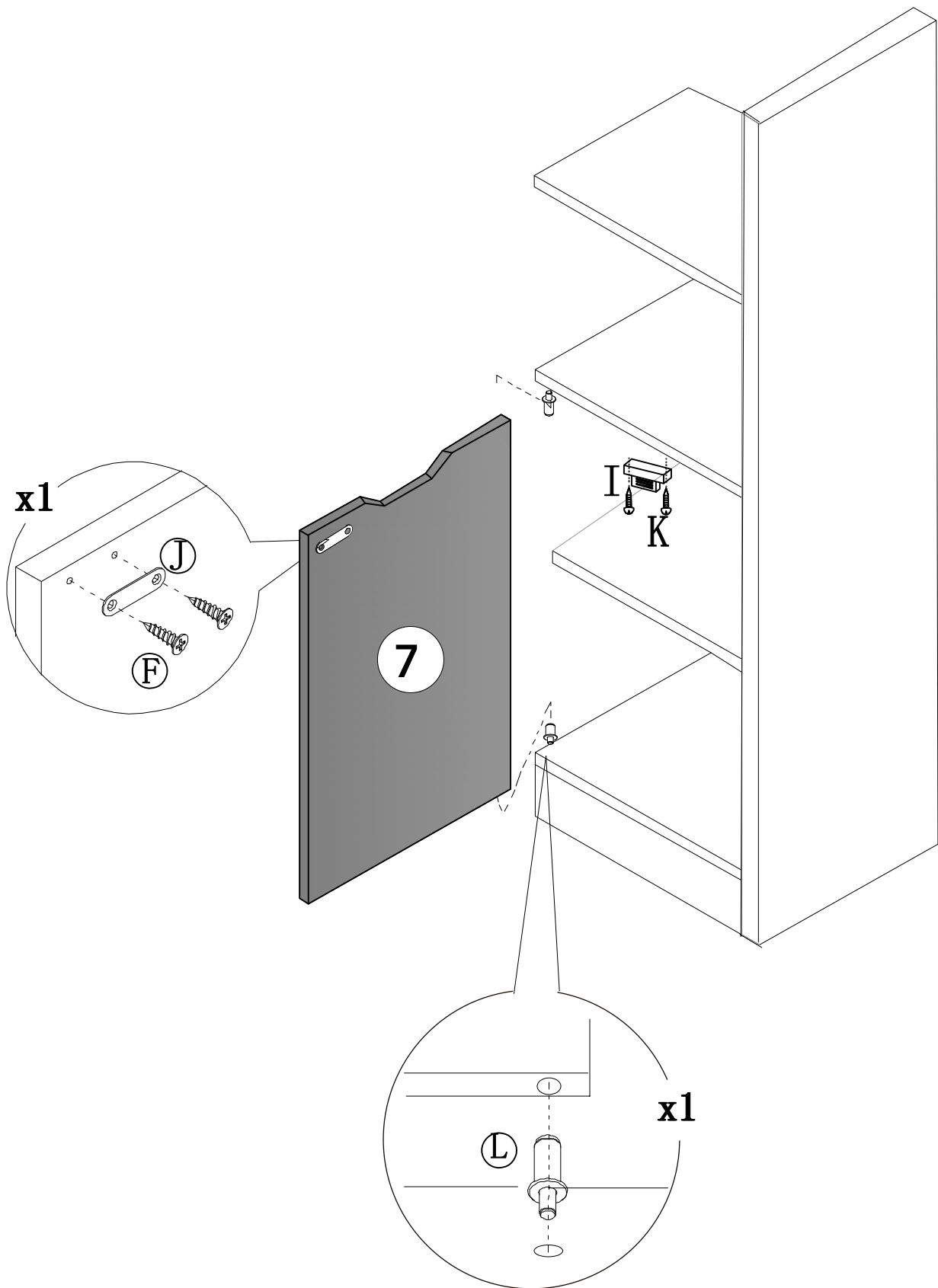

# PASO 3

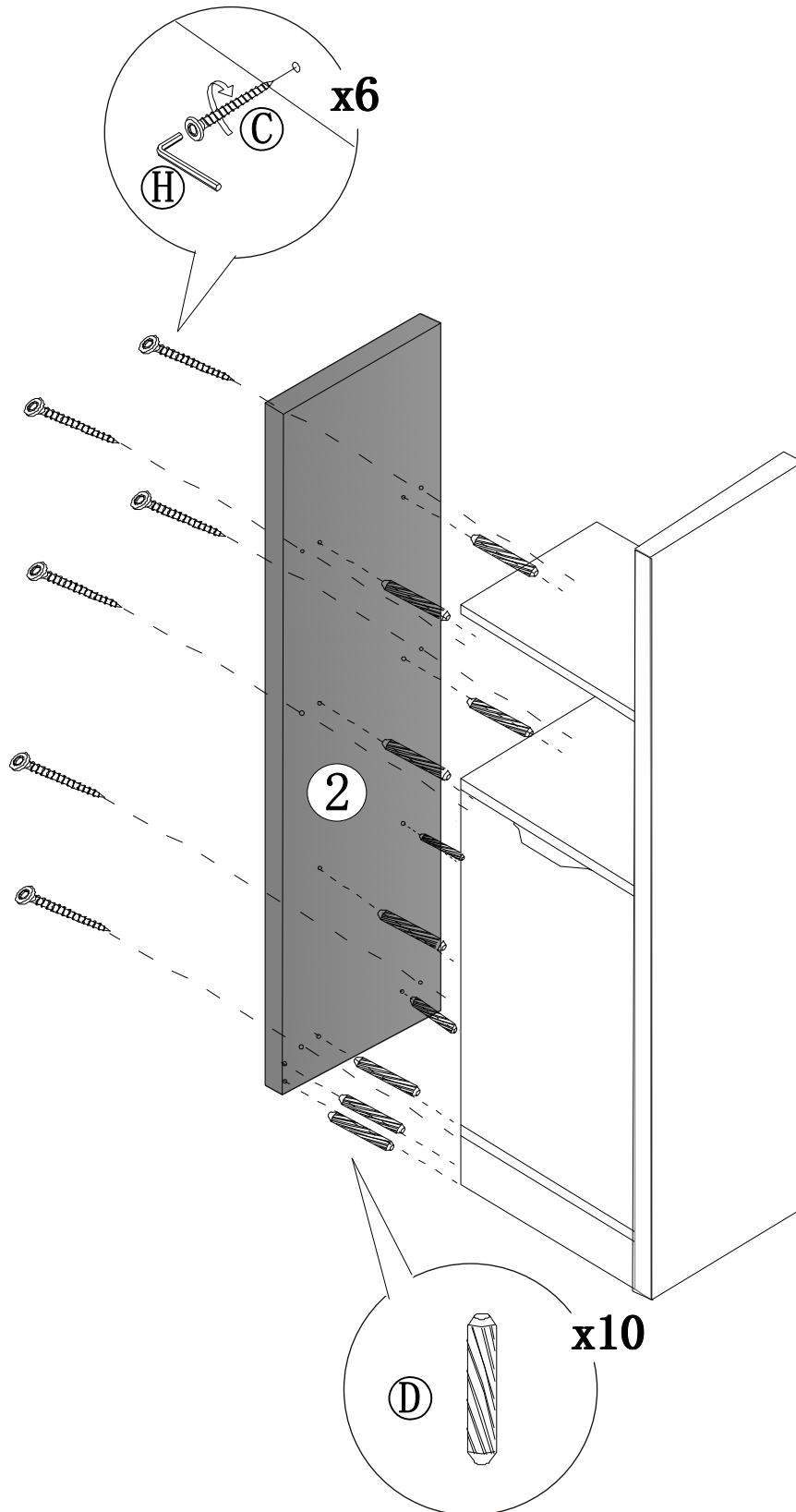

# PASO 4

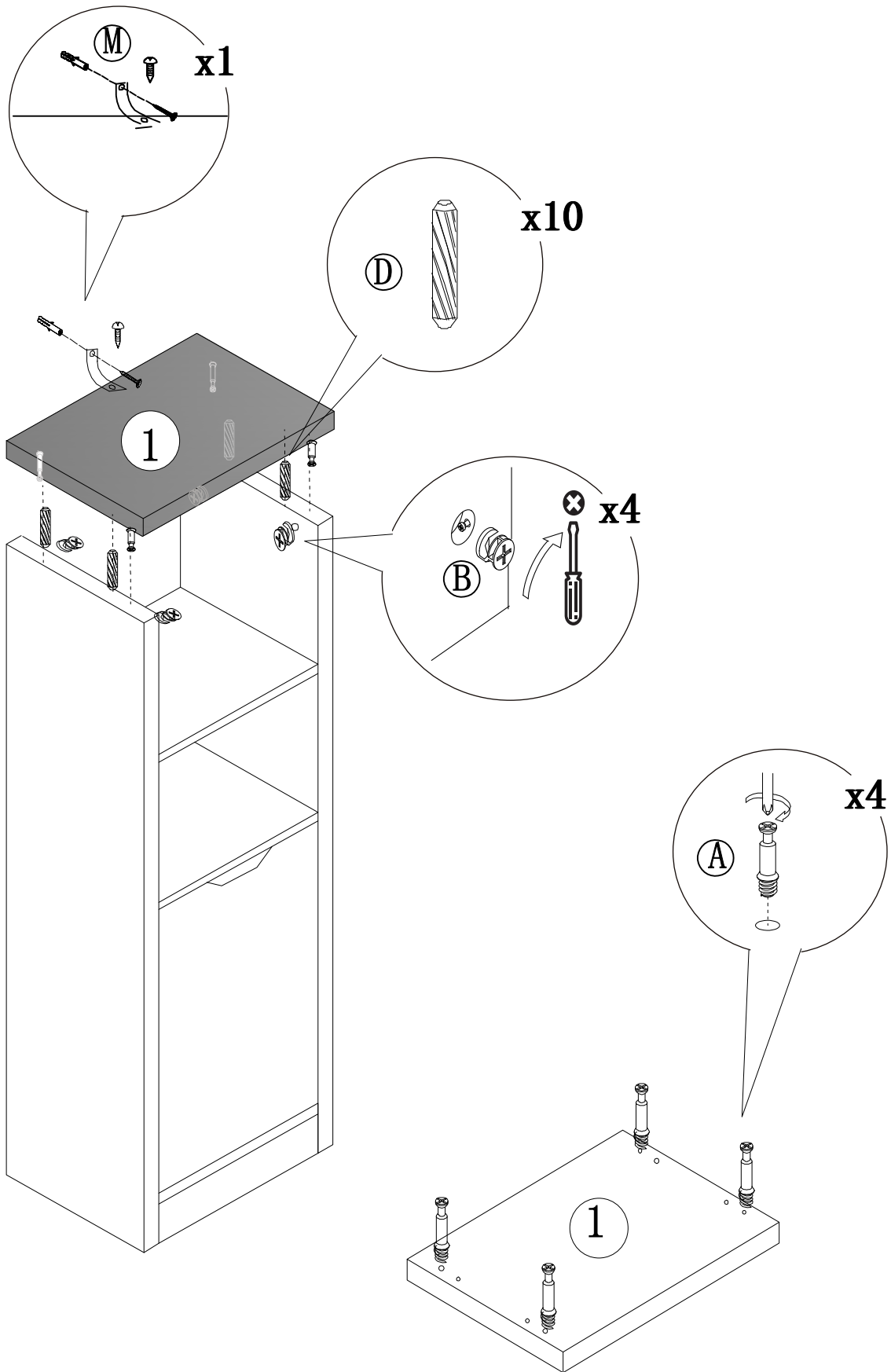

# PASO 5

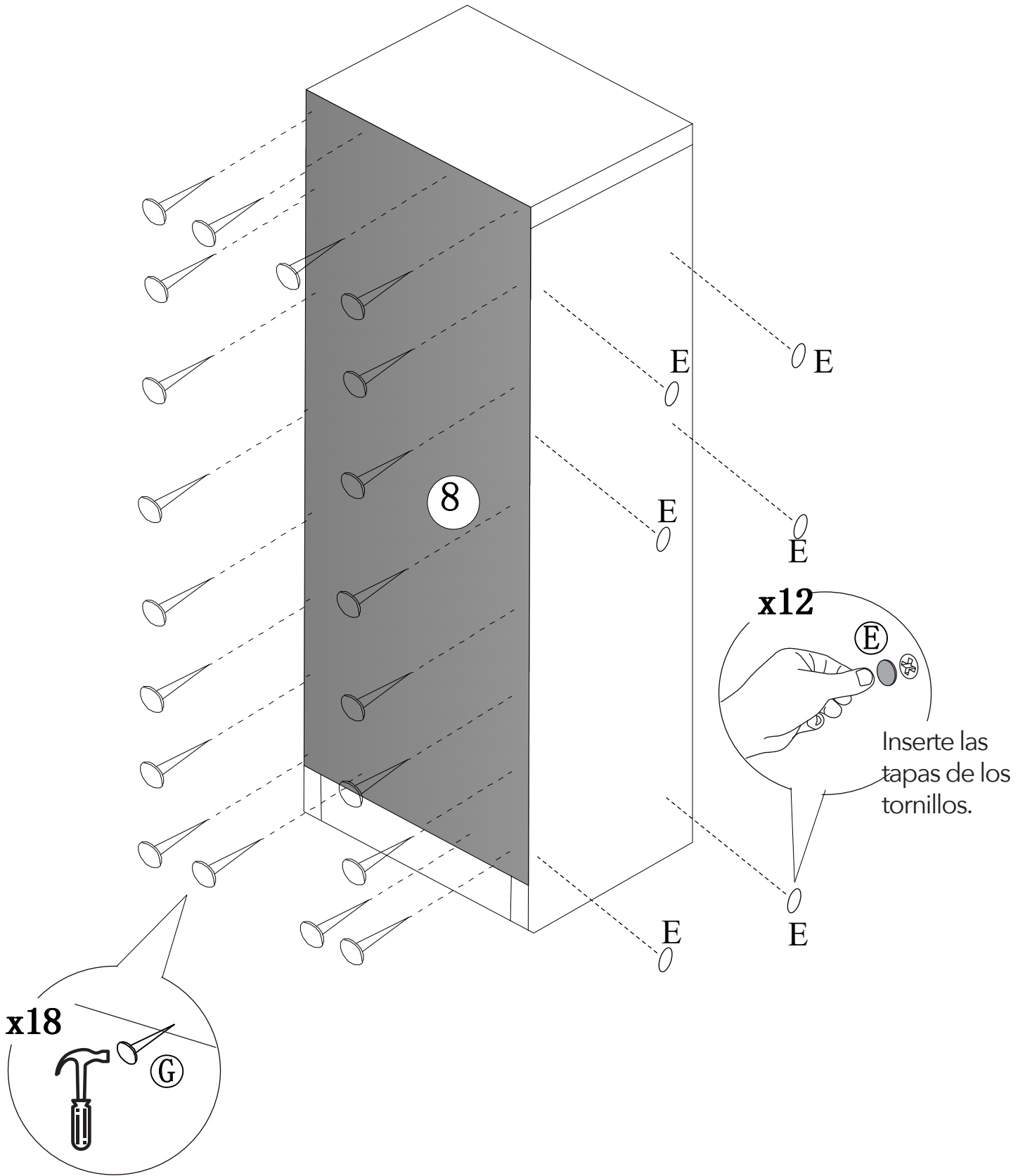

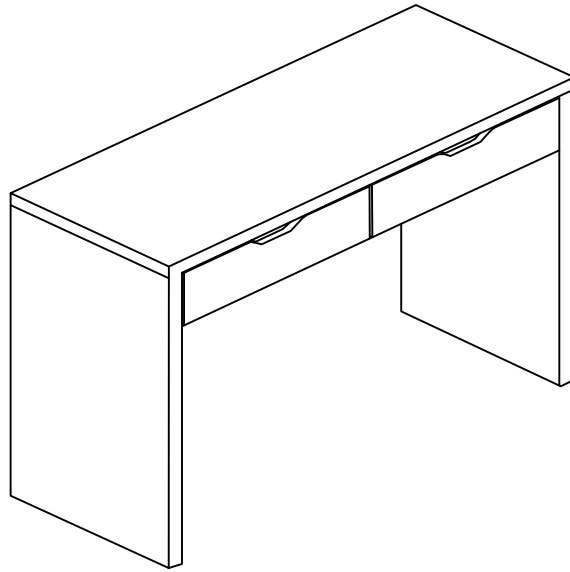

## QUINCALLERÍA

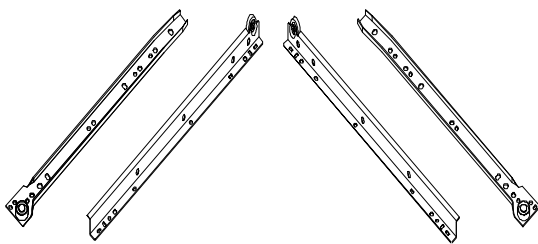
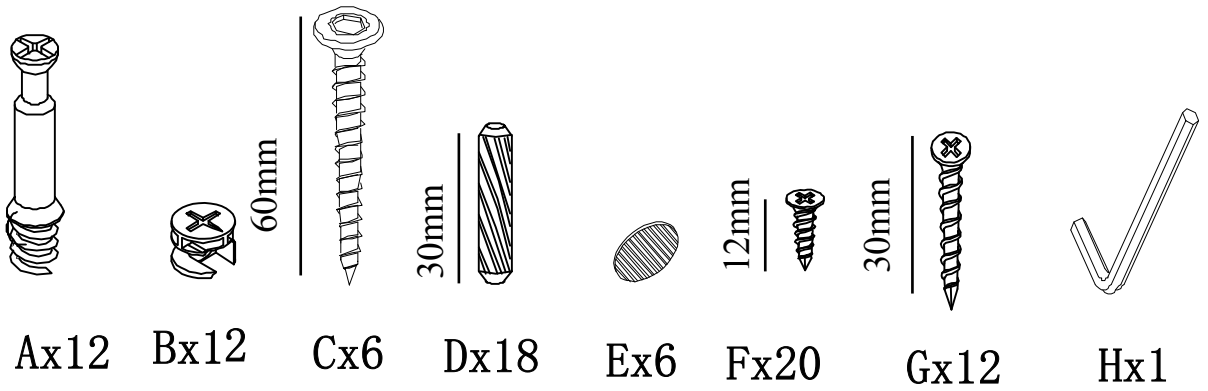

0x2sets

# PIEZAS

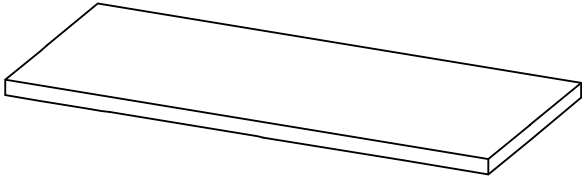

① x1

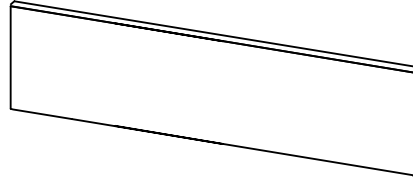

⑨ x1

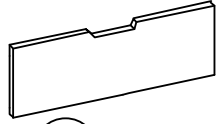

⑧ x1



④ x1

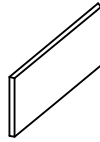

⑤ x1



⑩ x2

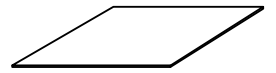

⑪ x2

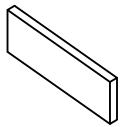

⑥ x2

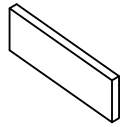

⑦ x2

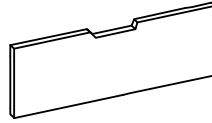

⑫ x1

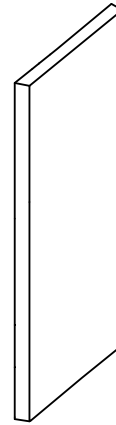

② x1

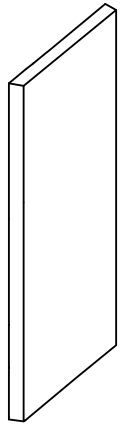

③ x1

# PASO 1

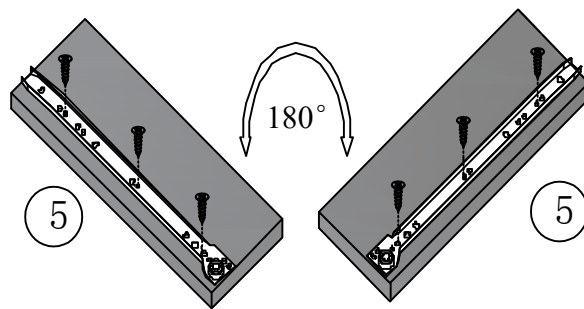
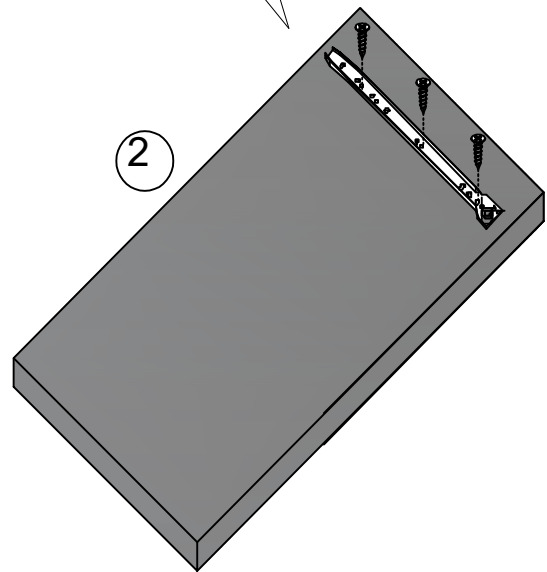
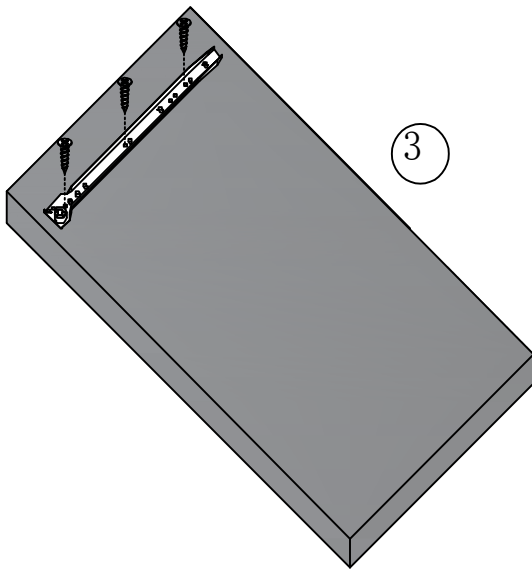
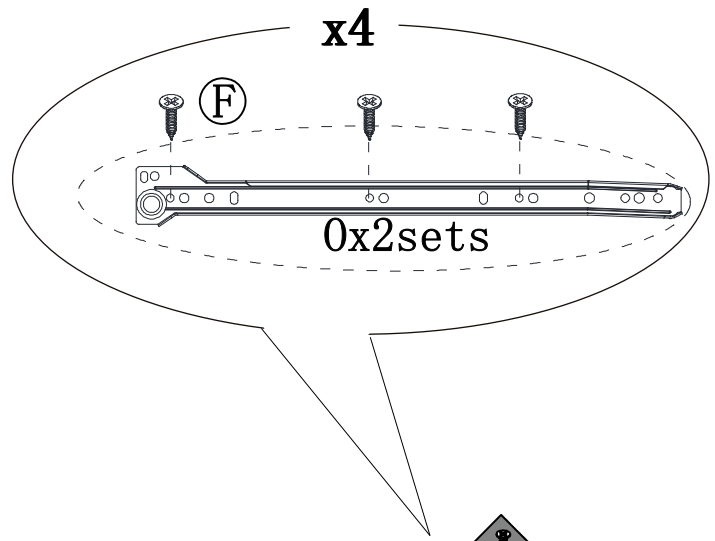

## PASO 2

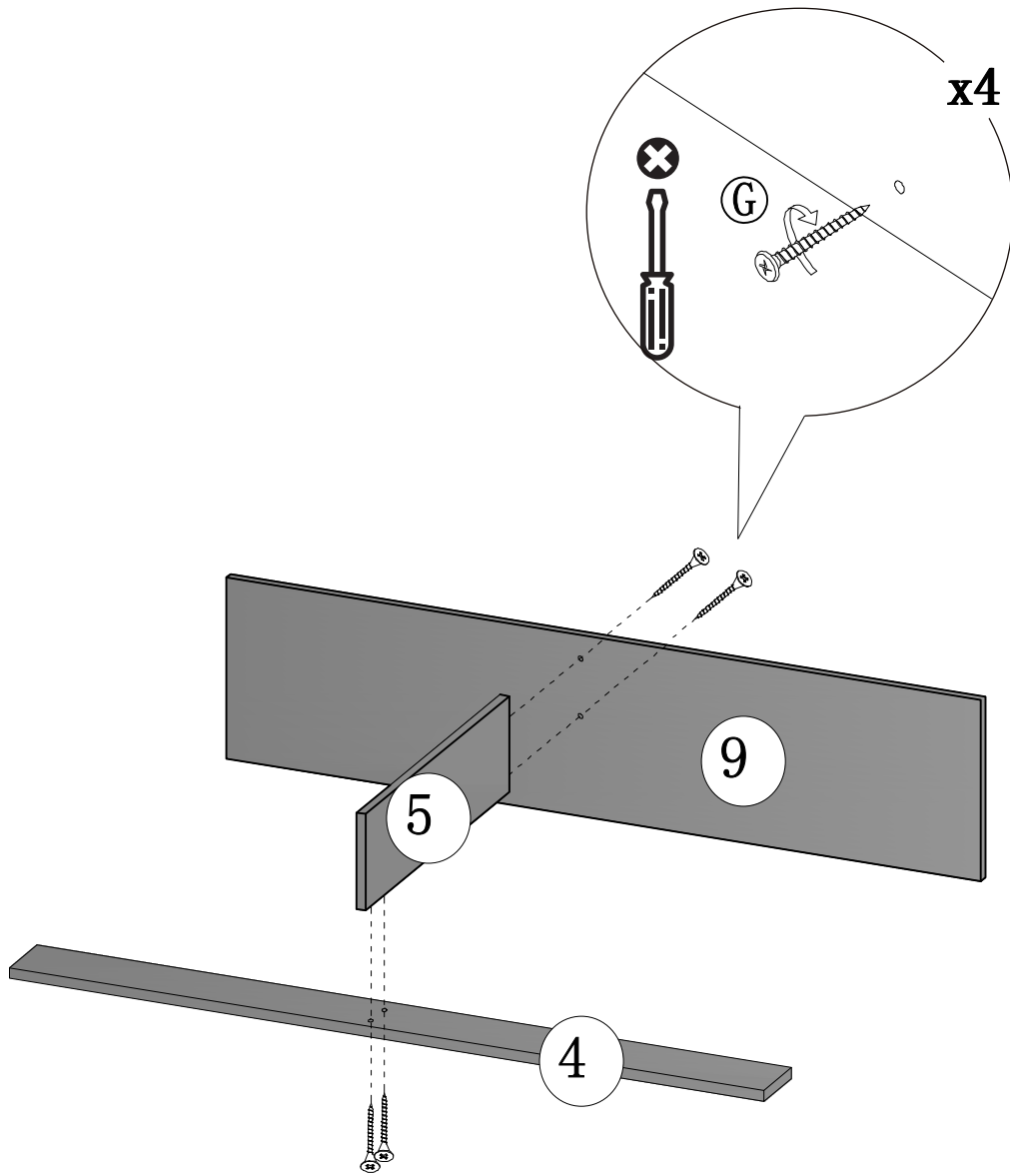

# PASO 3

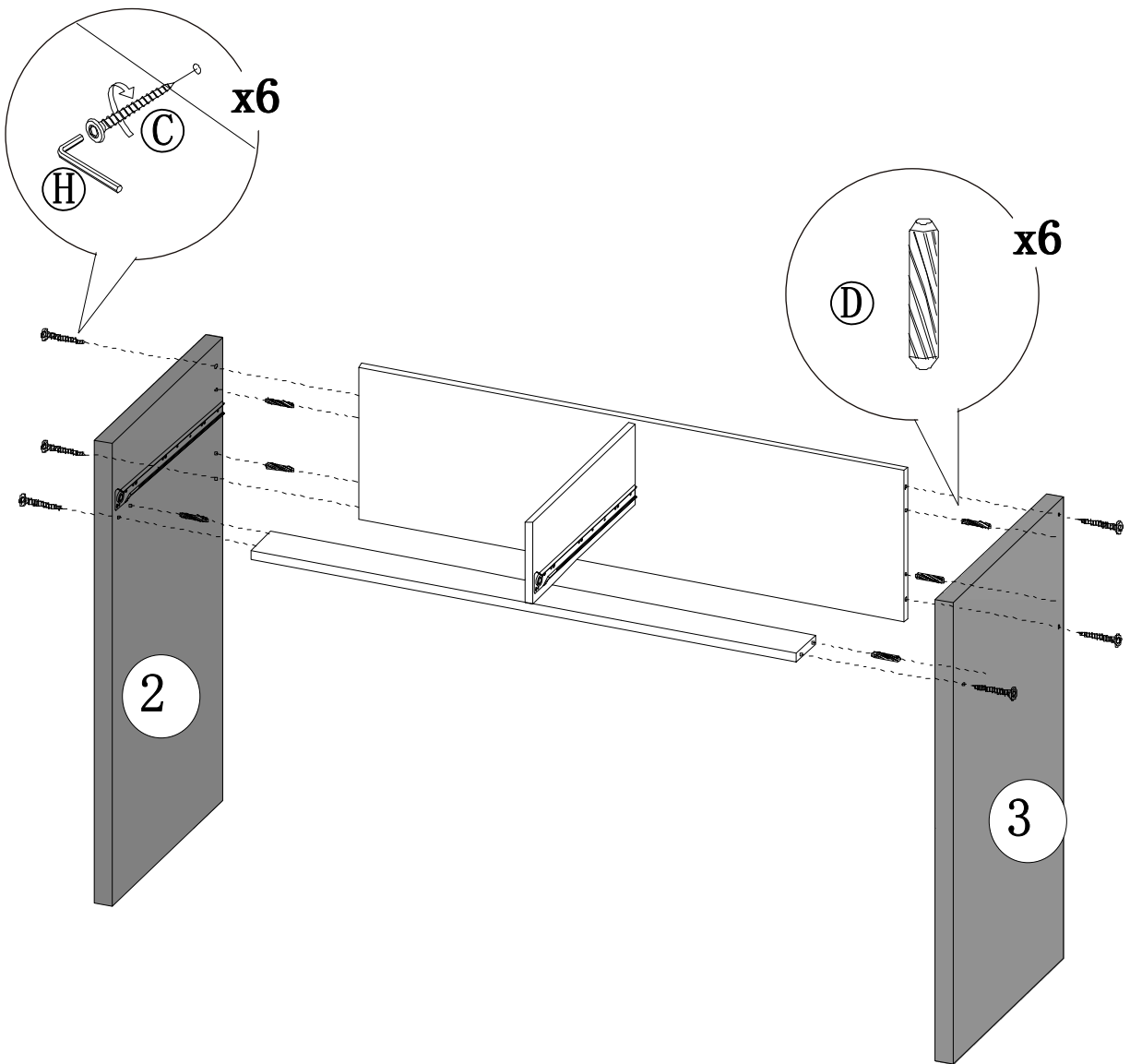

# PASO 4

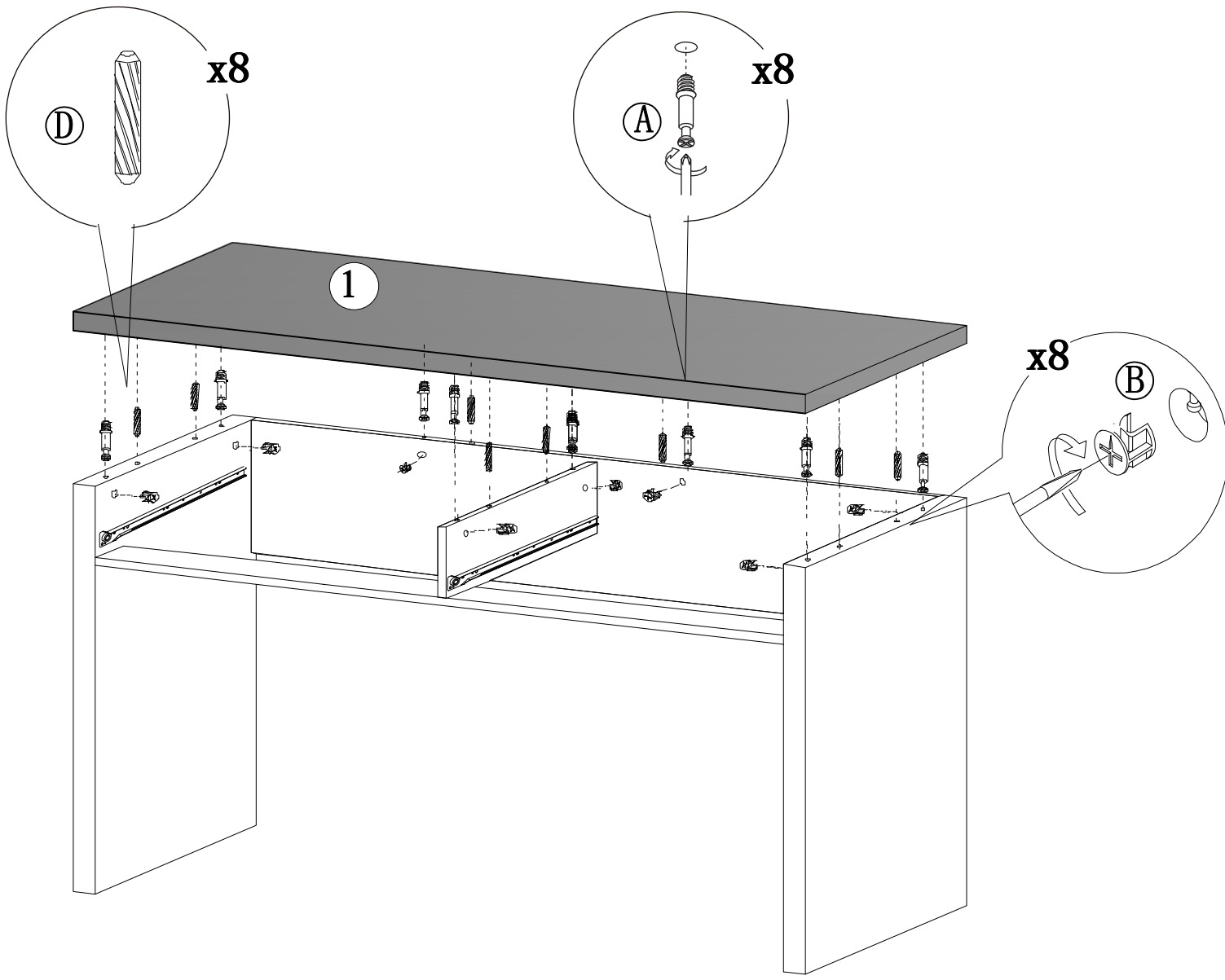

# PASO 5

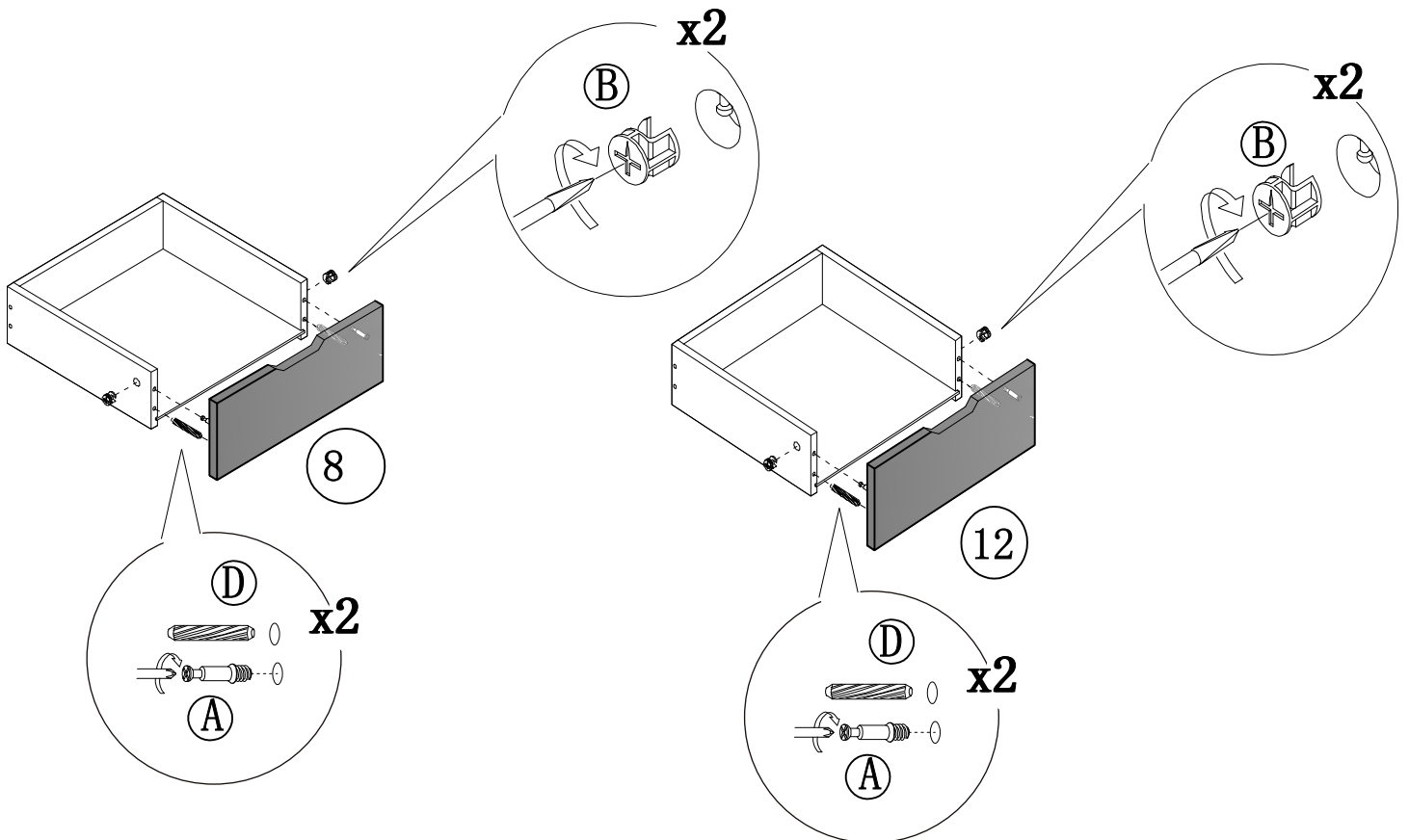
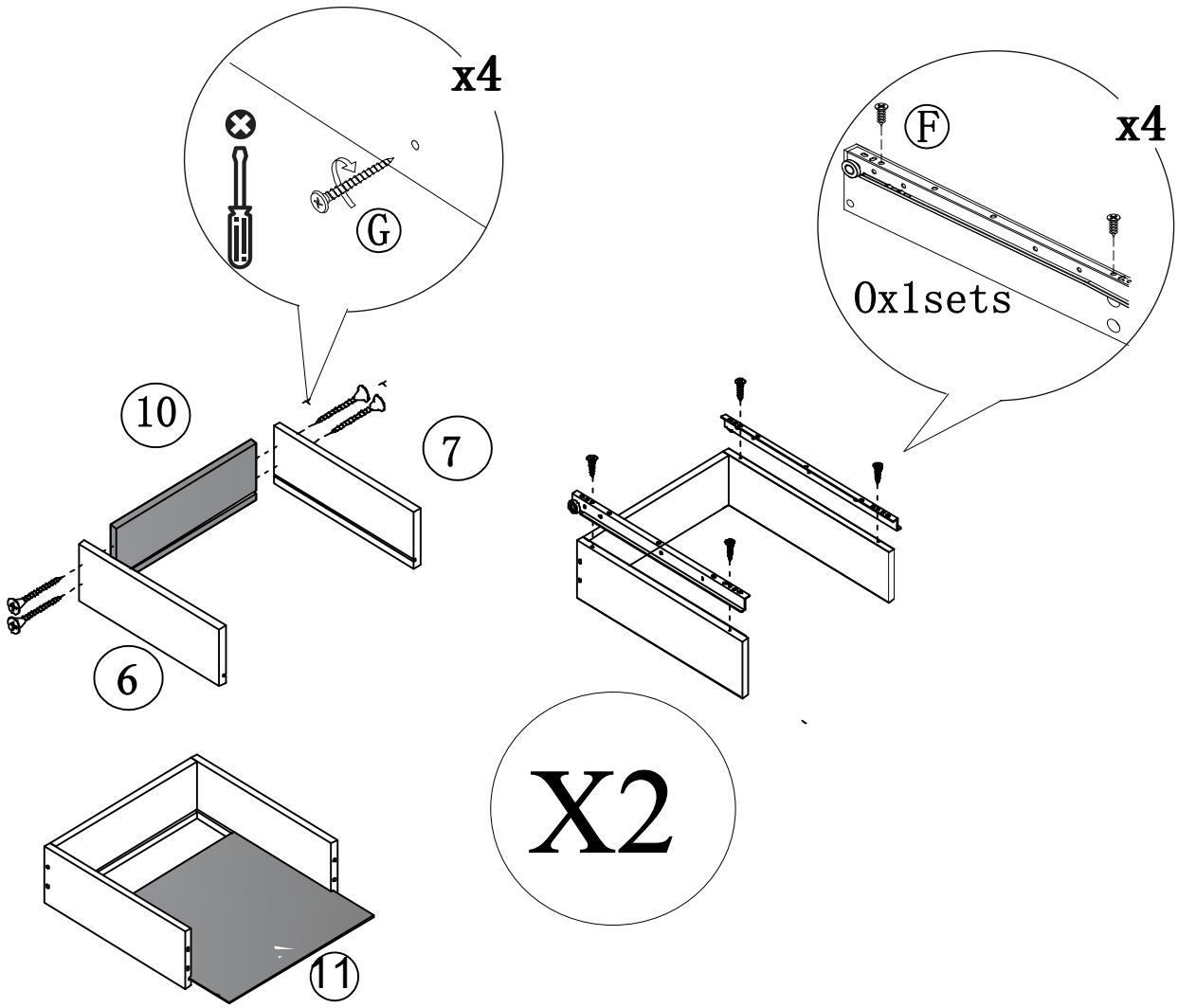

## PASO 6

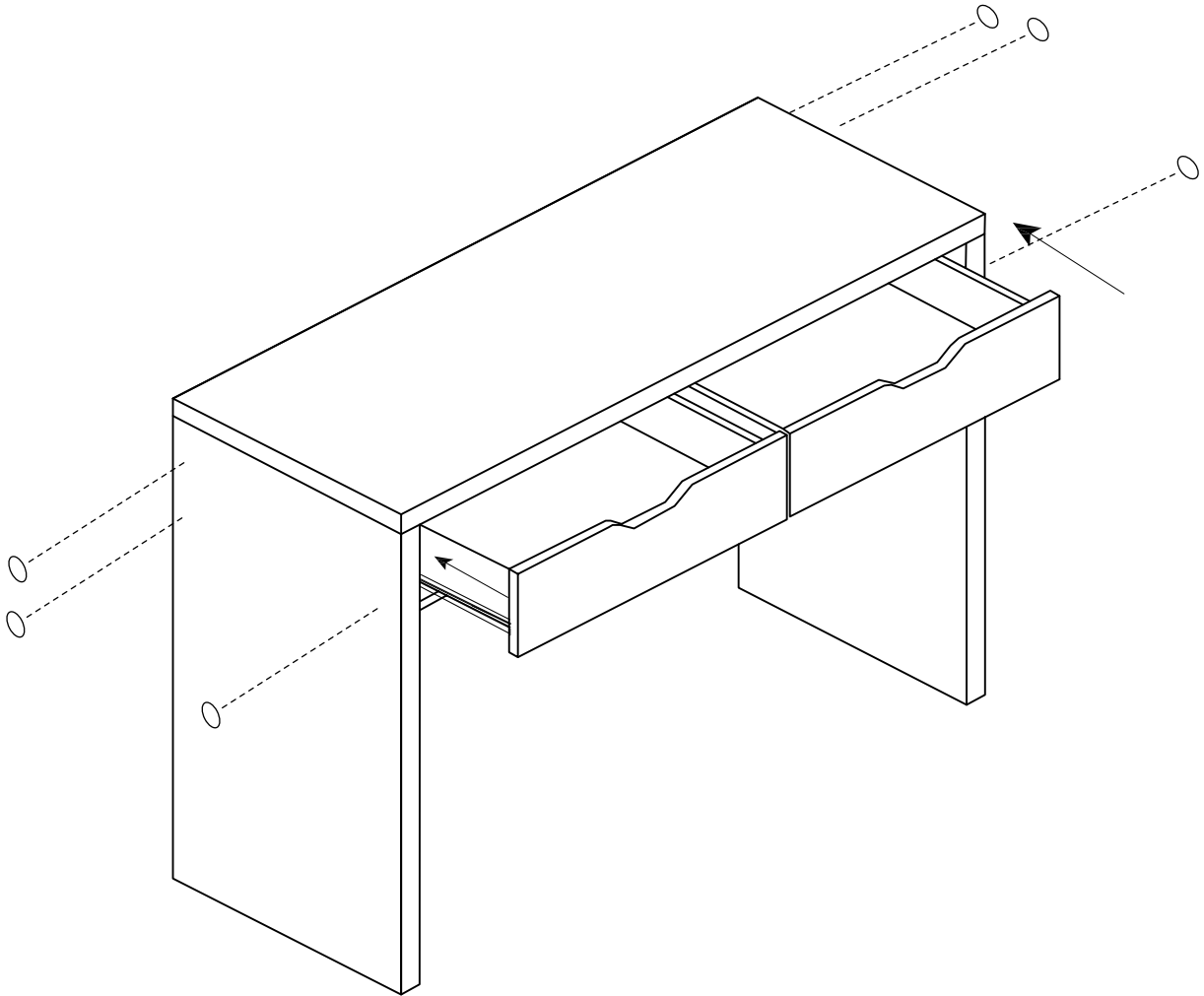
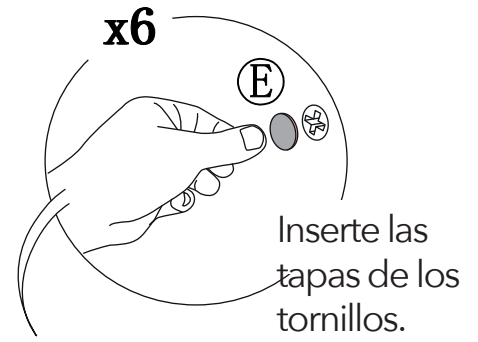



## **TODOS JUNTOS**

Entre todos sí es posible  
lograr un impacto real  
ahorrando papel.

