

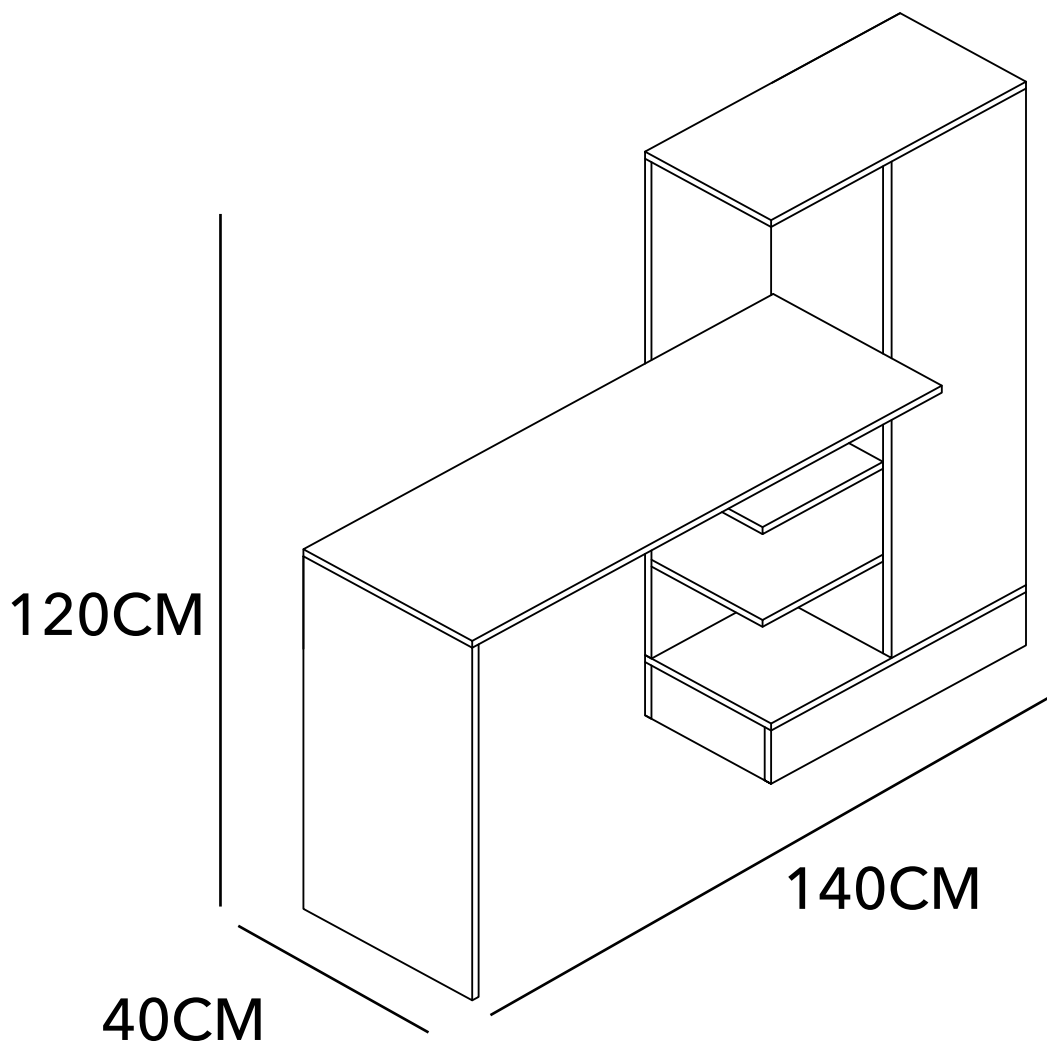

## **MANUAL DE INSTRUCCIONES**

**CTRO DE TRABAJO AMULIO BCO/MAD 140X40X120**

**MODELO: MB2701TT25-1**



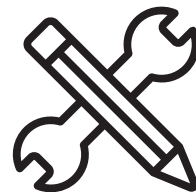

## ADVERTENCIA

Siga las instrucciones que se detallan en el manual, si presenta alguna diferencia en el contenido de sus piezas pongase en contacto con la tienda donde fue adquirido.

## RECOMENDACIONES

- Estudie atentamente las instrucciones antes del montaje.
- Ordene las piezas que componen el mueble.
- Agrupe y ordene la quincallería.
- Prepare una zona despejada para el montaje.
- Monte las piezas sin forzar los ensambles, una vez armada toda la estructura, reaprete de forma definitiva.
- Volver a apretar los tornillos después de un tiempo de uso.
- Conserve estas instrucciones de montaje.



Herramientas requeridas  
(no incluidas)



2 persona para  
el armado



Producto contenido  
en 1 cajas

# QUINCALLERÍA

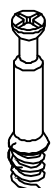

Ax31



Bx31

30mm



Cx40

40mm

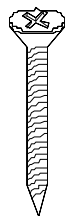

Dx20

14mm



Ex12

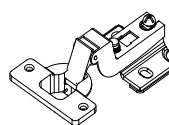

Fx3



Gx10

15mm

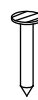

Hx20

40mm

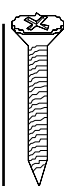

Ix1



14mm



Jx15

# PIEZAS

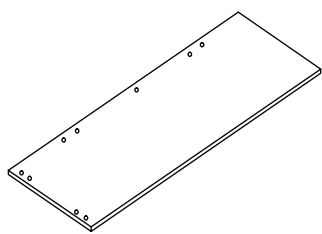

① x1

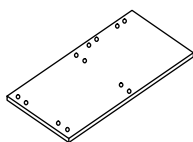

② x1

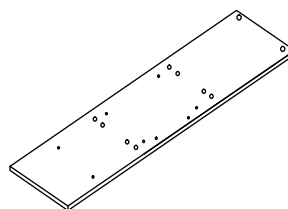

③ x1

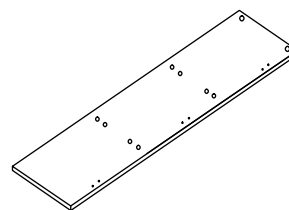

④ x1

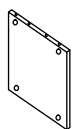

⑤ x2

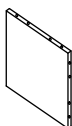

⑥ x2

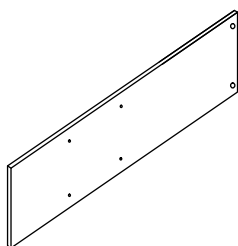

⑦ x1

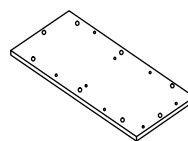

⑧ x1

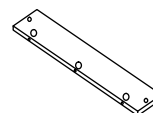

⑨ x2



⑩ x2

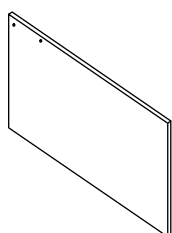

⑪ x1

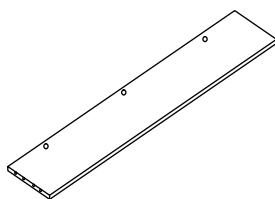

⑫ x1

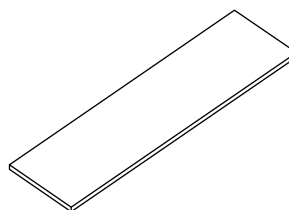

⑬ x1

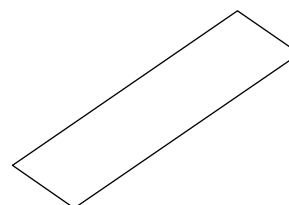

⑭ x1

# PASO 1

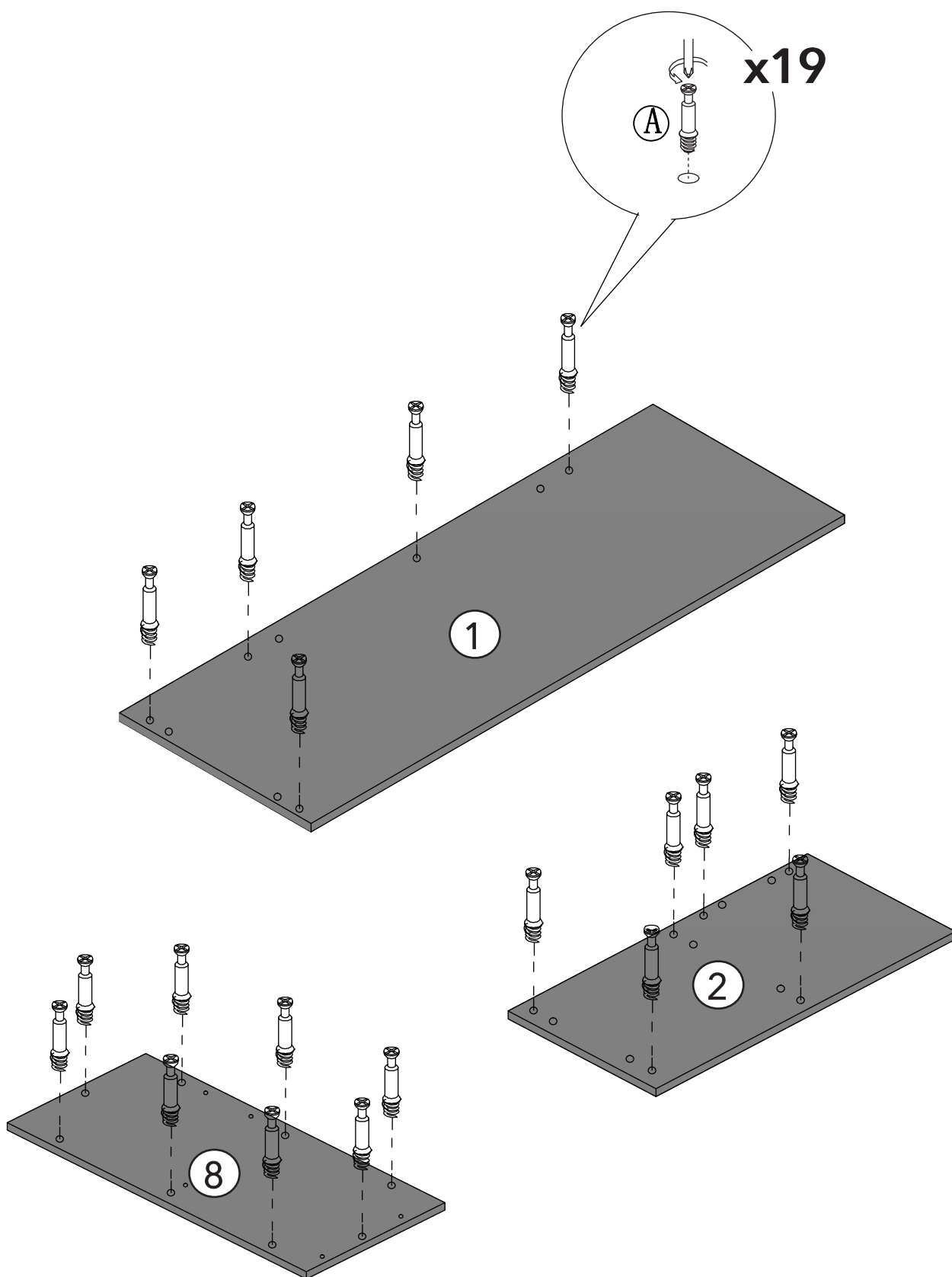

## PASO 2

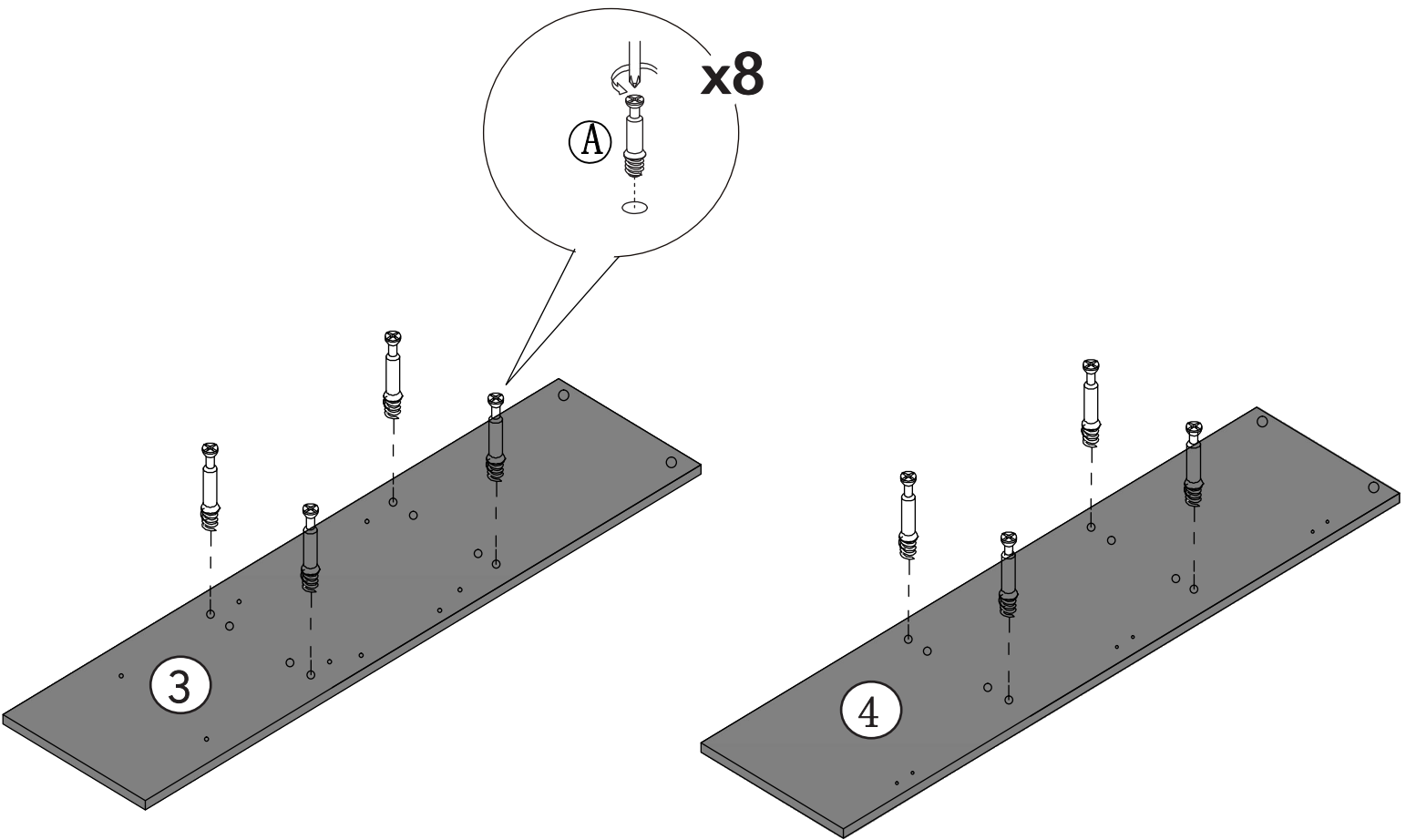

## PASO 3

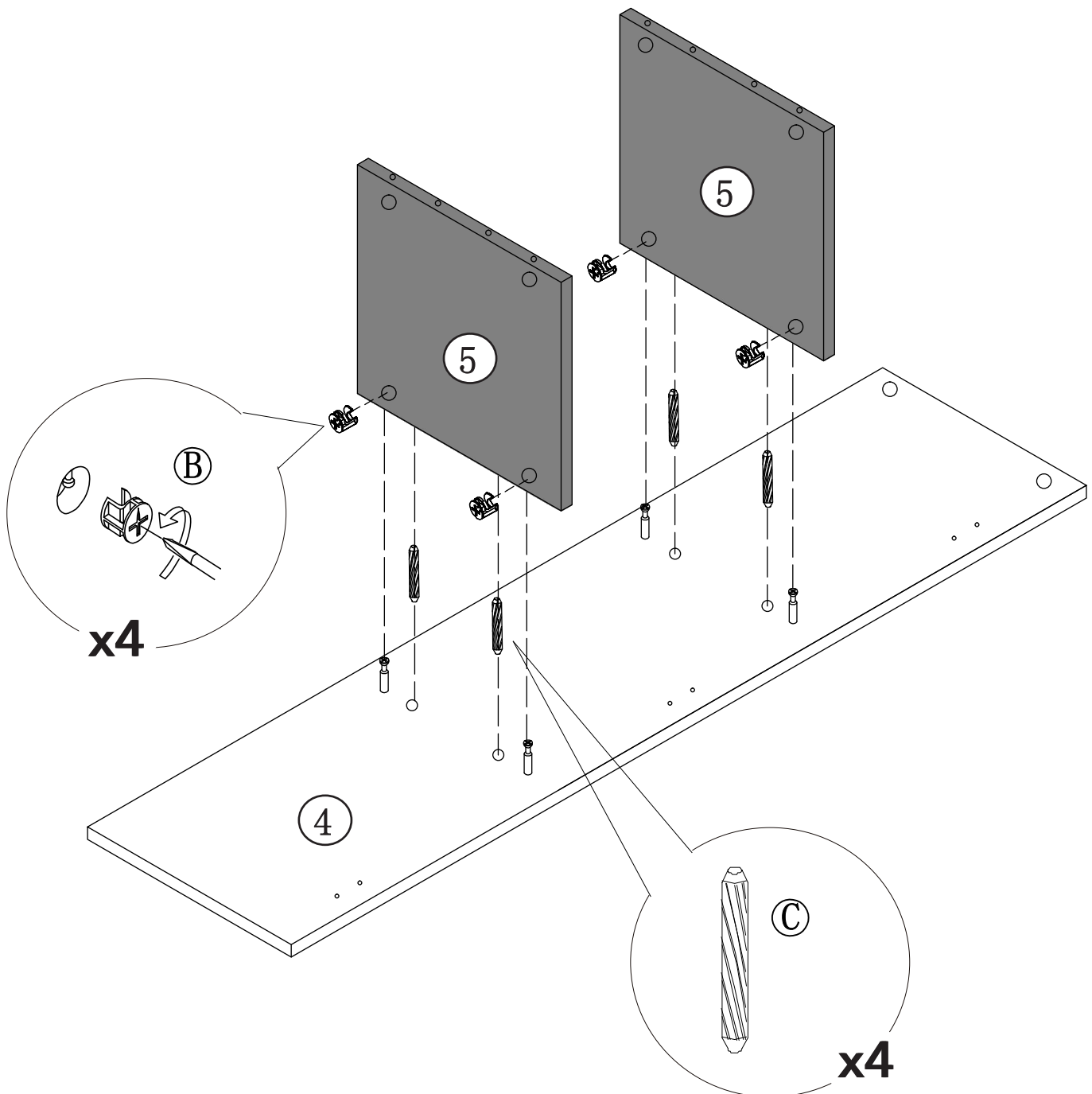

## PASO 4

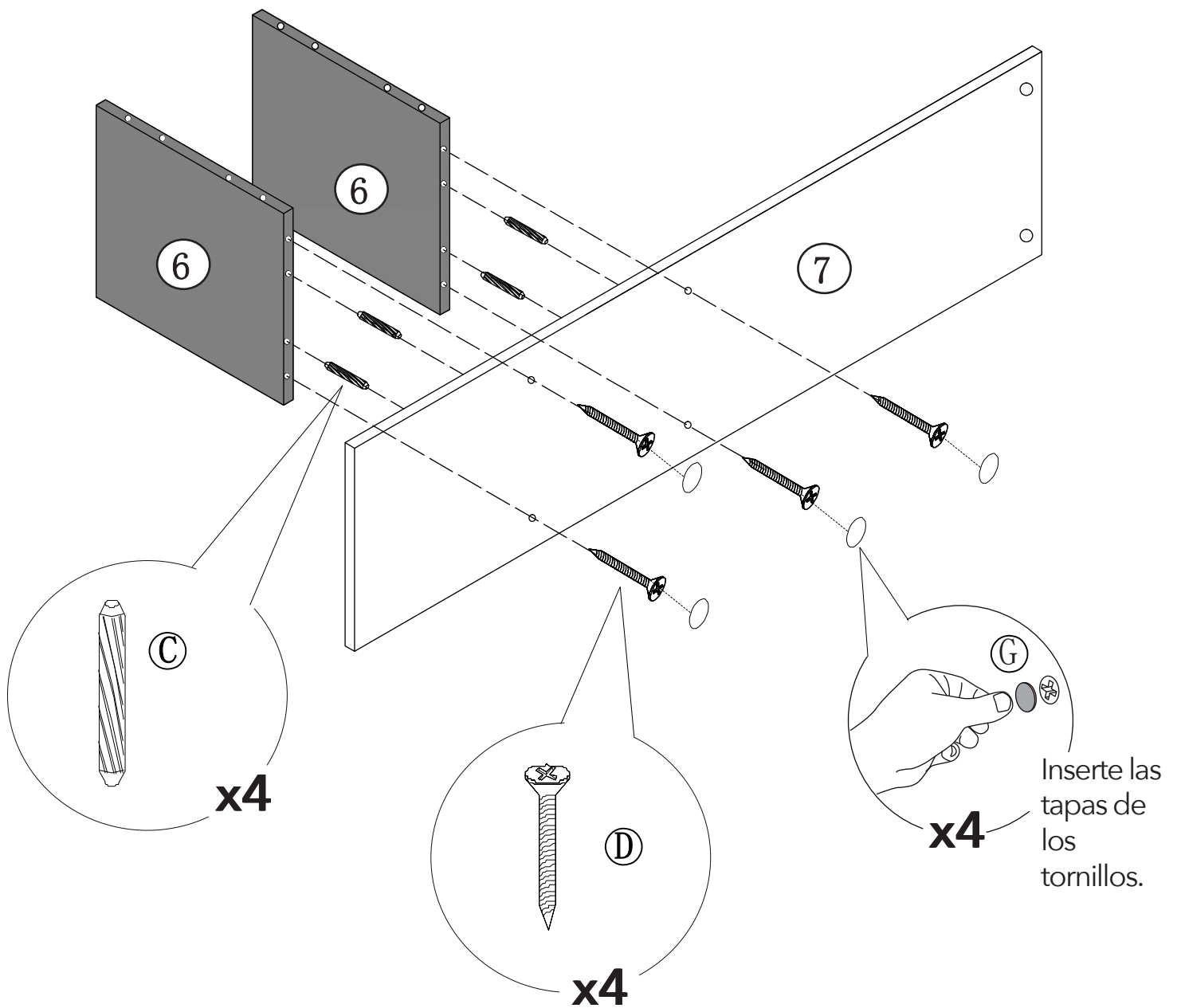



## PASO 5

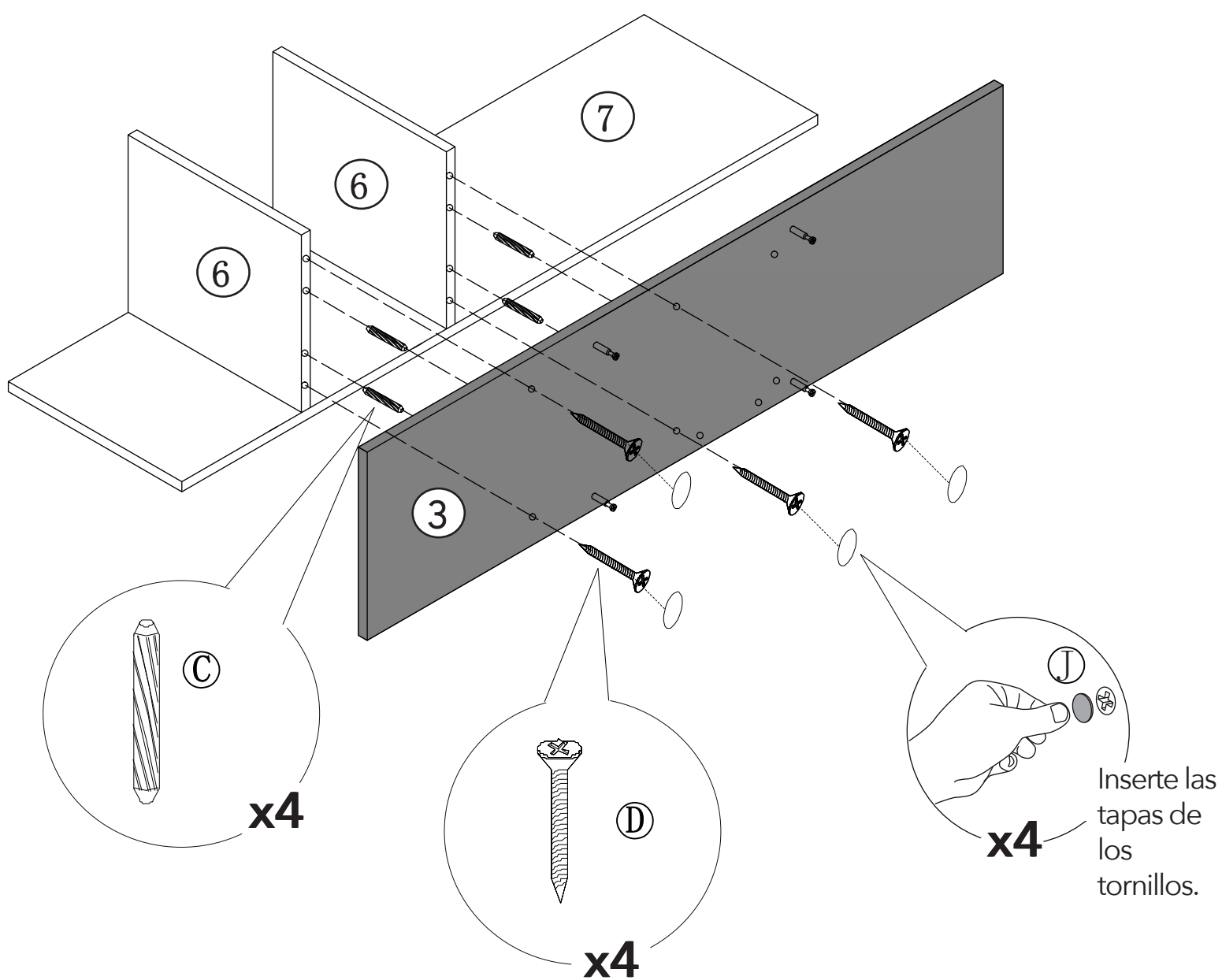

PASO 6

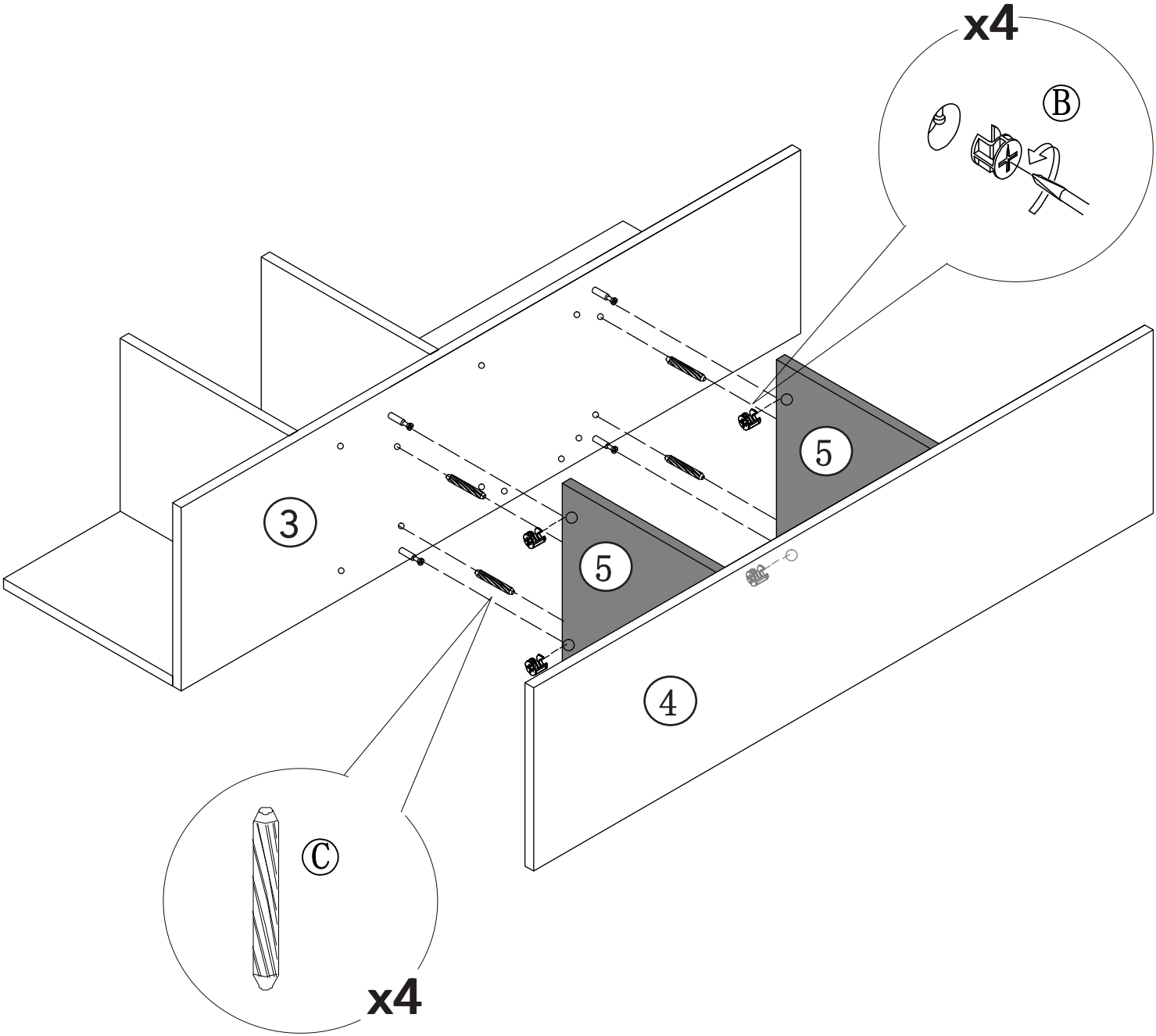

## PASO 7

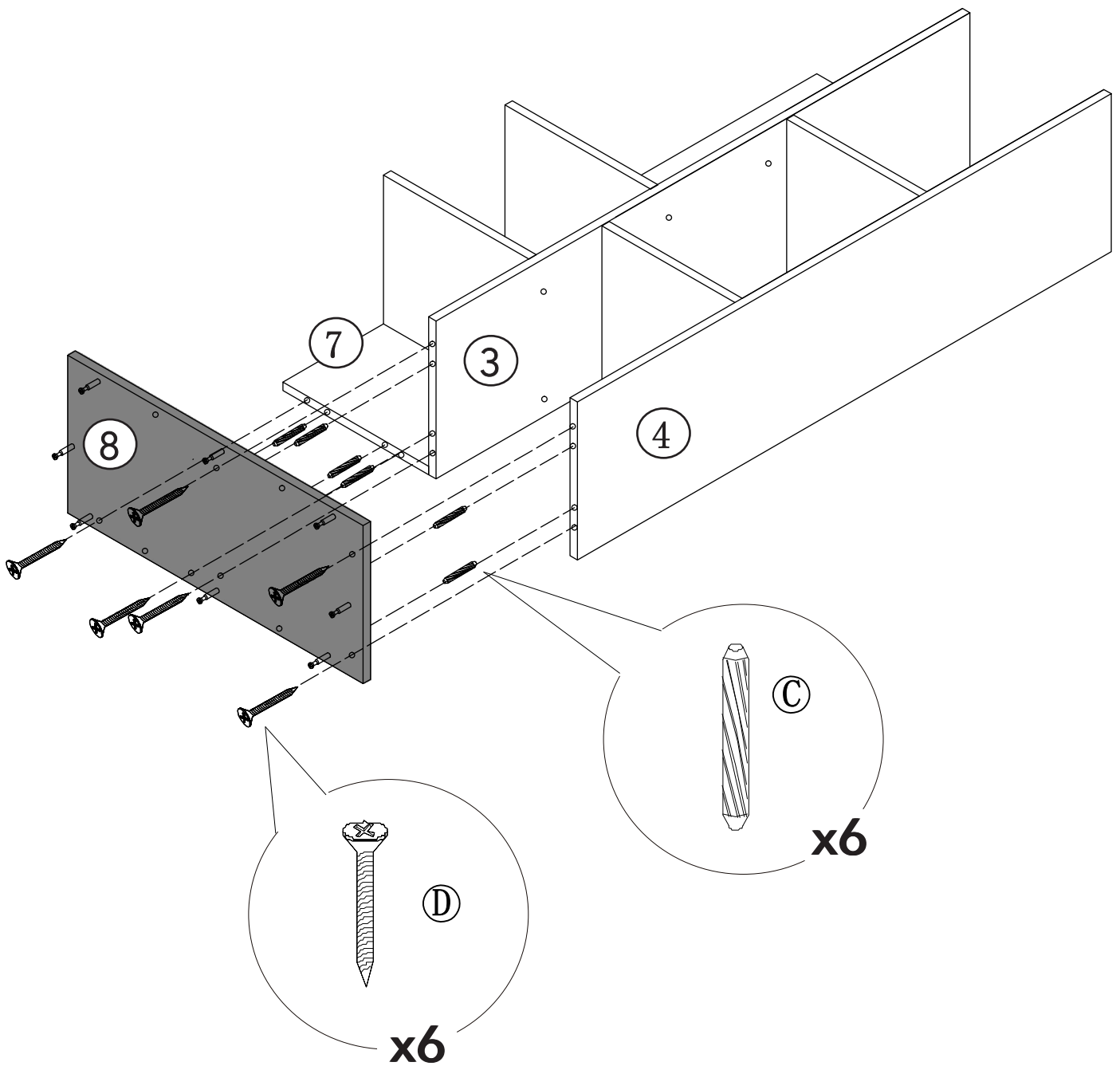

## PASO 8

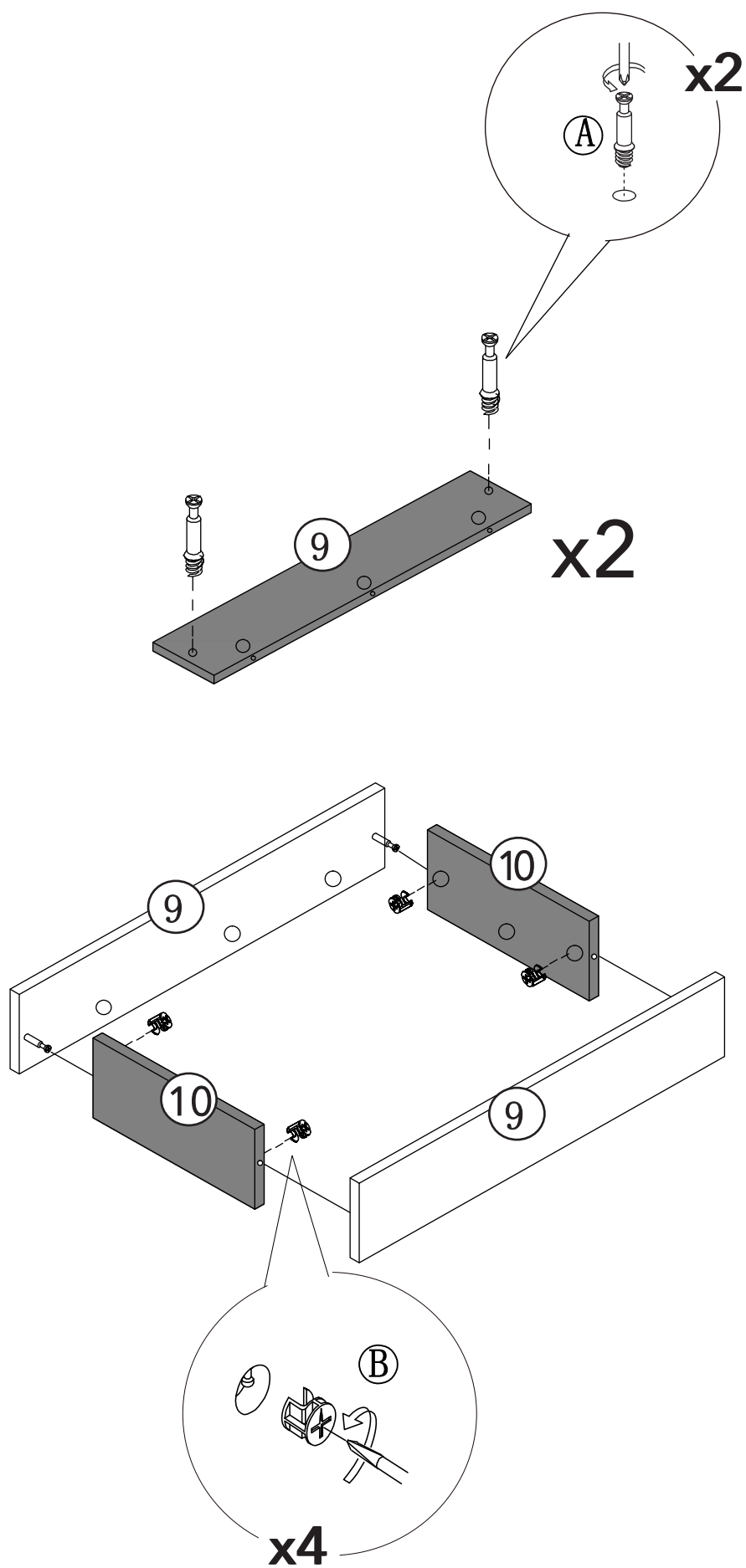

## PASO 9

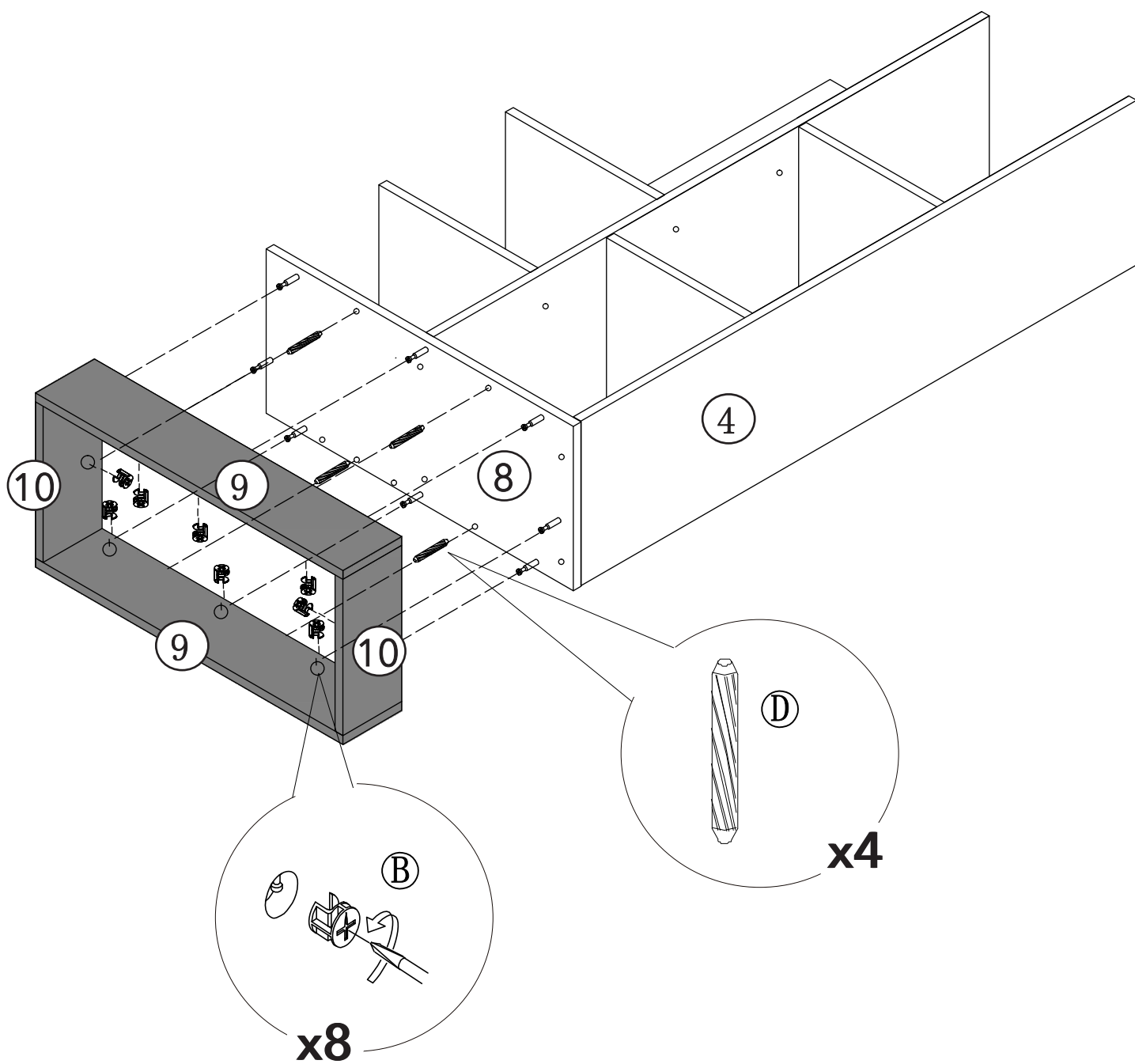

## PASO 10

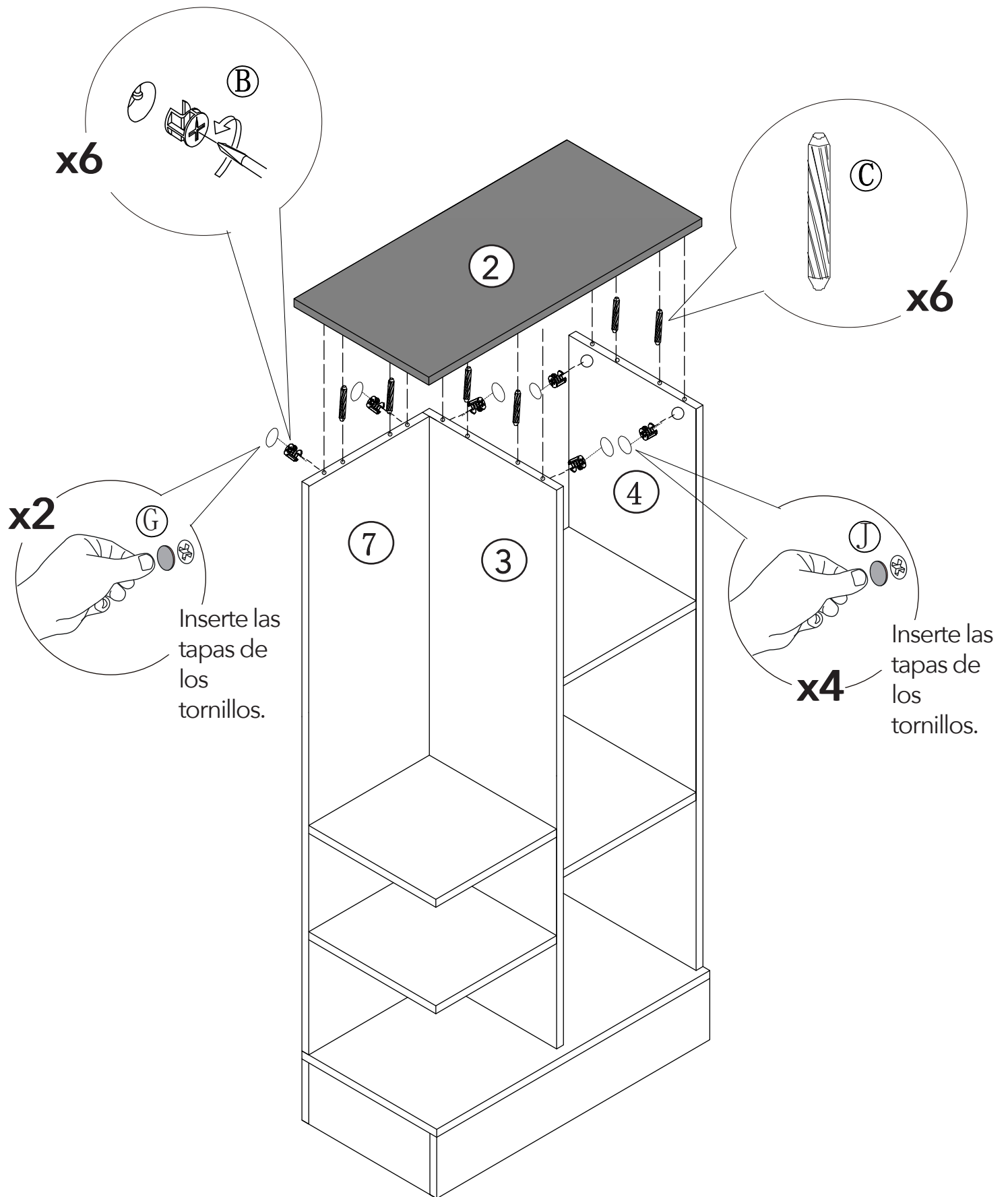

## PASO 11

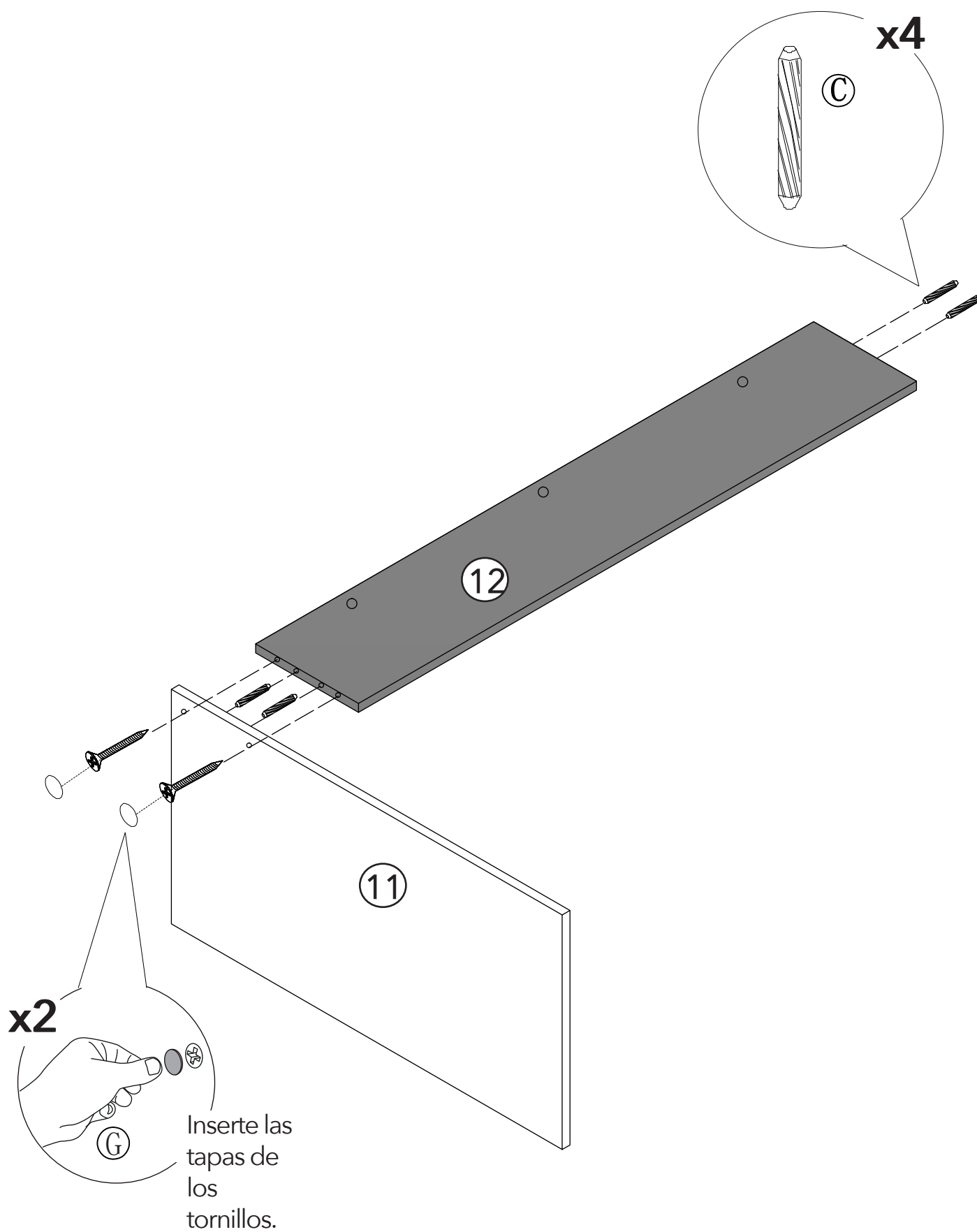

## PASO 12

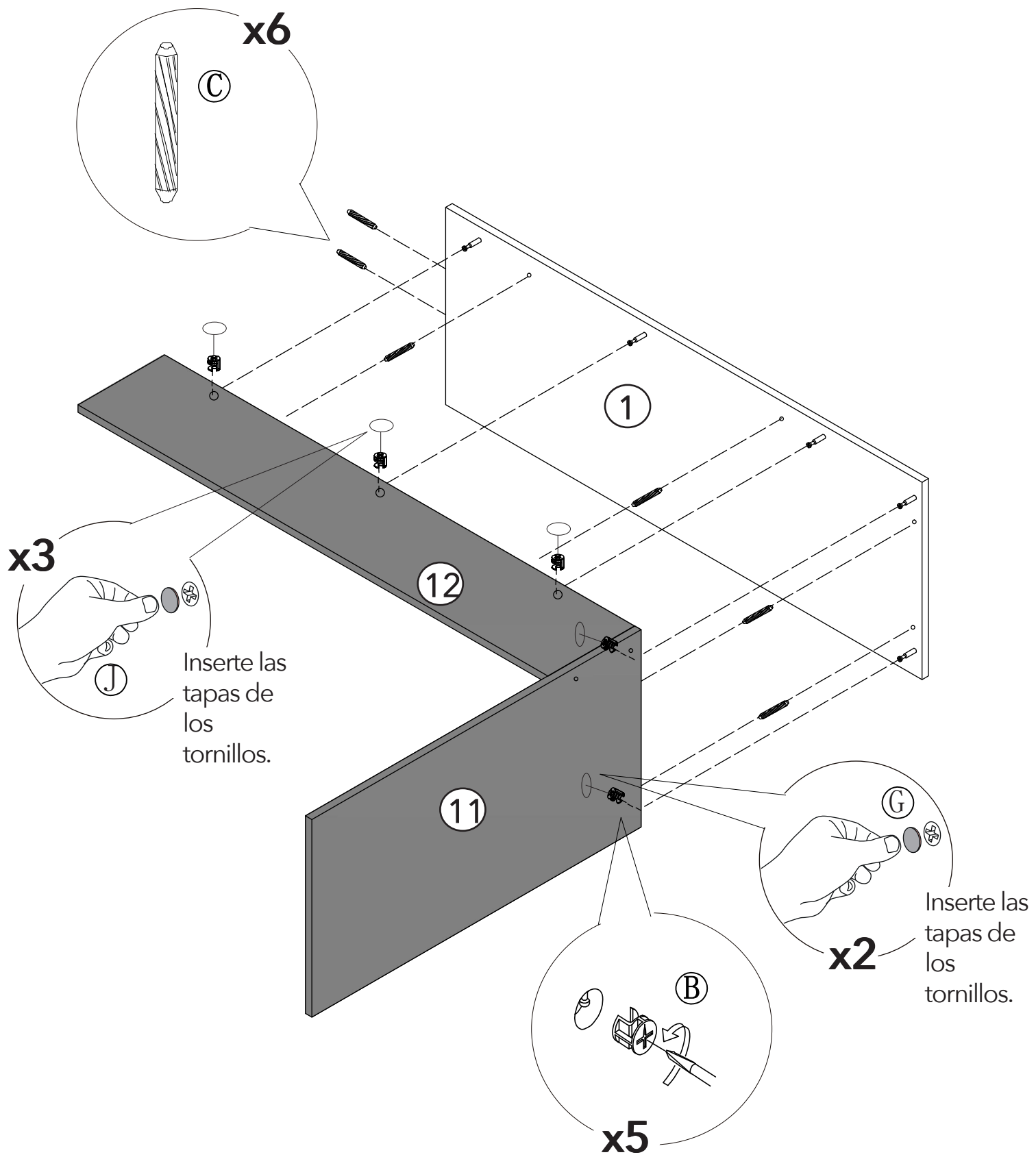



## PASO 13

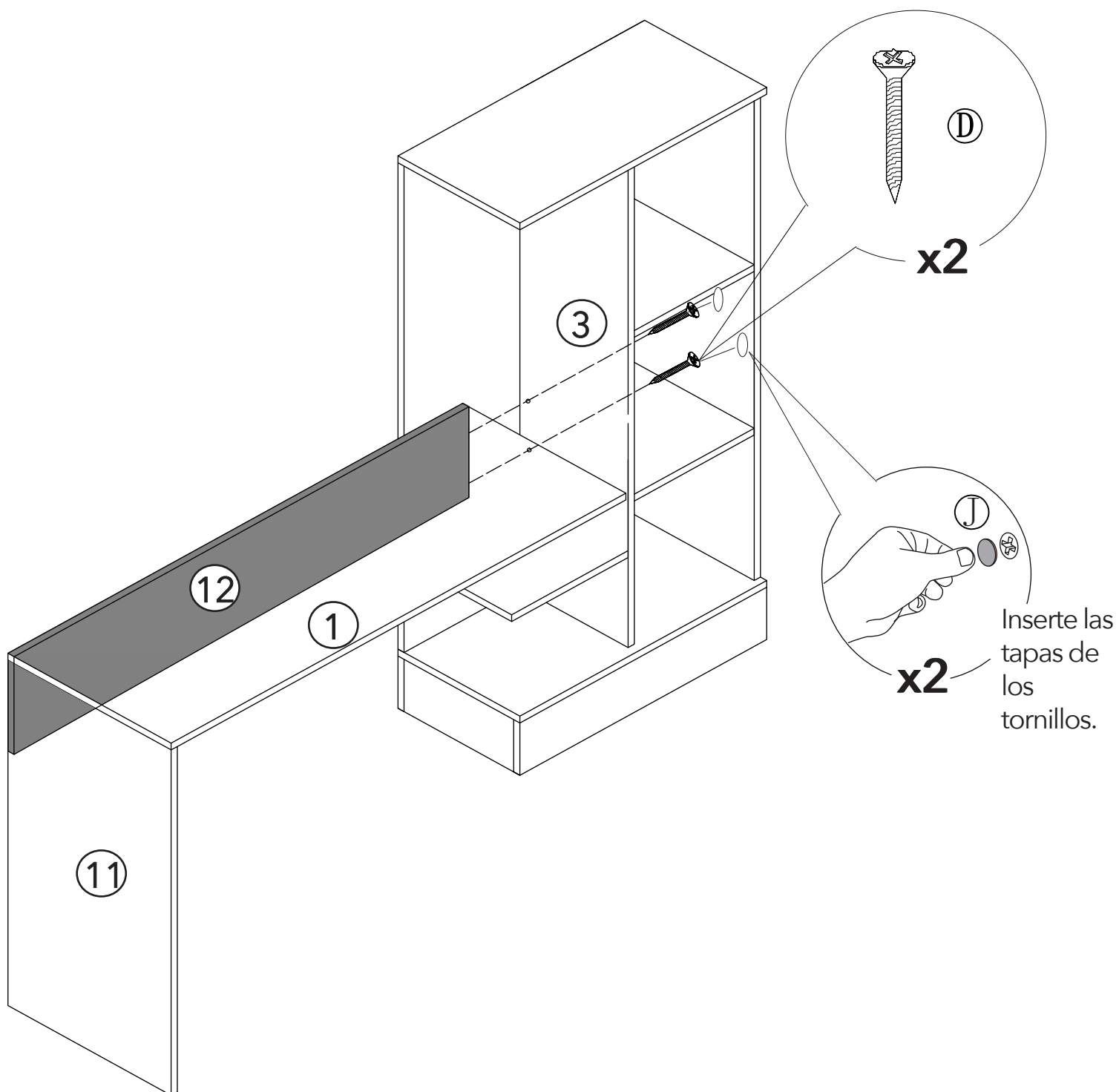

## PASO 14

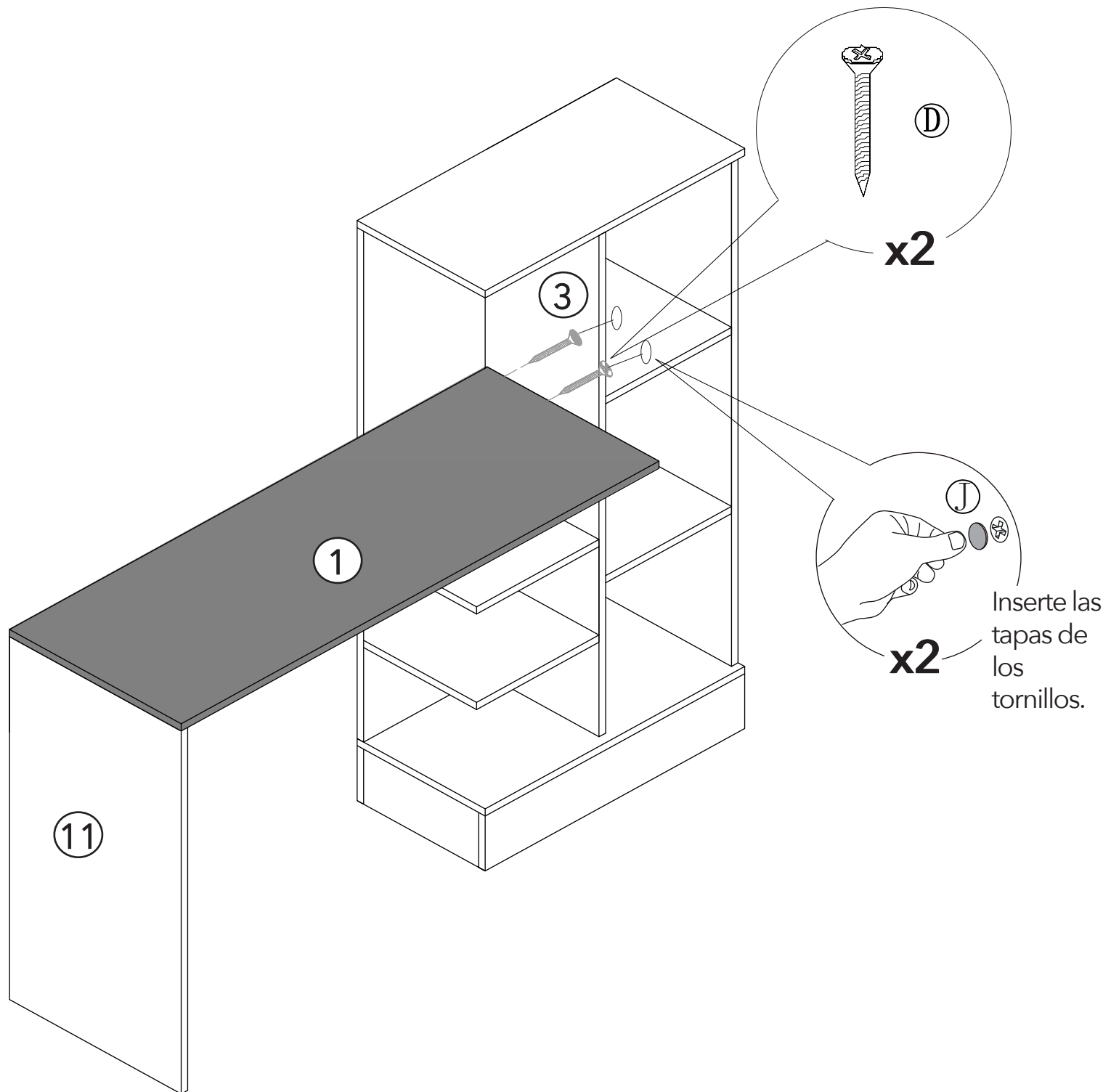

## PASO 15

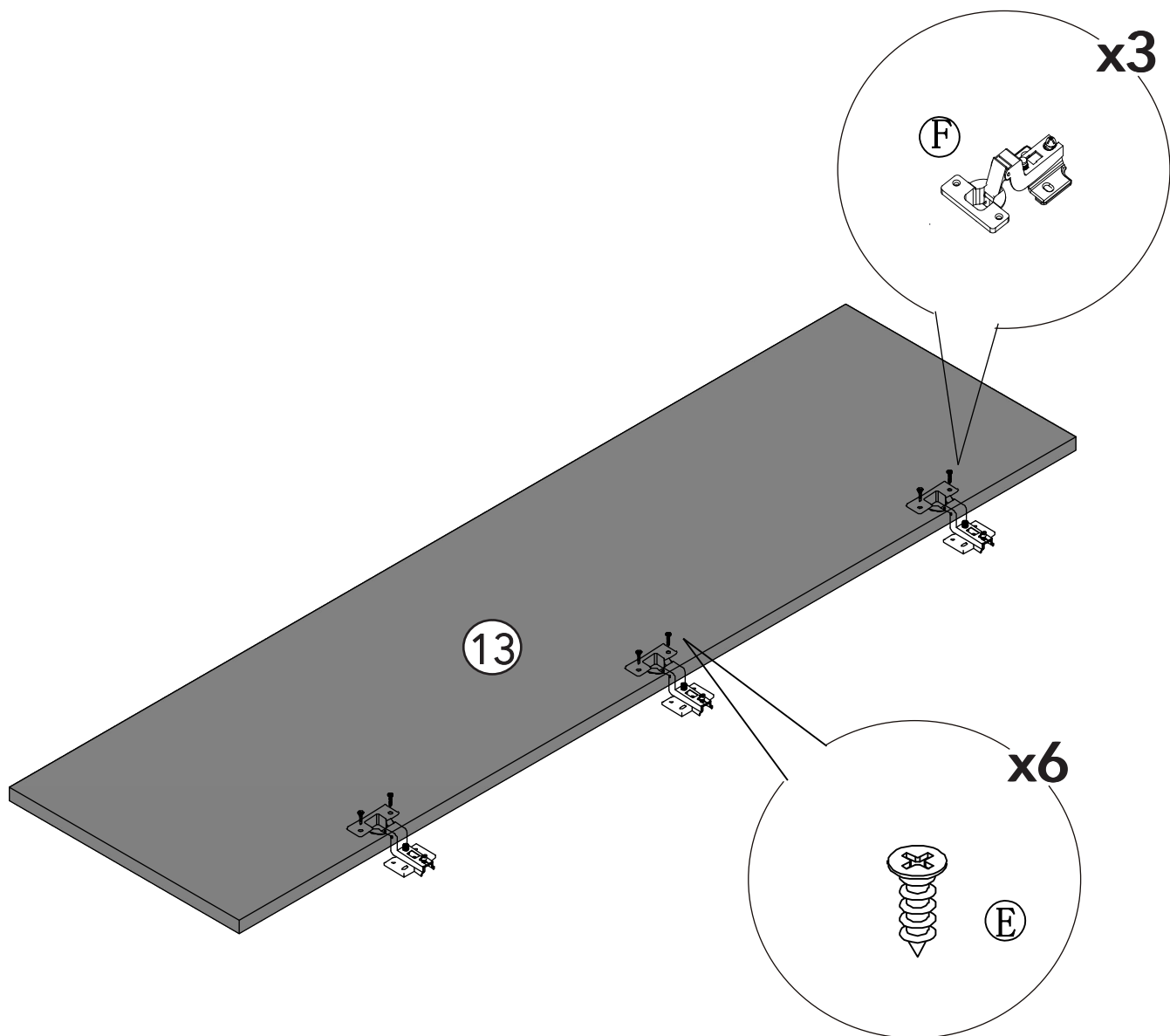

## PASO 16

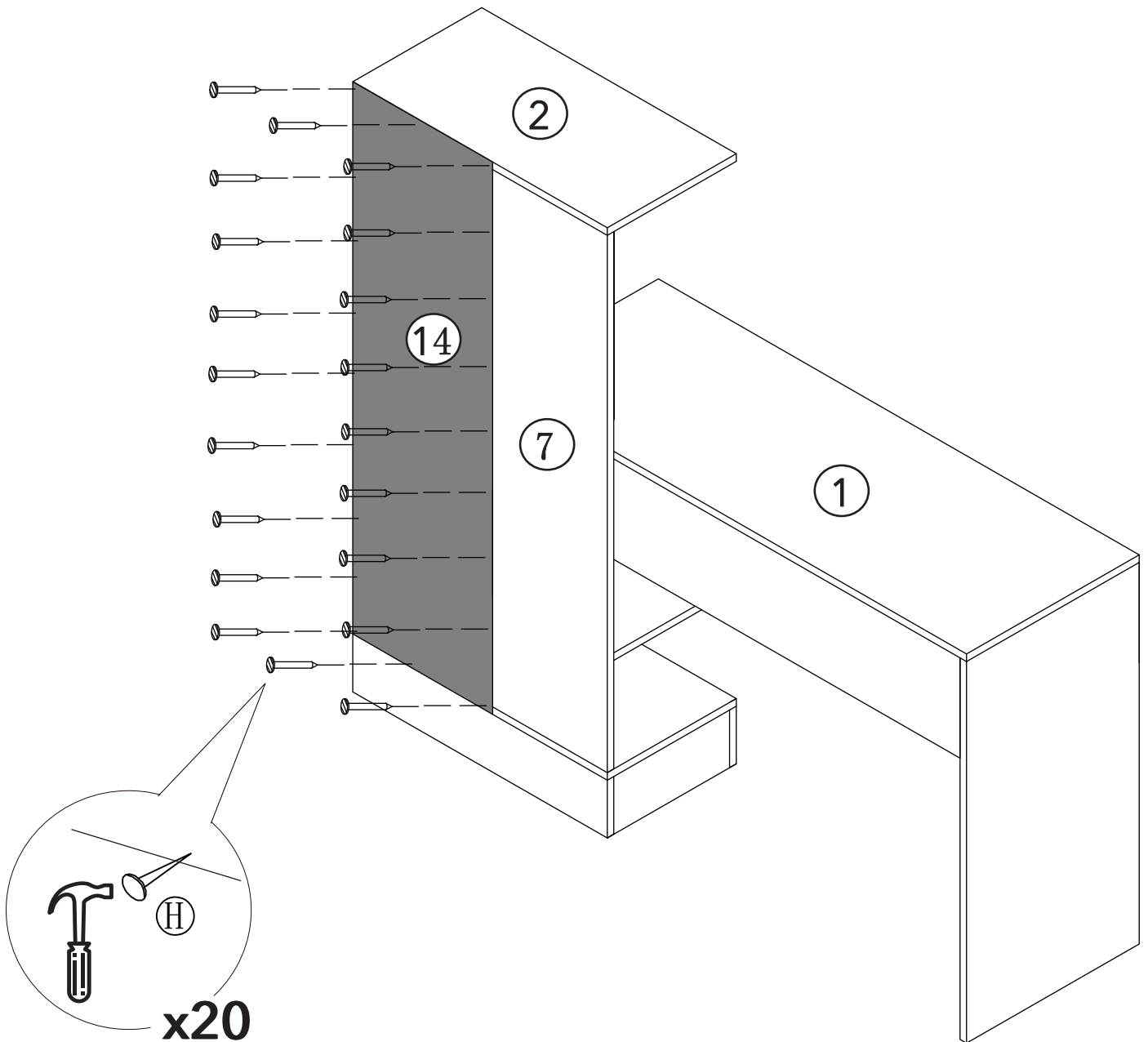

## PASO 17

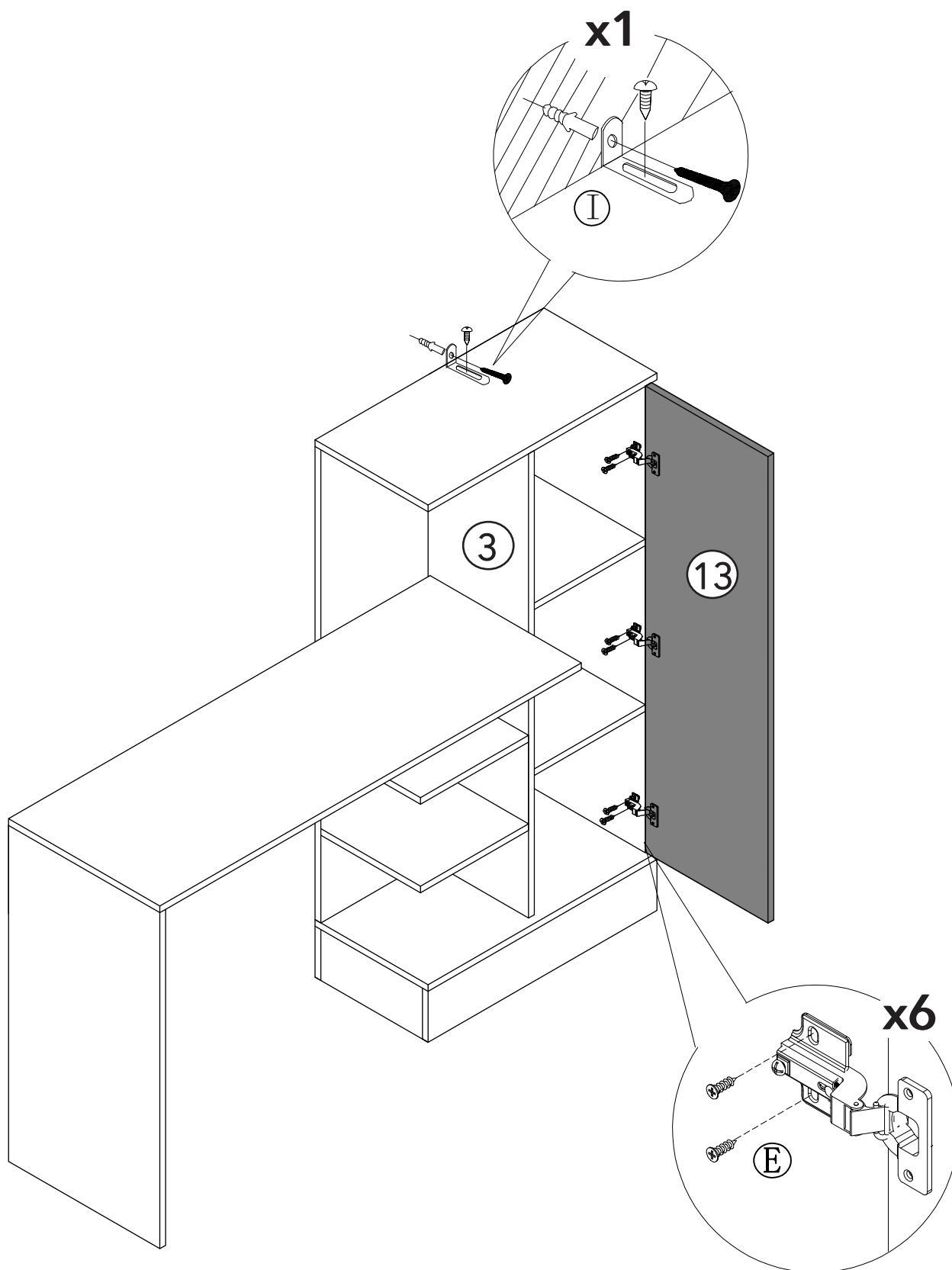



## **TODOS JUNTOS**

Entre todos sí es posible  
lograr un impacto real  
ahorrando papel.

