

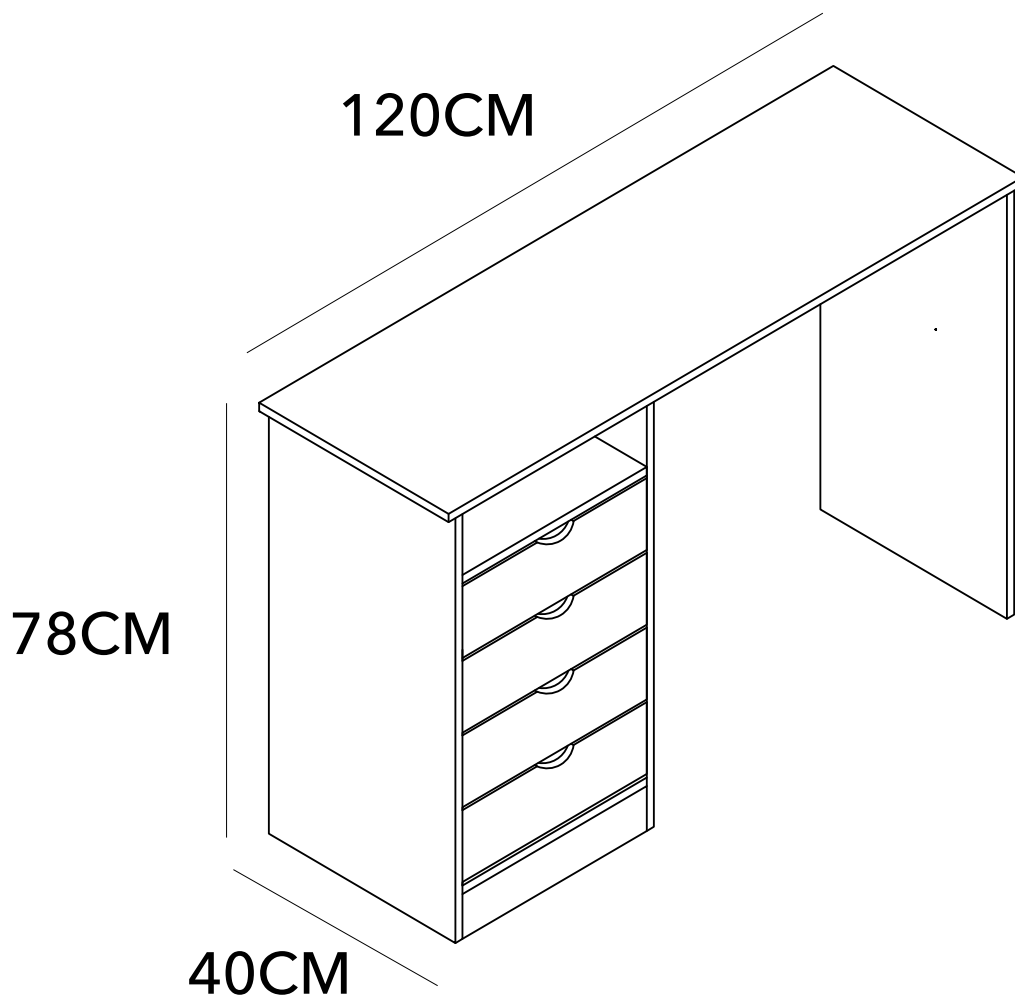

## **MANUAL DE INSTRUCCIONES**

ESCRITORIO 4 CAJONES BCO 120X40X78

MODELO: MB2703TT25-19



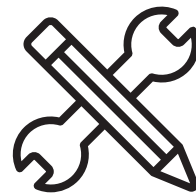

## ADVERTENCIA

Siga las instrucciones que se detallan en el manual, si presenta alguna diferencia en el contenido de sus piezas pongase en contacto con la tienda donde fue adquirido.

## RECOMENDACIONES

- Estudie atentamente las instrucciones antes del montaje.
- Ordene las piezas que componen el mueble.
- Agrupe y ordene la quincallería.
- Prepare una zona despejada para el montaje.
- Monte las piezas sin forzar los ensambles, una vez armada toda la estructura, reaprete de forma definitiva.
- Volver a apretar los tornillos después de un tiempo de uso.
- Conserve estas instrucciones de montaje.



Herramientas requeridas  
(no incluidas)



2 persona para  
el armado



Producto contenido  
en 1 cajas

## QUINCALLERÍA

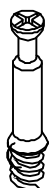

Ax30



Bx30



Cx28

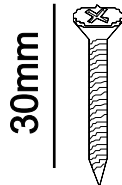

Dx16



Ex40

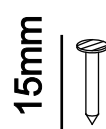

Fx16



Gx12

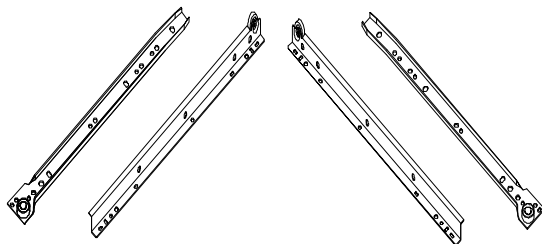

Ox4sets

# PIEZAS

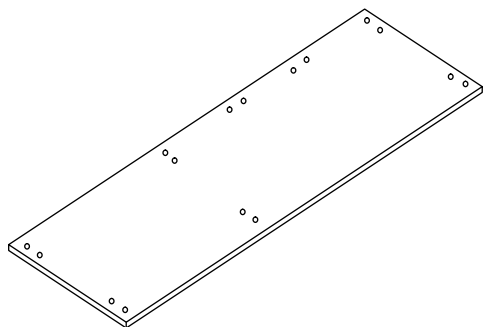

① x1

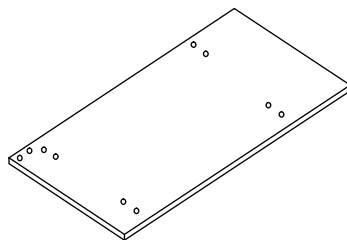

② x1

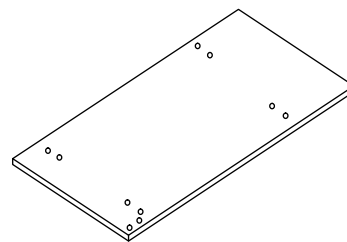

③ x1

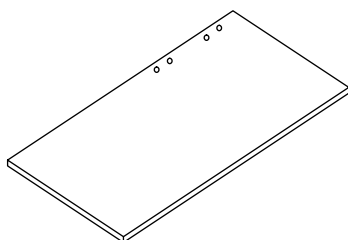

④ x1

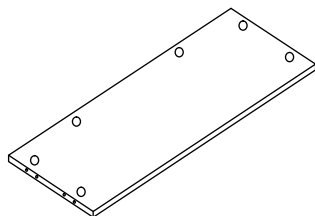

⑤ x1

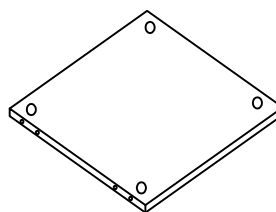

⑥ x1

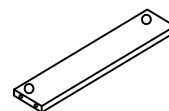

⑦ x2

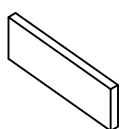

⑧ x4



⑨ x4

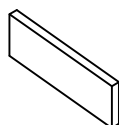

⑩ x4

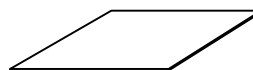

⑪ x4

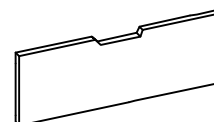

⑫ x4

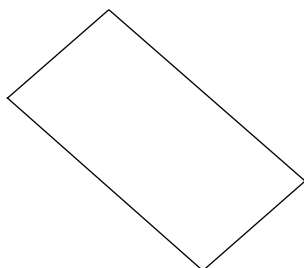

⑬ x1

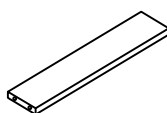

⑭ x1

# PASO 1

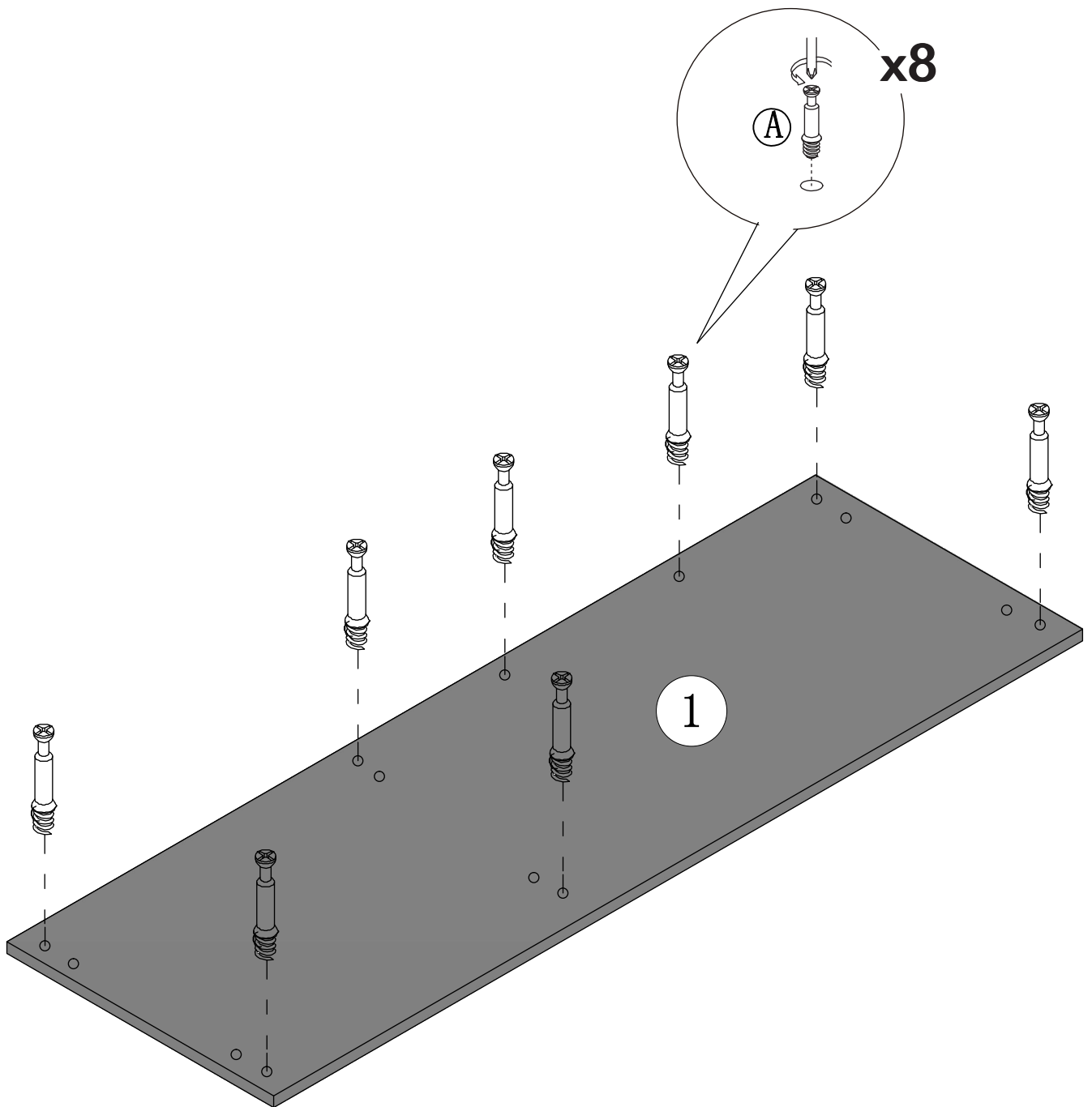

## PASO 2

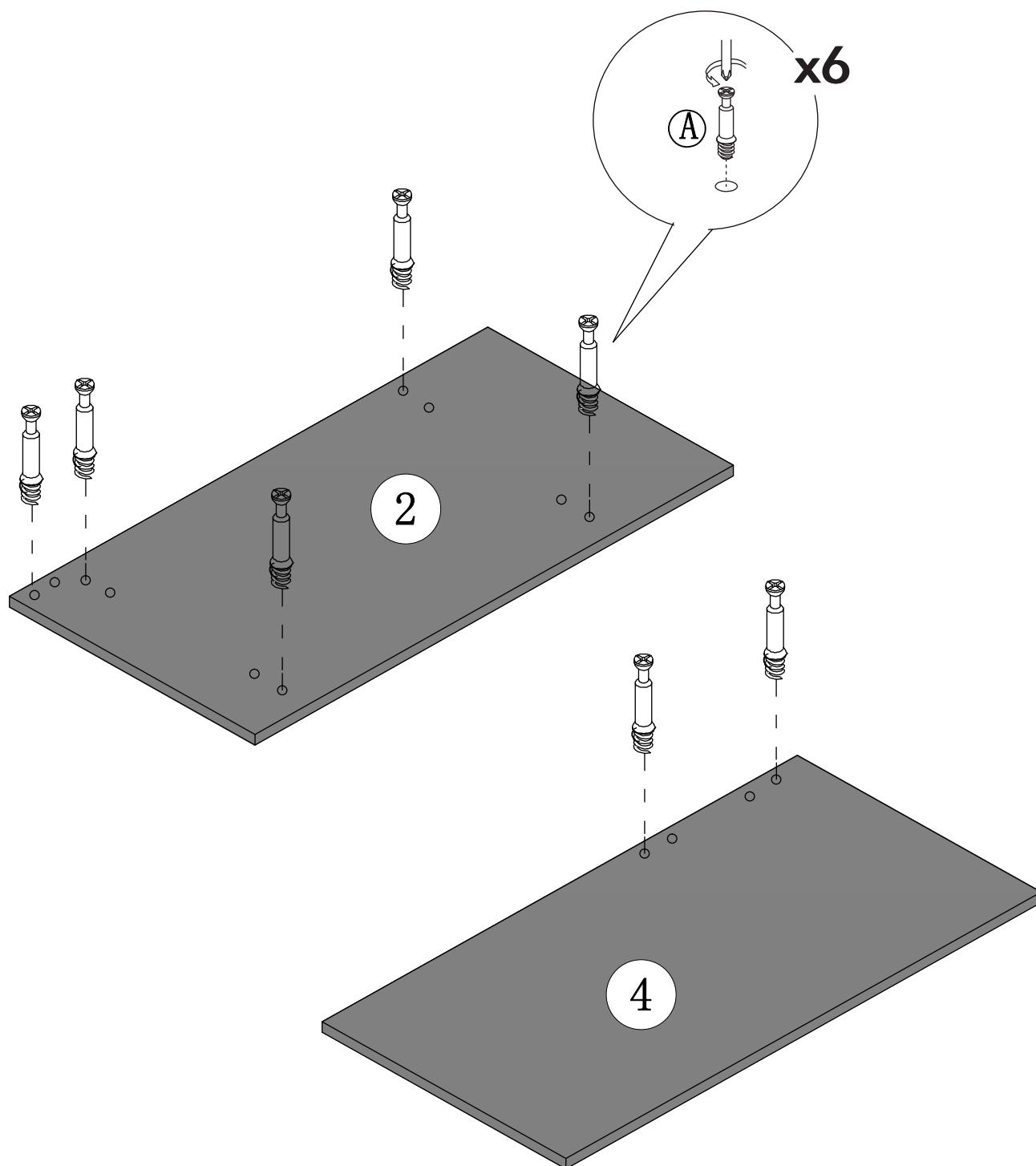

PASO 3

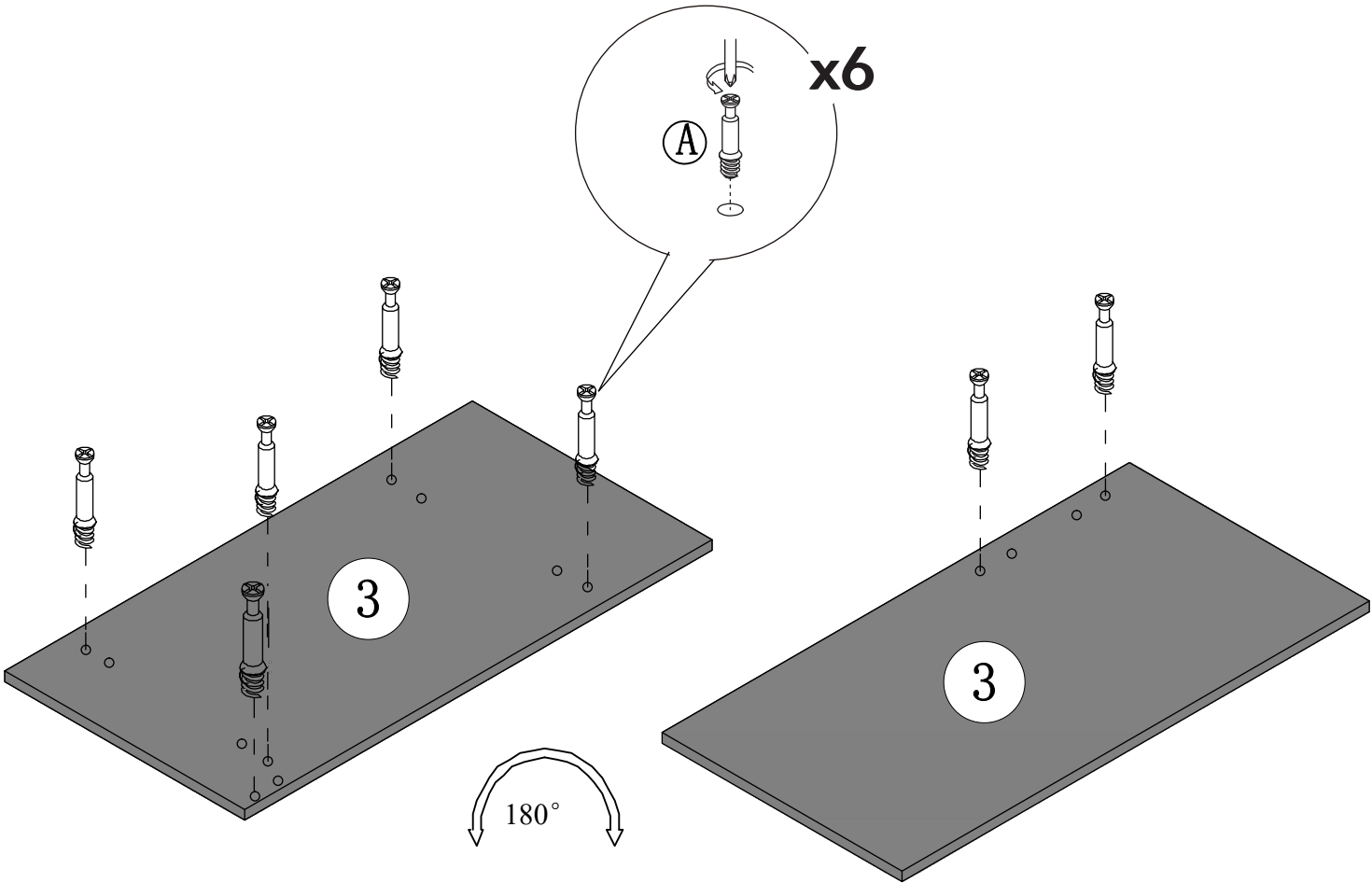

## PASO 4

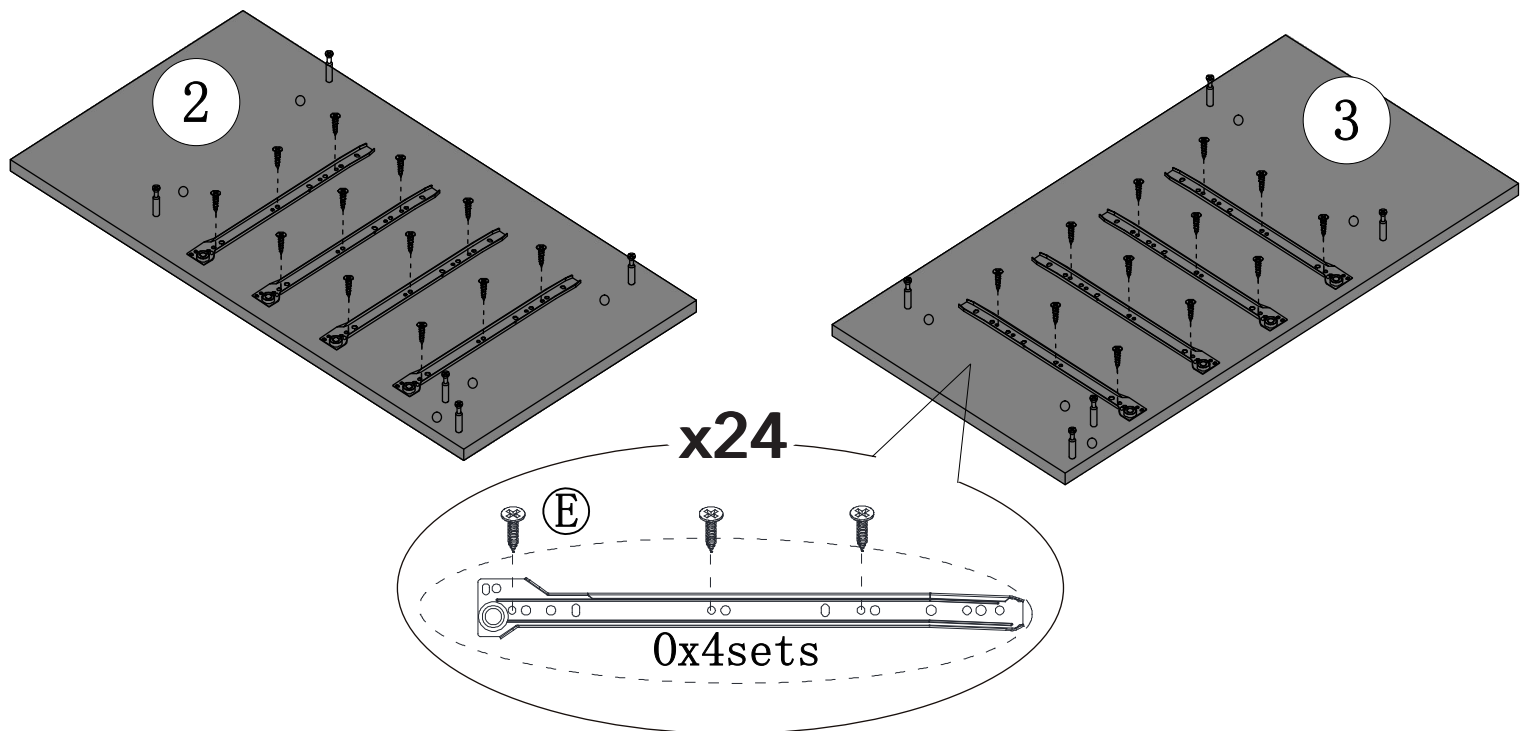



PASO 5

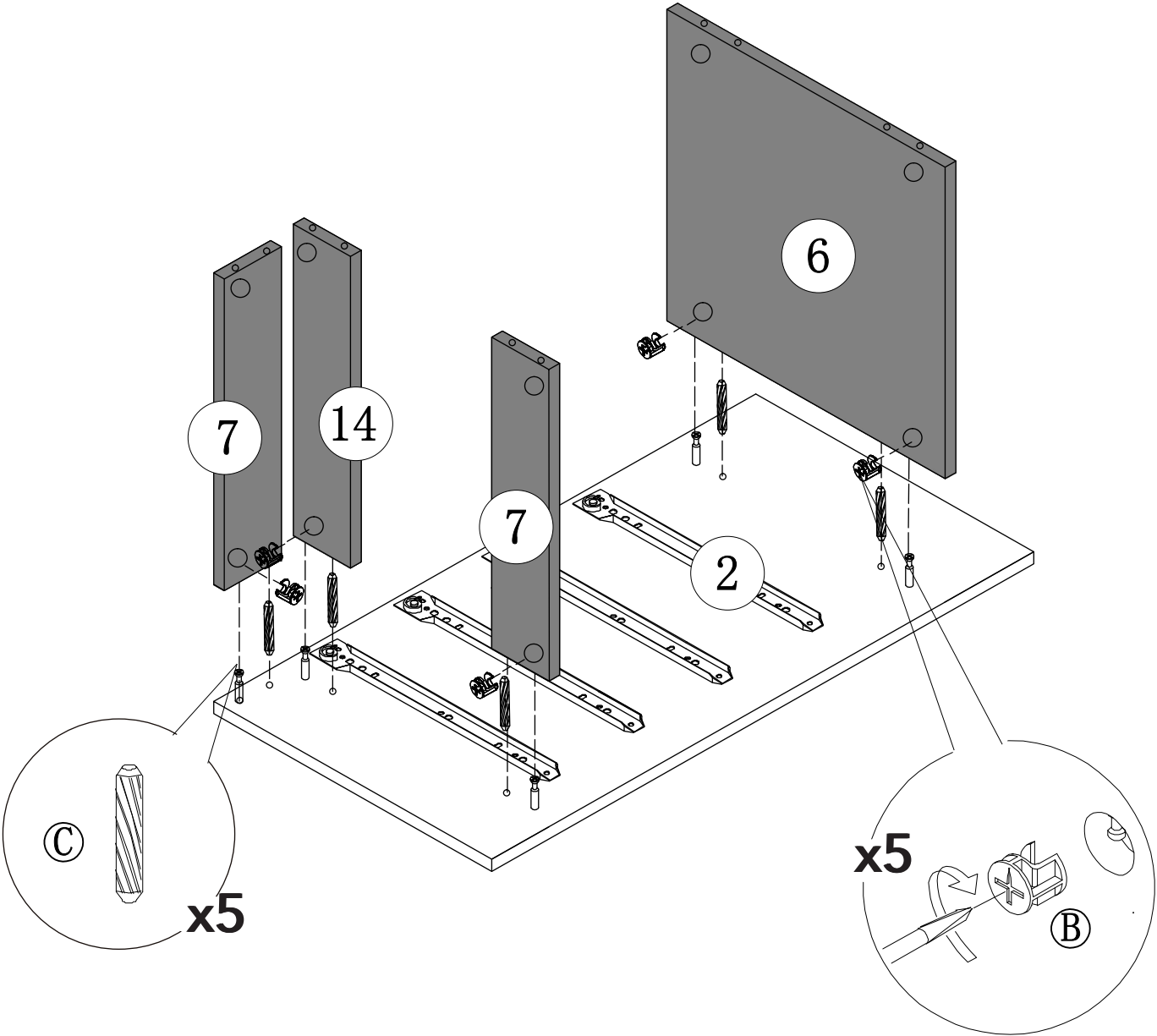

## PASO 6

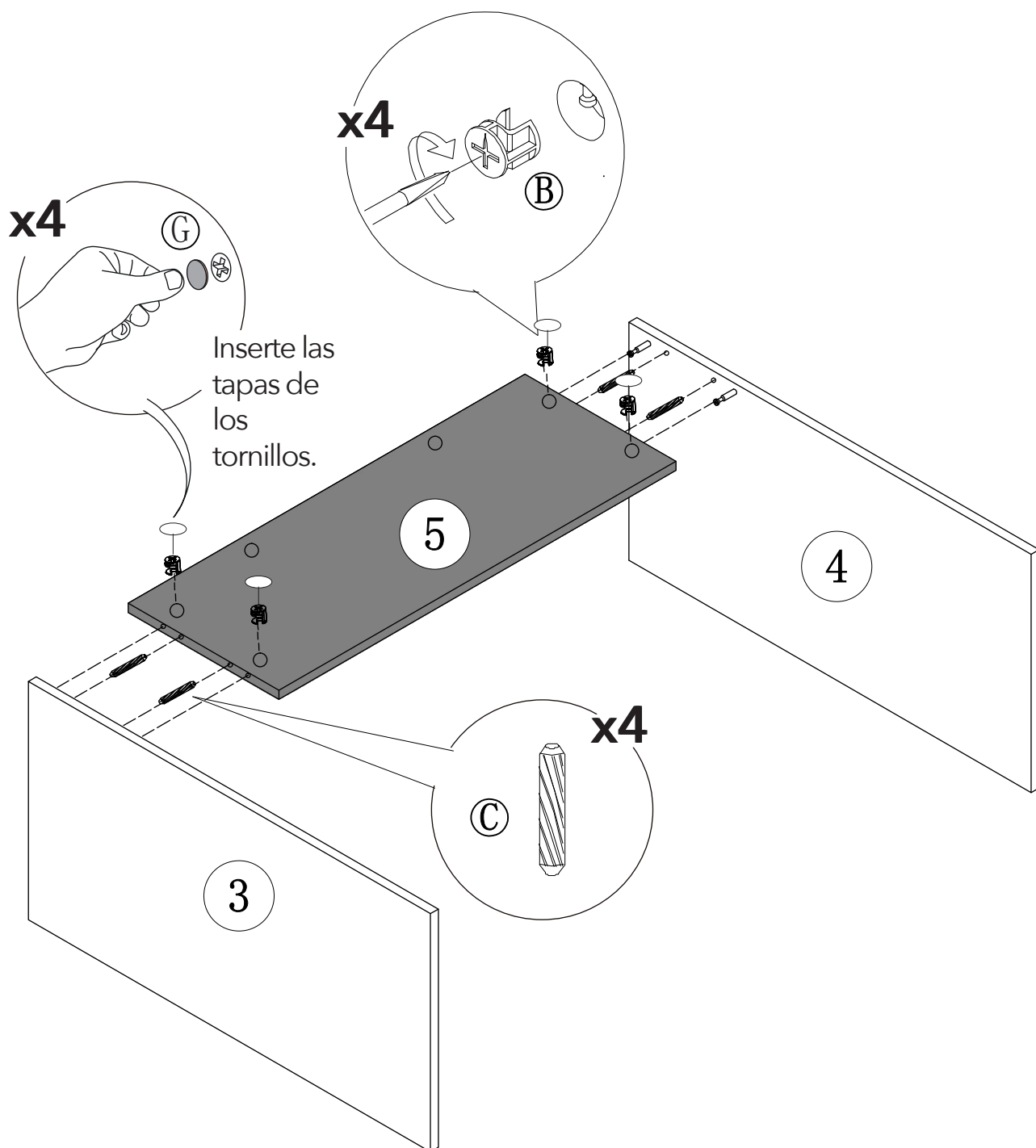

## PASO 7

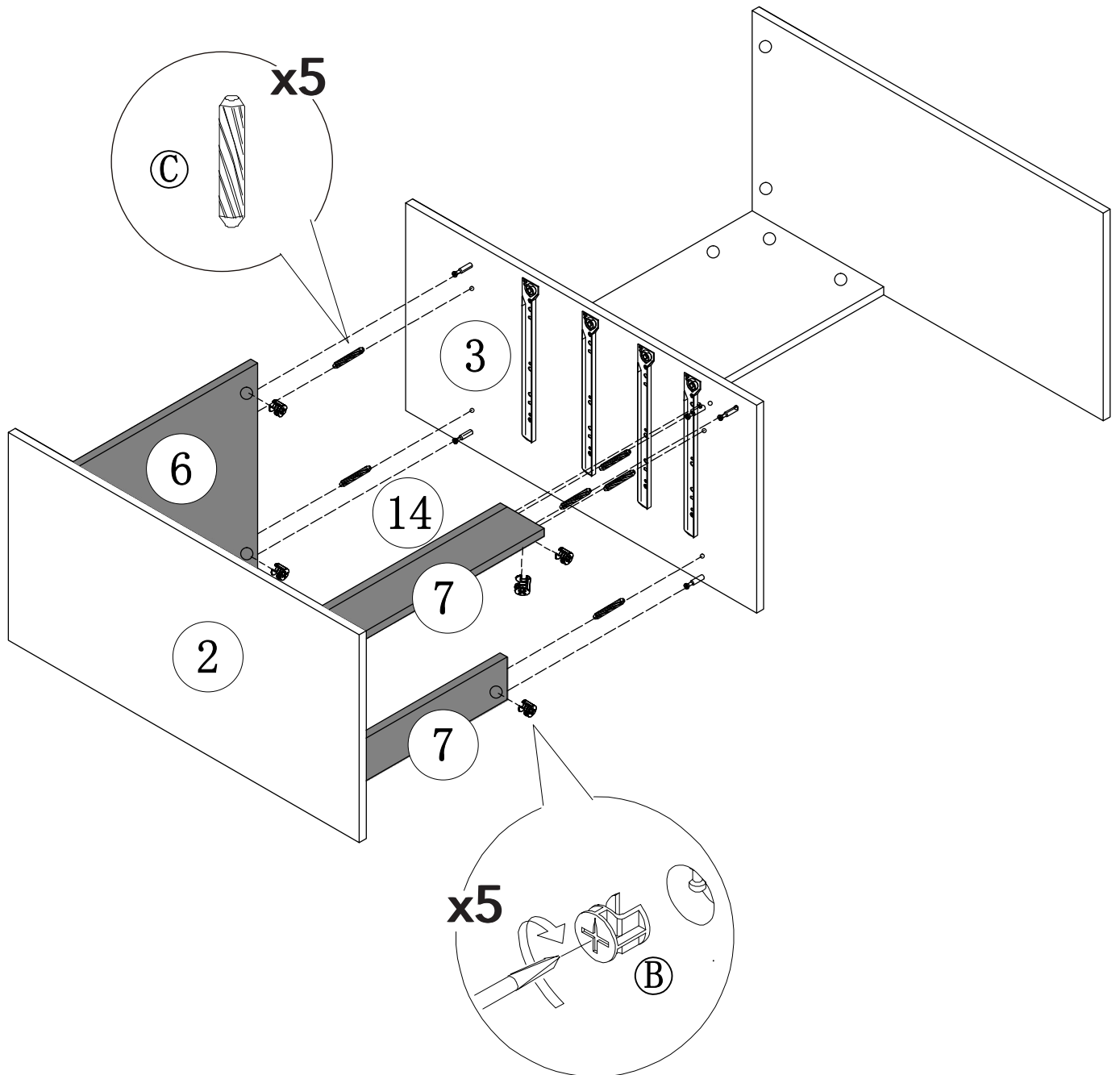

## PASO 8

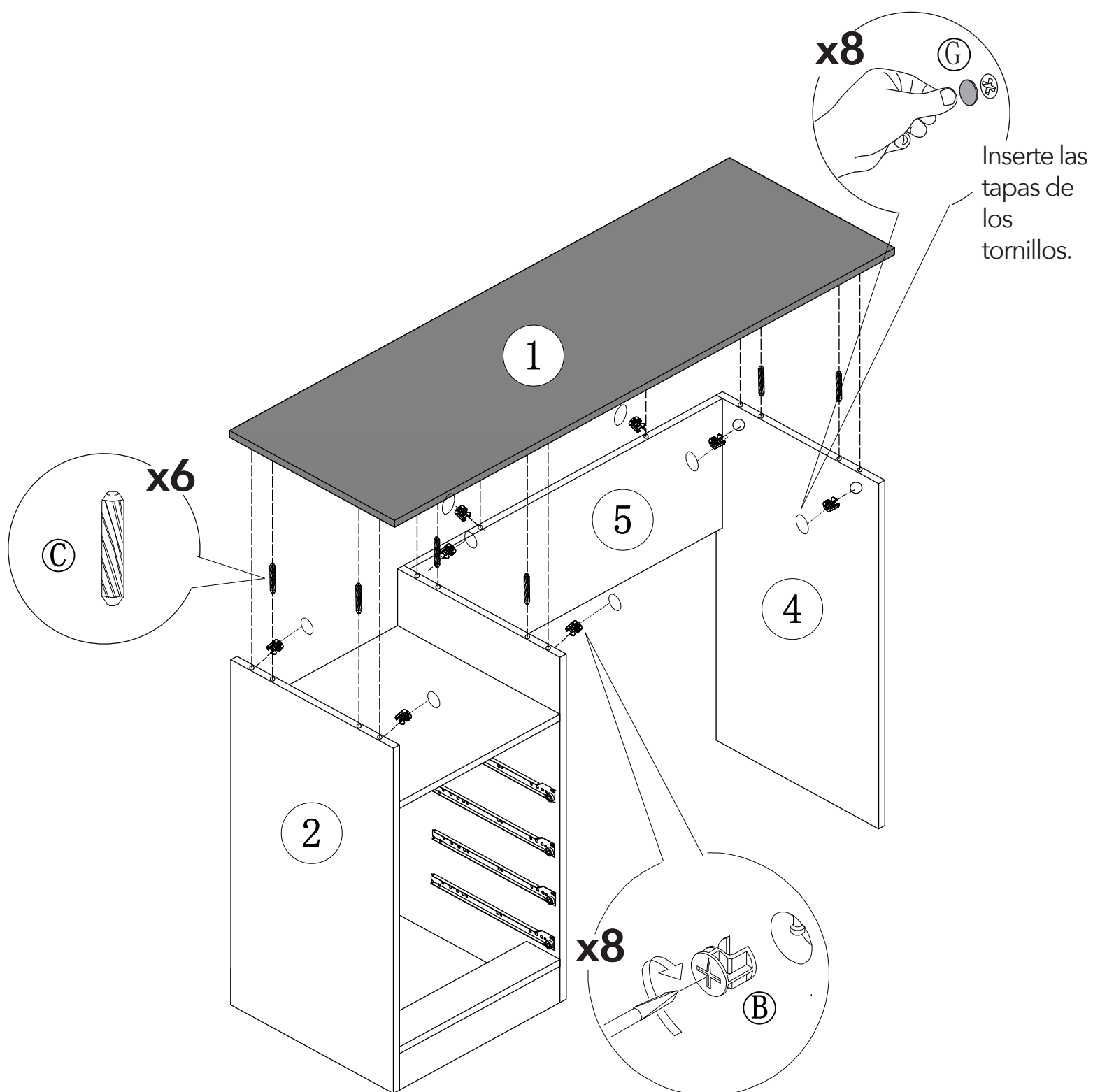

## PASO 9

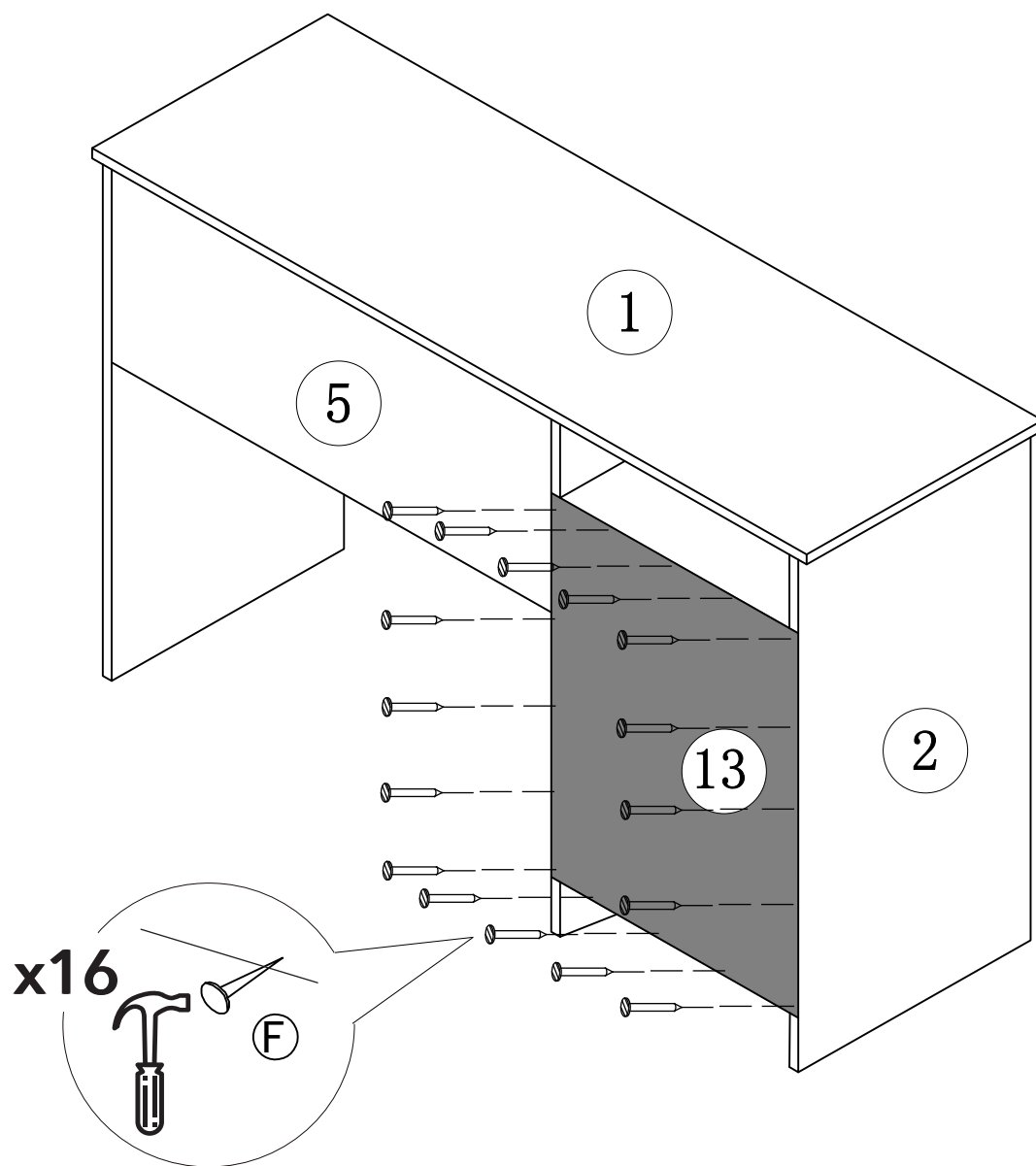

# PASO 10

x4

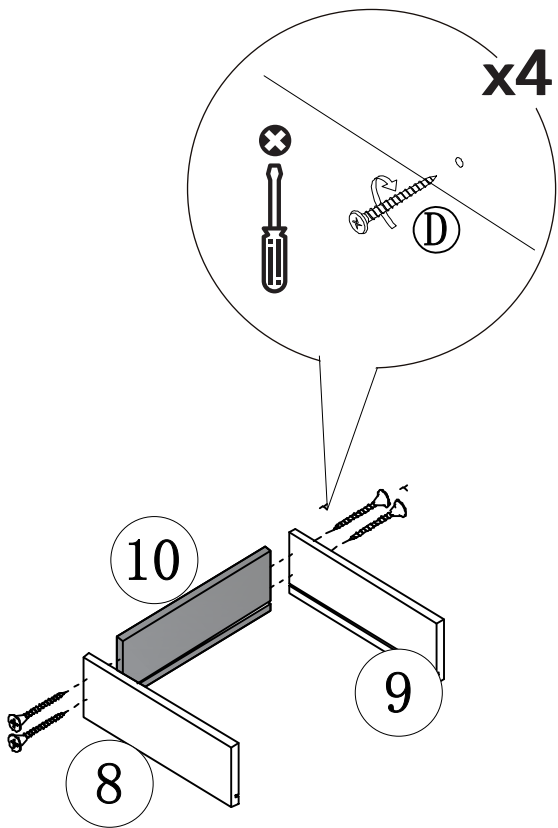

x4

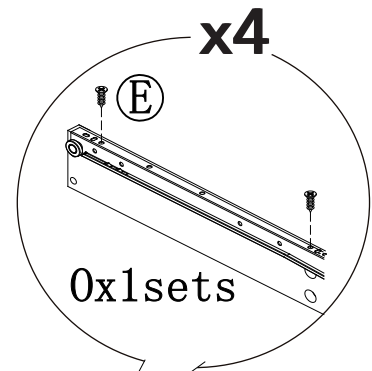

0x1sets

x2

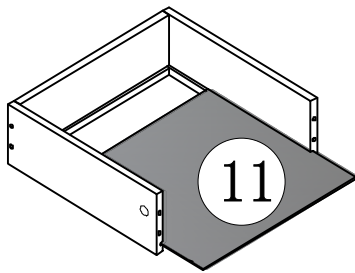
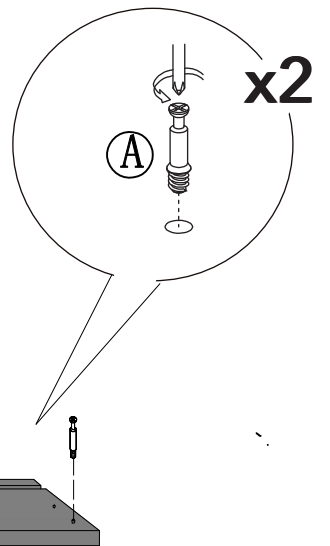

x2

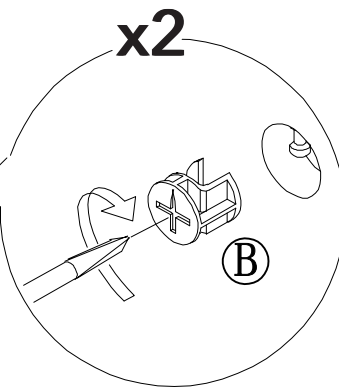

x2

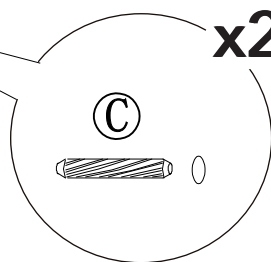

x4

PASO 11

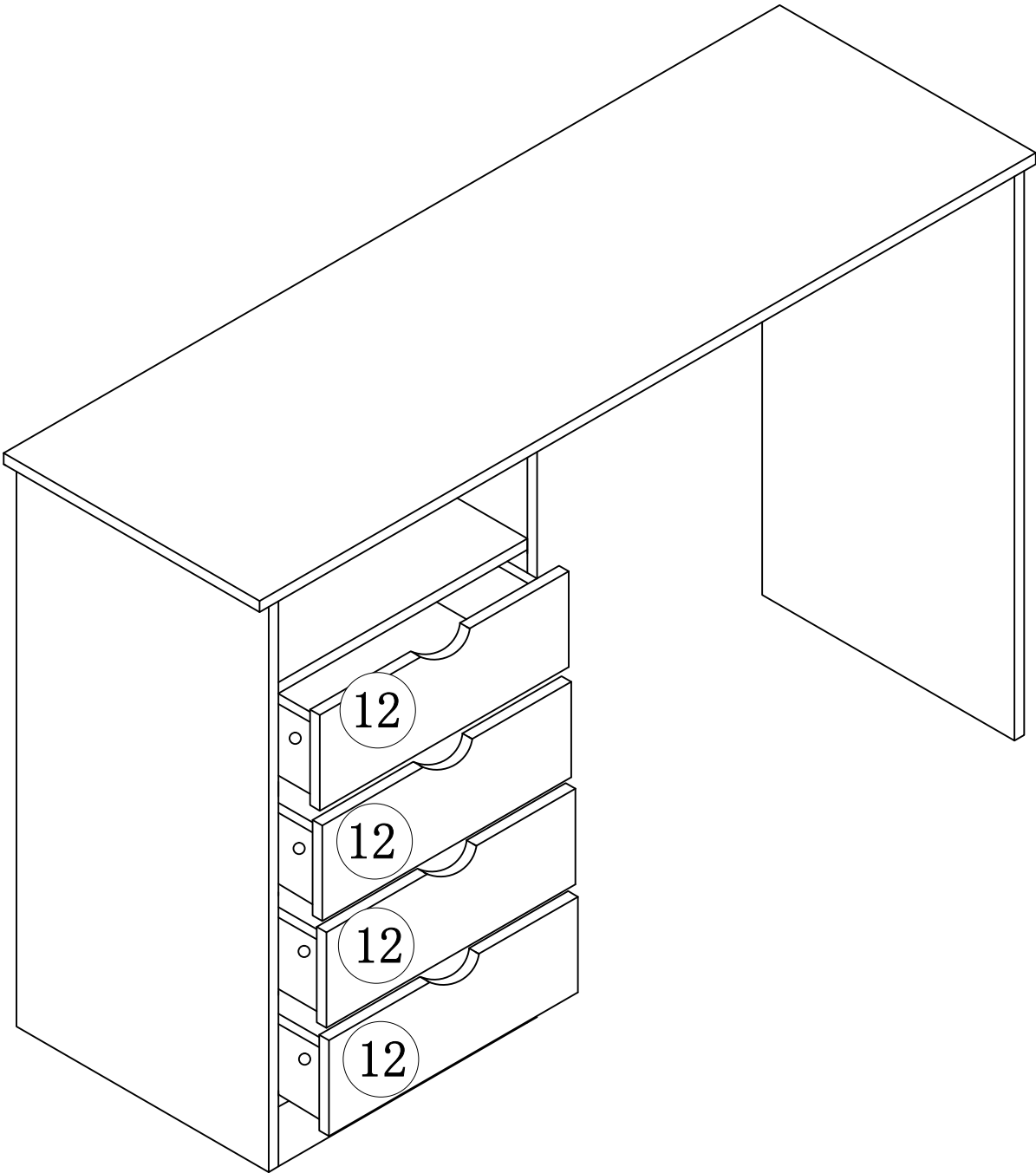



## **TODOS JUNTOS**

Entre todos sí es posible  
lograr un impacto real  
ahorrando papel.

