

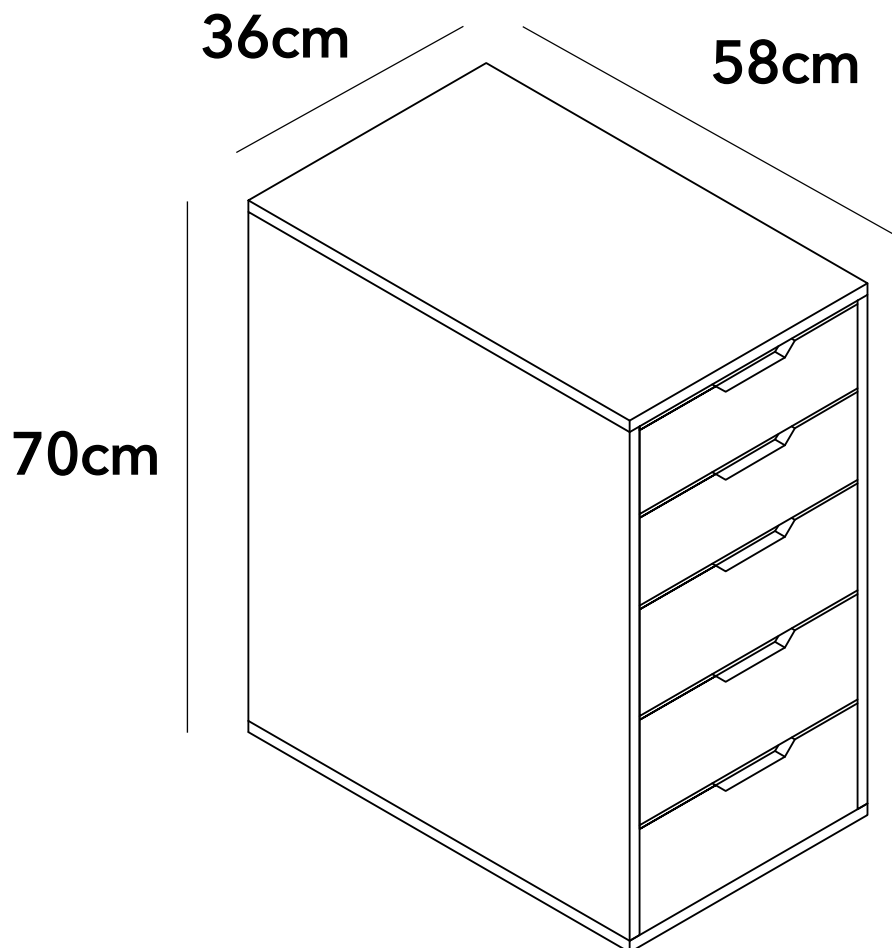

MANUAL DE INSTRUCCIONES

CAJONERA 5 BILL 36X58X70CM BCO

MODELO: MB2902TT26-1-2



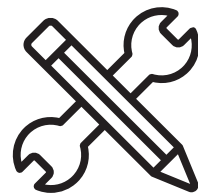

ADVERTENCIA

Siga las instrucciones que se detallan en el manual, si presenta alguna diferencia en el contenido de sus piezas pongase en contacto con la tienda donde fue adquirido.

RECOMENDACIONES

- Estudie atentamente las instrucciones antes del montaje.
- Ordene las piezas que componen el mueble.
- Agrupe y ordene la quincallería.
- Prepare una zona despejada para el montaje.
- Monte las piezas sin forzar los ensambles, una vez armada toda la estructura, reaprete de forma definitiva.
- Volver a apretar los tornillos después de un tiempo de uso.
- Conserve estas instrucciones de montaje.



Herramientas requeridas
(no incluidas)



1 persona para
el armado



Producto contenido
en 1 cajas

QUINCALLERÍA

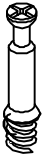

Ax24



Bx24

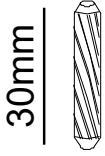

Cx8

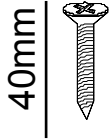

Dx12



Ex20



Fx8

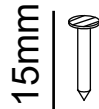

Gx26

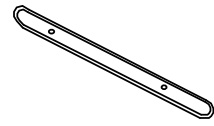

Hx10



Ix10

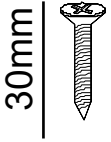

Jx20

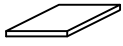

Kx4

PIEZAS

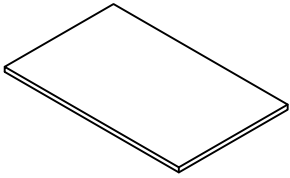

① x1

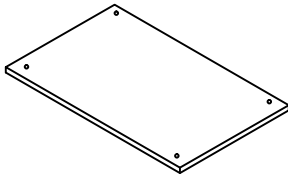

② x1

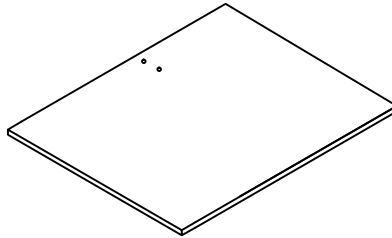

③ x1

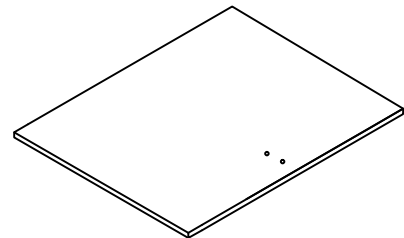

④ x1

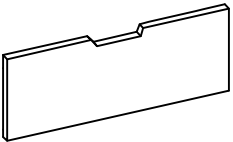

⑤ x3

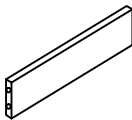

⑥ x2

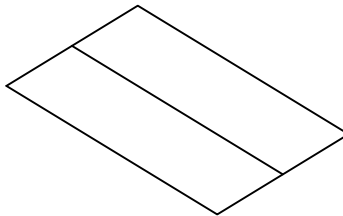

⑦ x1

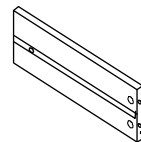

⑧ x5

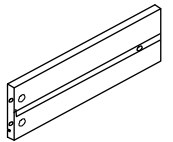

⑨ x5

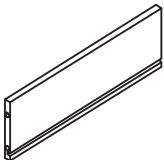

⑩ x5

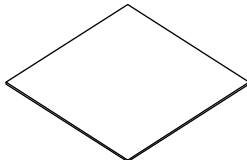

⑪ x5

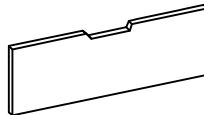

⑫ x2

PASO 1

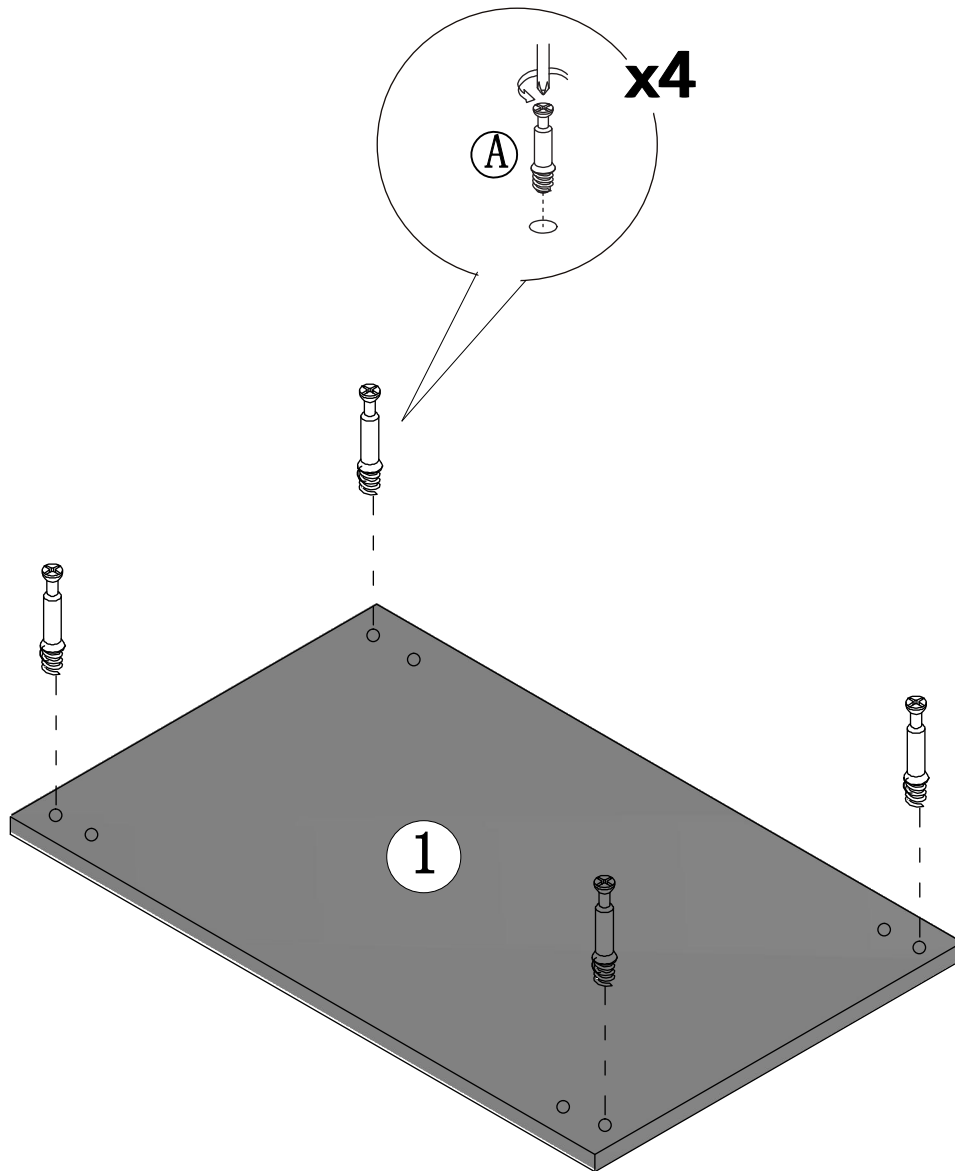

PASO 2

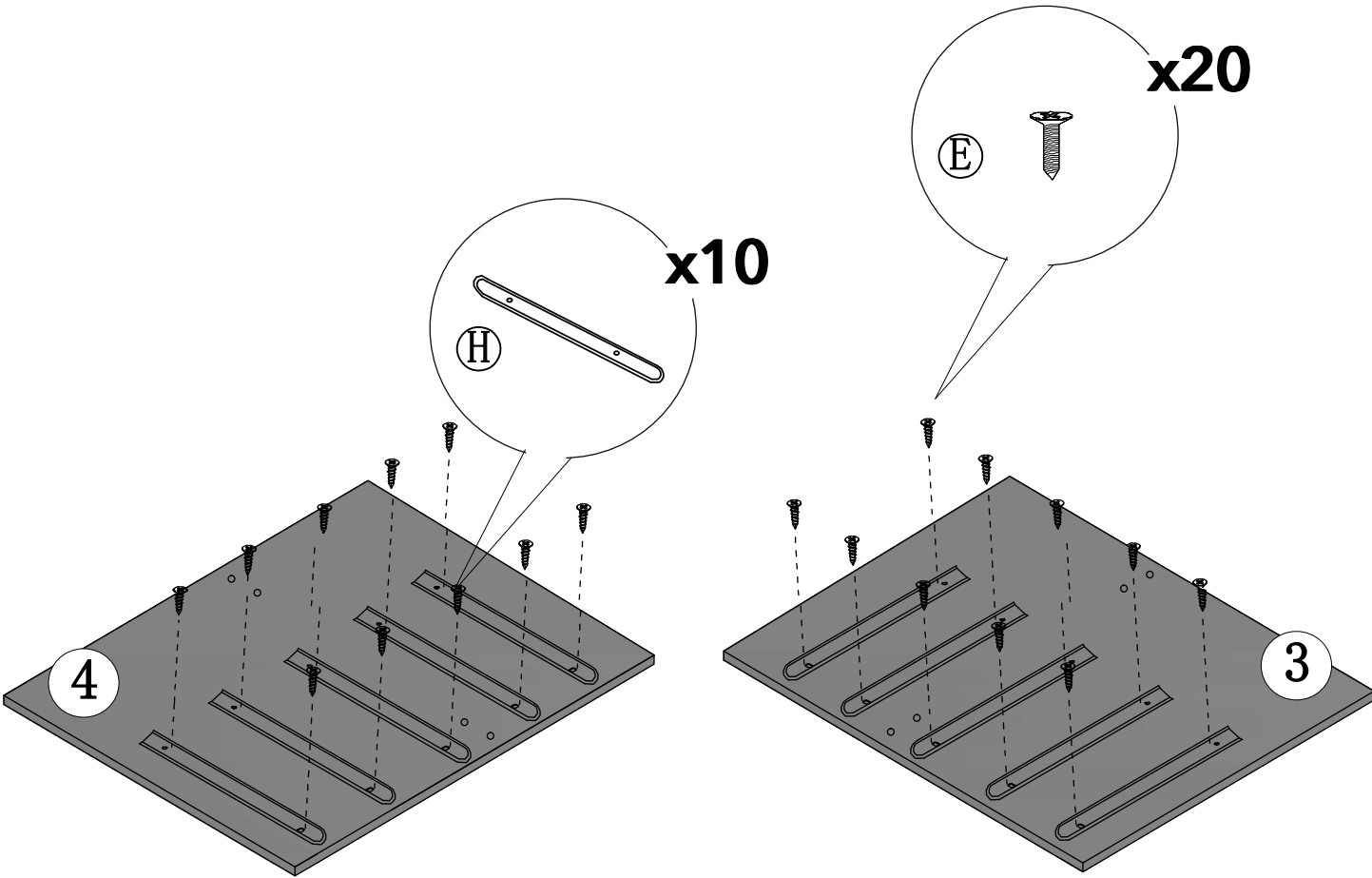

PASO 3

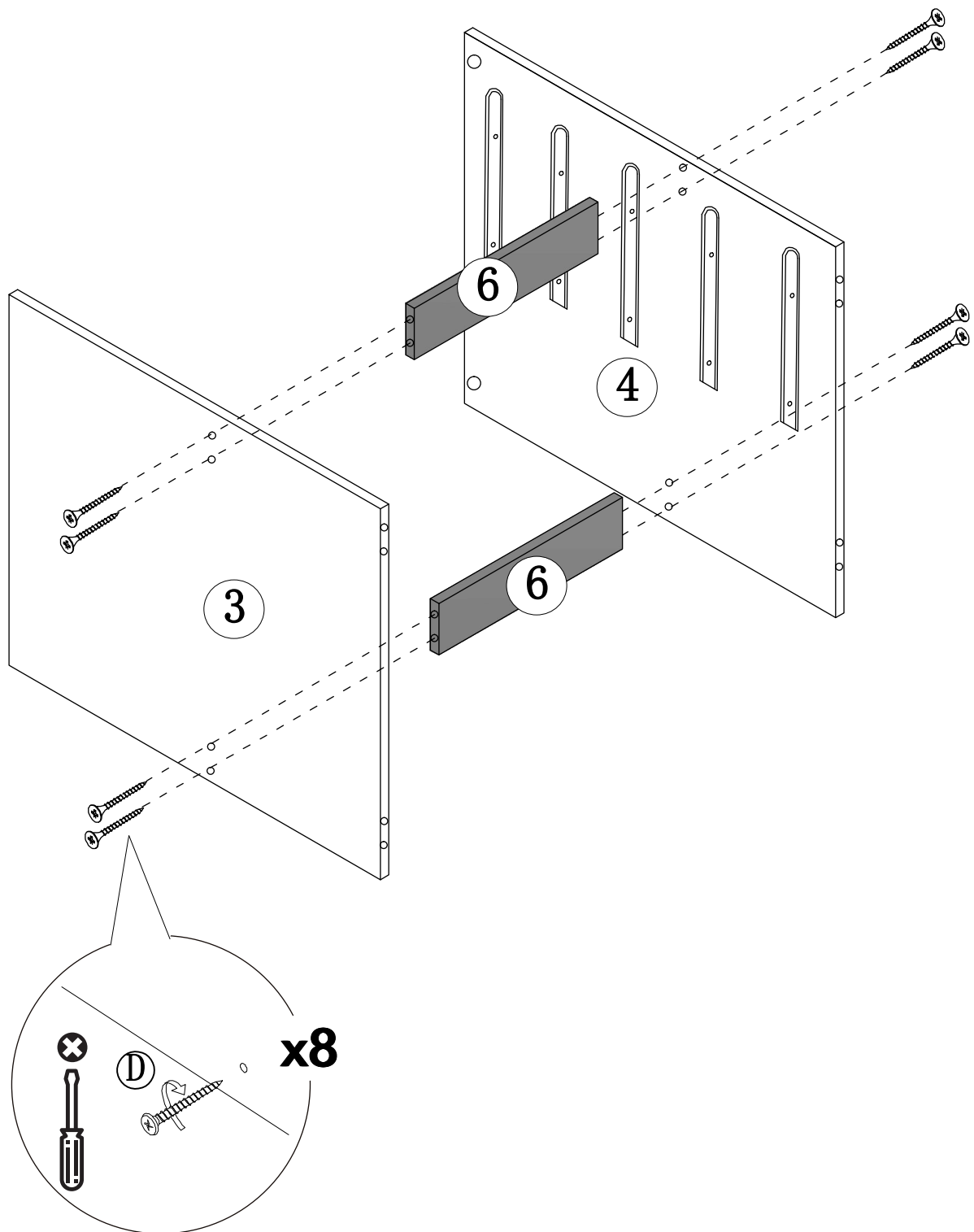

PASO 4

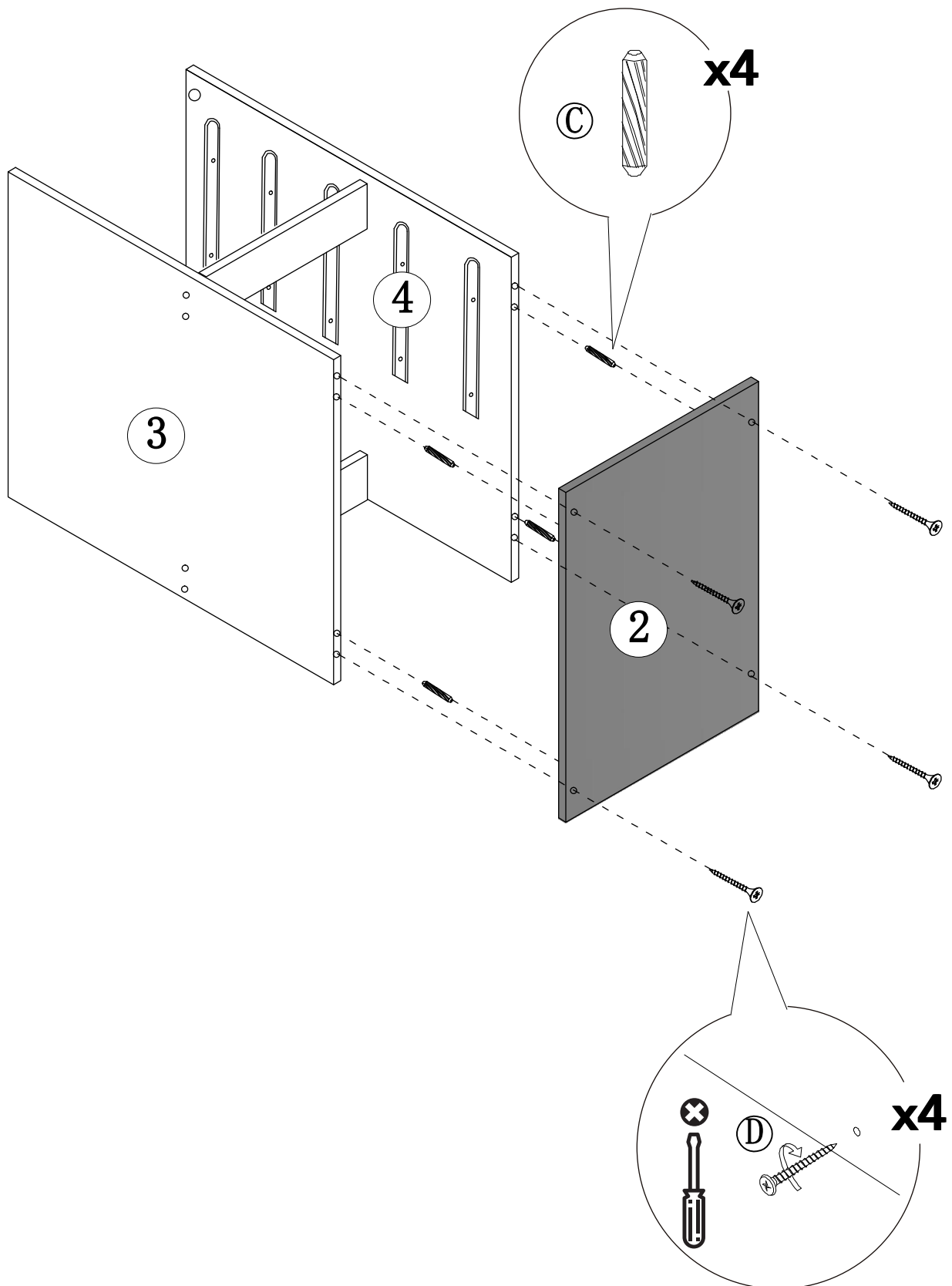

PASO 5

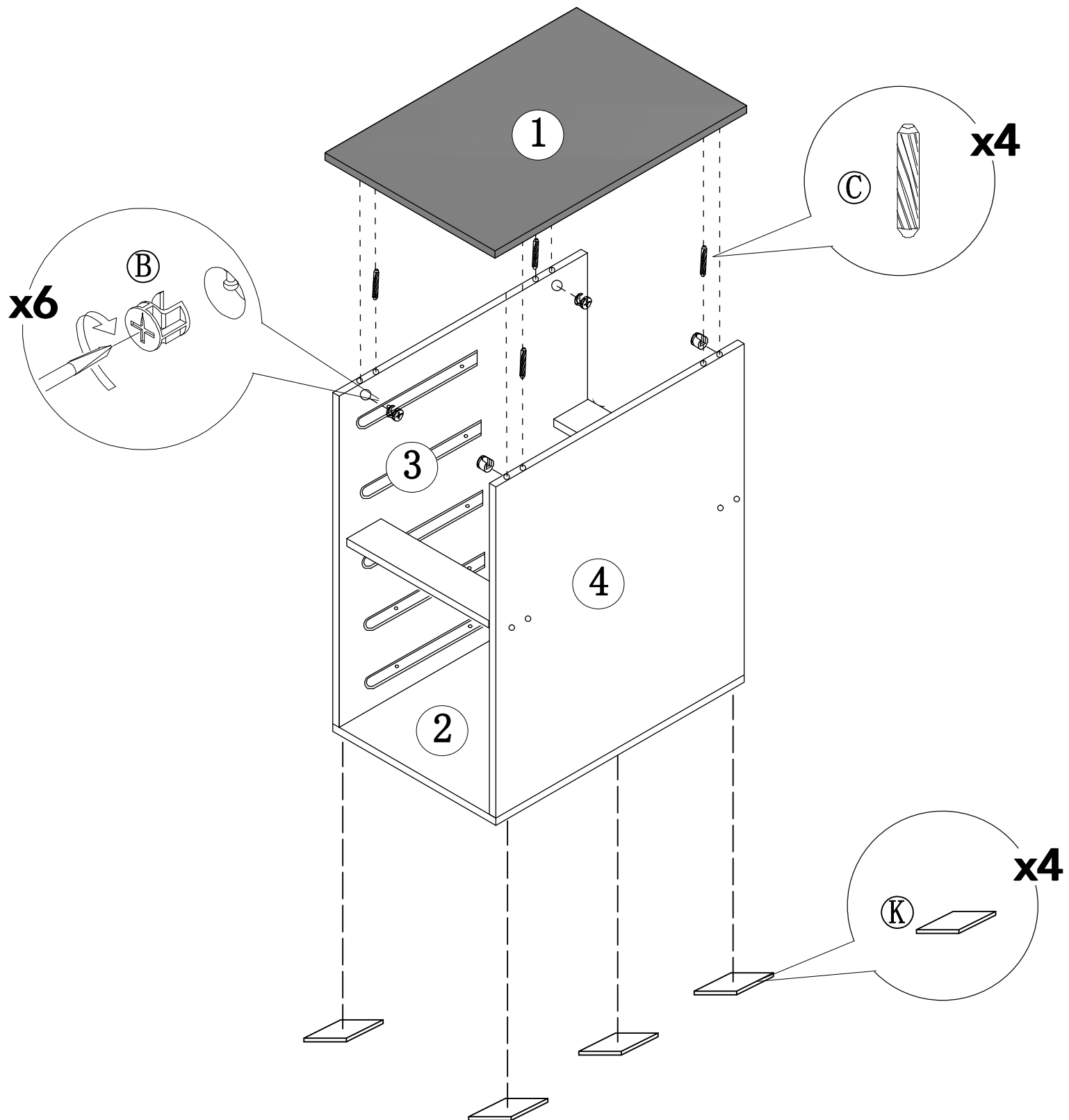

PASO 6

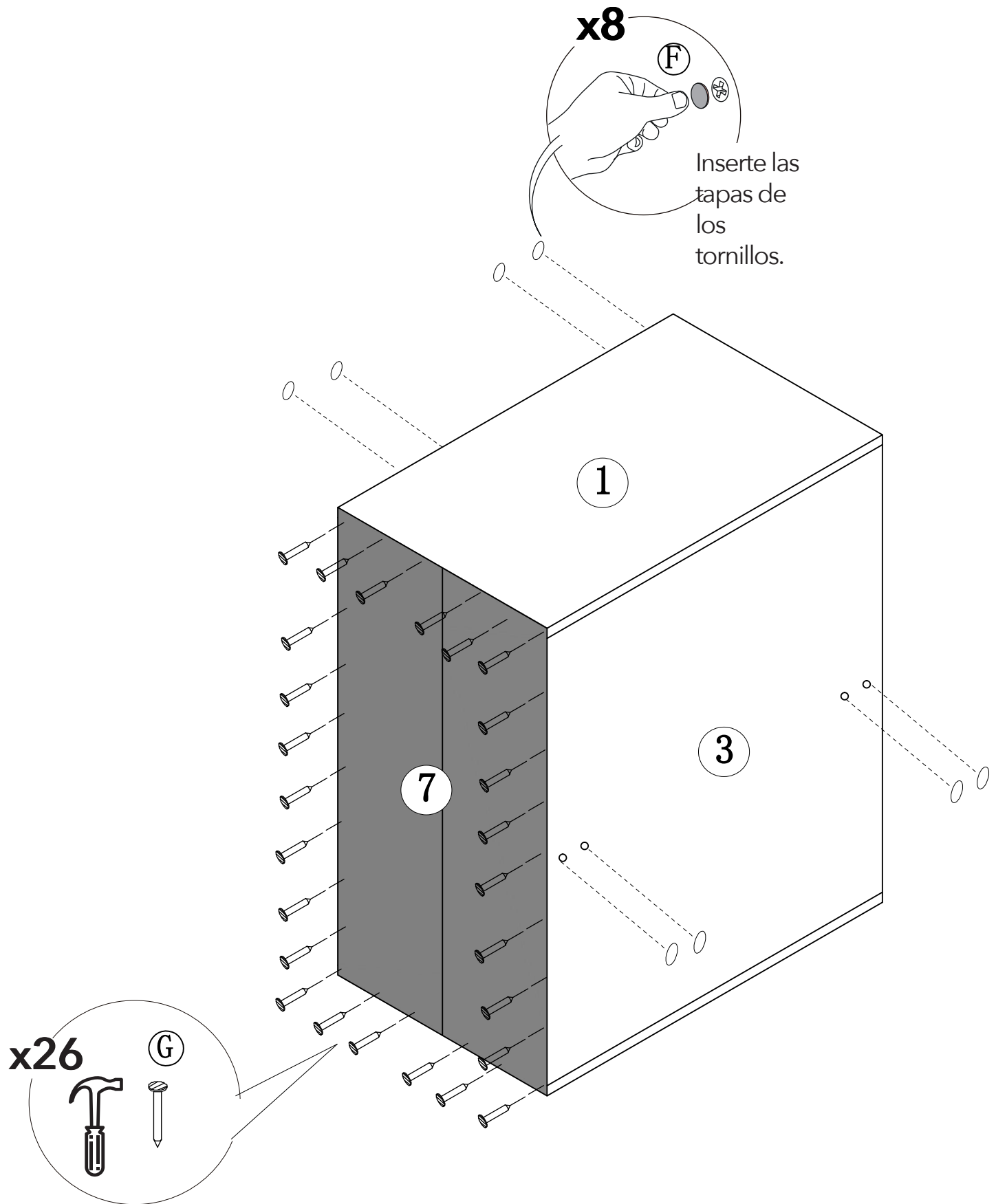

PASO 7

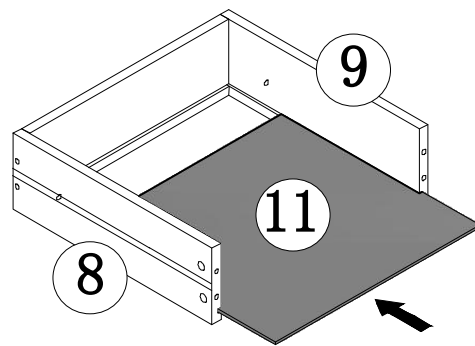
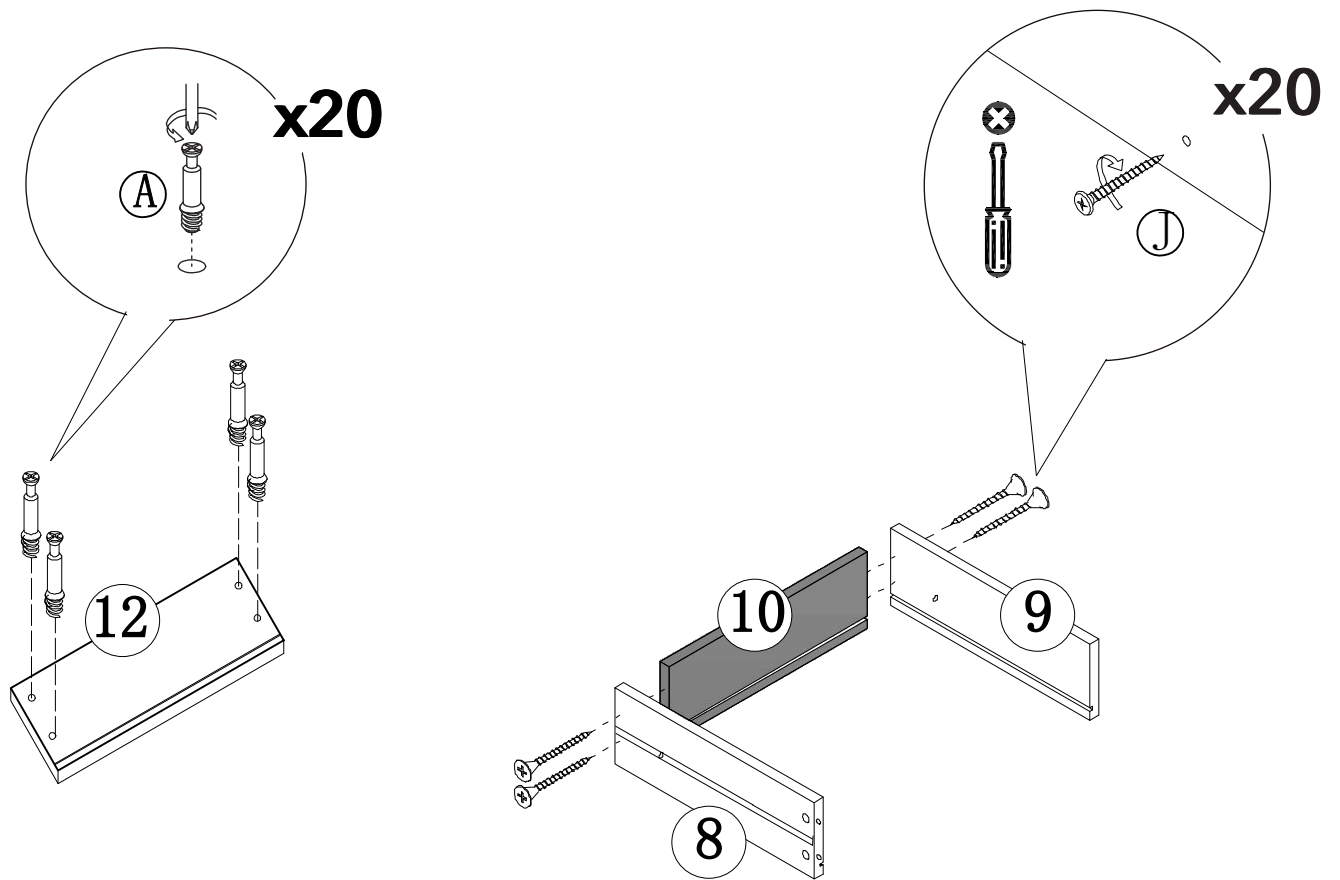

x5

PASO 8

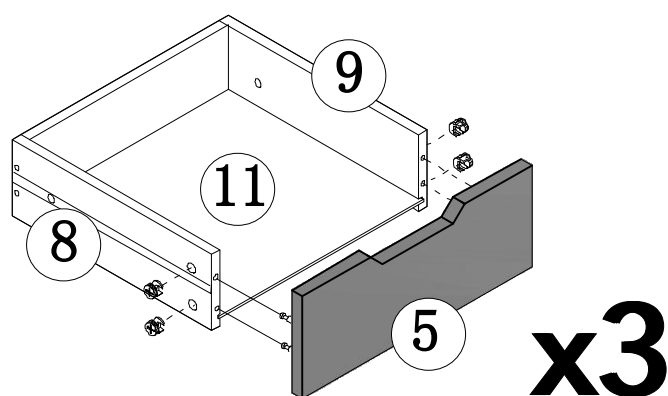
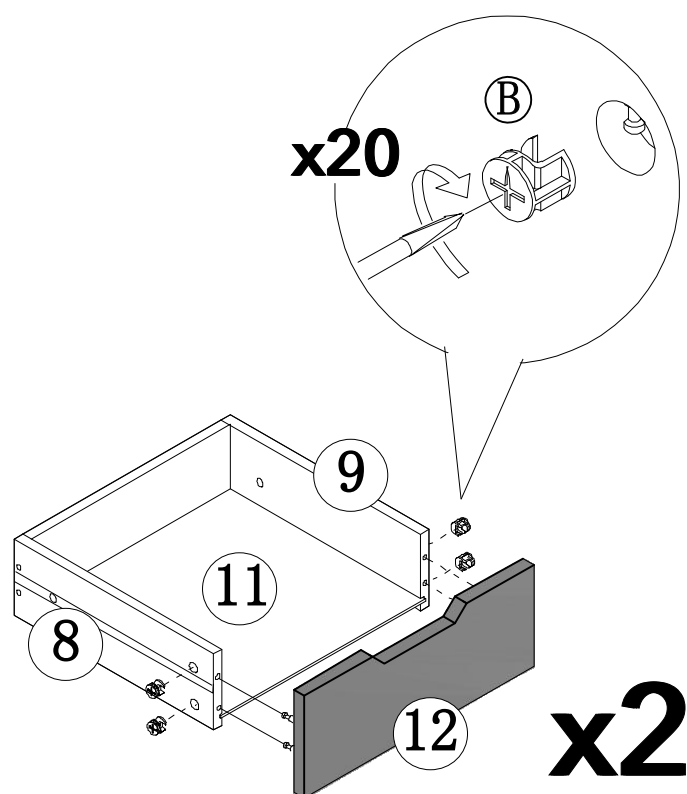

PASO 9

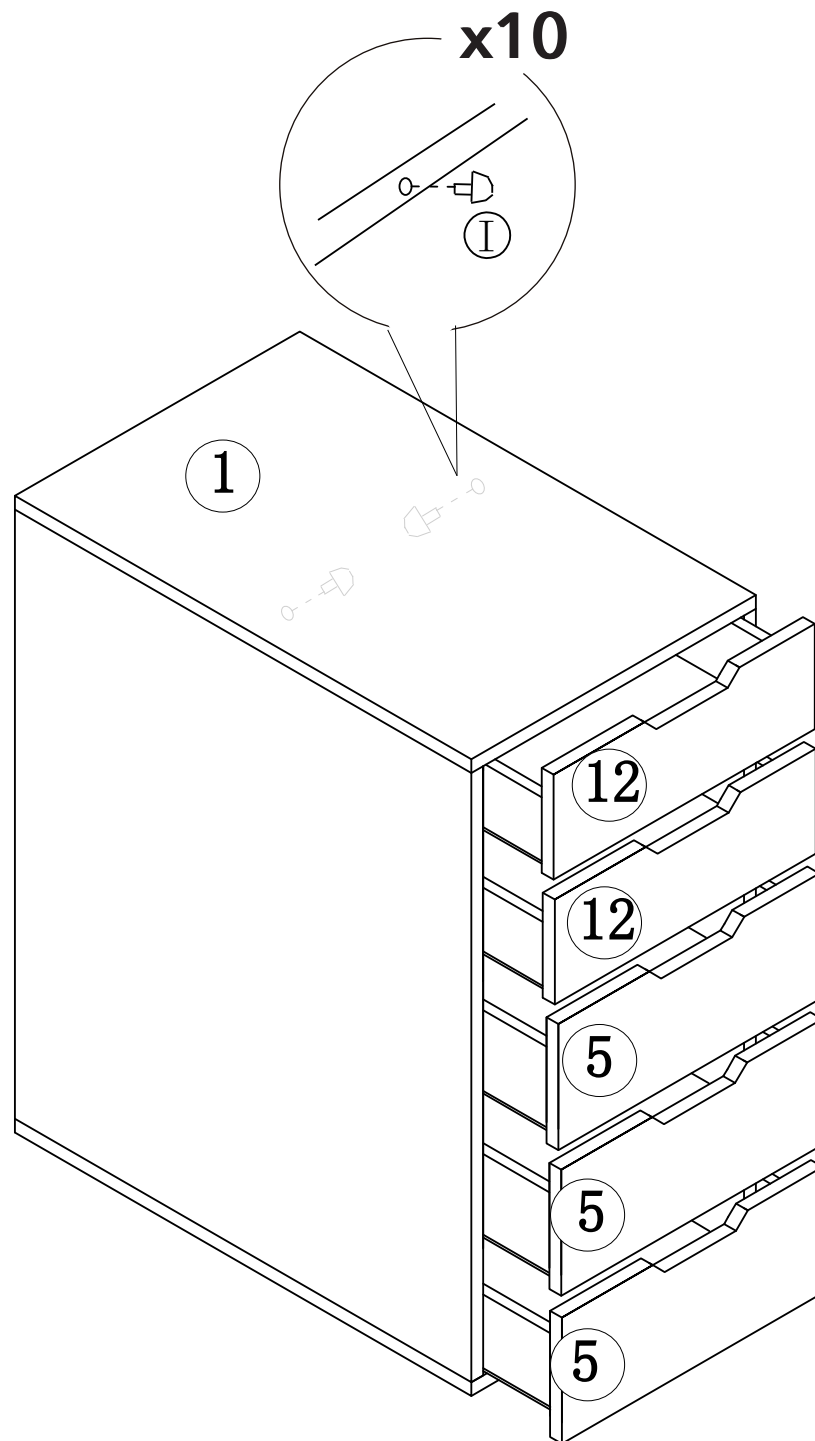



TODOS JUNTOS

Entre todos sí es posible
lograr un impacto real
ahorrando papel.

