

# INSTRUÇÃO DE MONTAGEM Assembly Instruction / Instrucciones de montaje

## ESCRIVANINHA 1 GAVETA PRATA Desk 1 Drawer / Escritorio 1 Cajón

Ref.: 2806

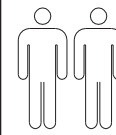

1:30min.

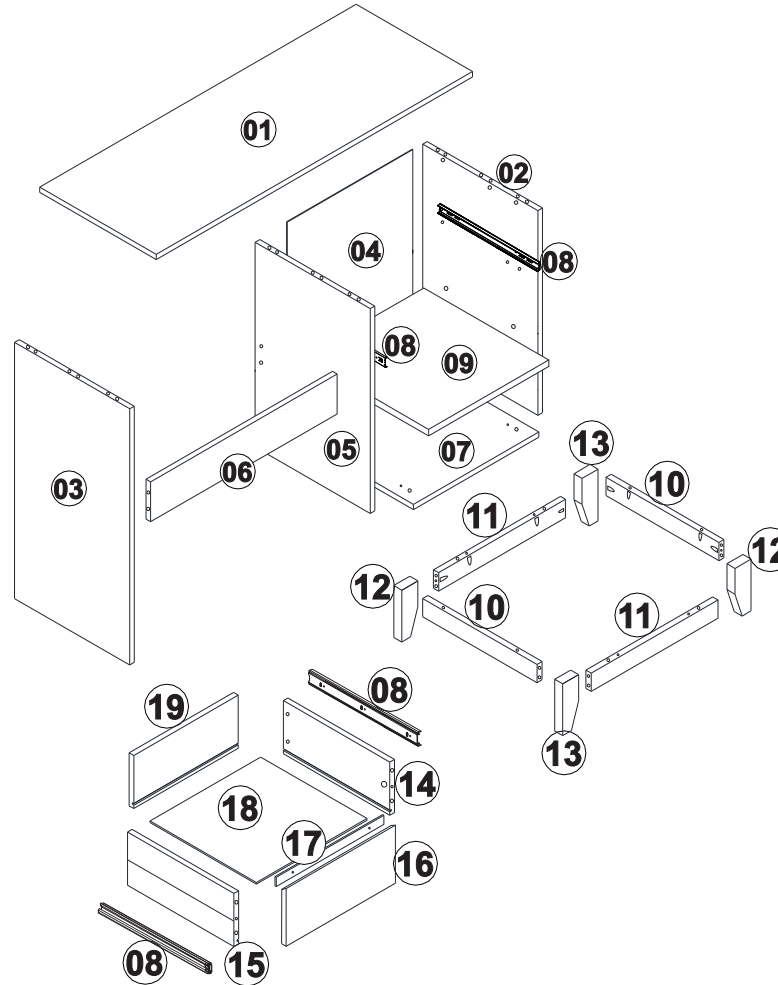
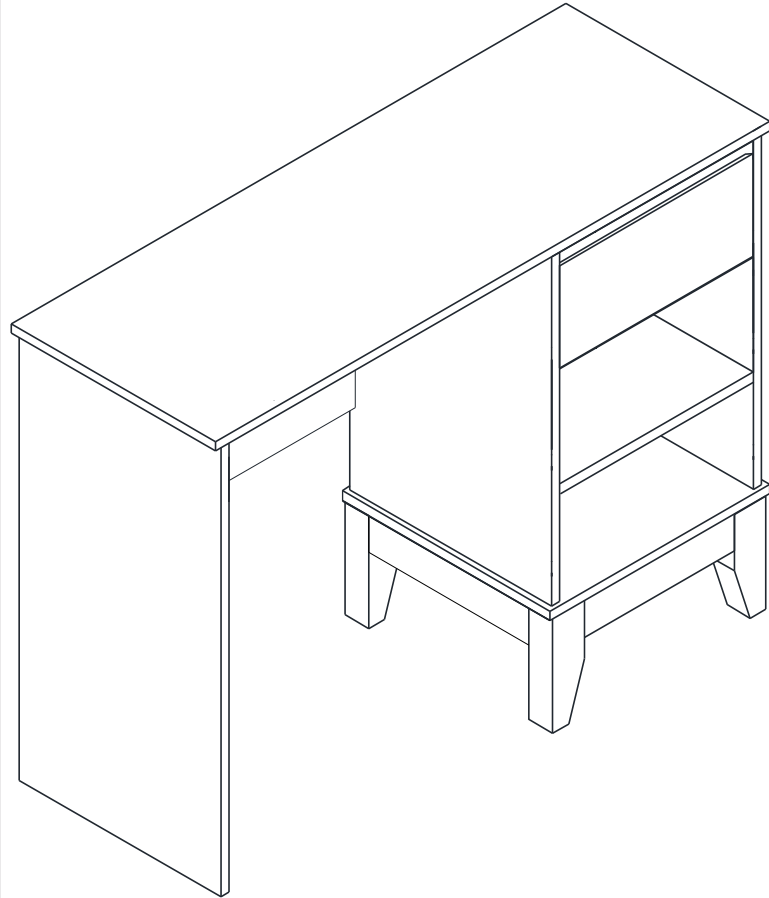
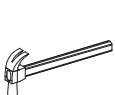
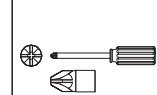

### Lista de peças Parts list / Liste de piezas

	Qt.
1- TAMPO <small>Top / Tapa superior</small>	01
2- LATERAL DIREITA <small>Right side / Lateral derecho</small>	01
3- LATERAL MAIOR <small>Bigger side / Lateral más grande</small>	01
4- FORRO TRASEIRO <small>Back panel / Trasera</small>	01
5- LATERAL ESQUERDA <small>Left side / Lateral izquierdo</small>	01
6- TRAVESSA <small>Crossbeam / travesaño</small>	01
7- BASE <small>Base / Base</small>	01
8- CORREDIÇAS <small>Drawer runners / Carril metalico</small>	02
9- PRATELEIRA <small>Shelf / Estanteria</small>	01
10- TRAVESSA LATERAL <small>Side crossbeam / Travesaño lateral</small>	02
11- TRAVESSA FRONTAL E TRASEIRA <small>Front and back crossbeam / Travesaño frontal y trasero</small>	02
12- PÉ DIREITO <small>Right feet / Pies derecho</small>	02
13- PÉ ESQUERDO <small>Left feet / Pies izquierdo</small>	02
14- LATERAL DIREITA GAVETA <small>Drawer right side / Lateral derecho cajon</small>	01
15- LATERAL ESQUERDA GAVETA <small>Drawer left side / Lateral izquierdo cajon</small>	01
16- FRENTE GAVETA <small>Drawer front / Frente cajon</small>	01
17- APLIQUE GAVETA <small>Drawer apply / Aplicar cajon</small>	01
18- FORRO GAVETA <small>Drawer base / Base cajon</small>	01
19- TRASEIRO GAVETA <small>Drawer back / Trasero cajon</small>	01

V.:05

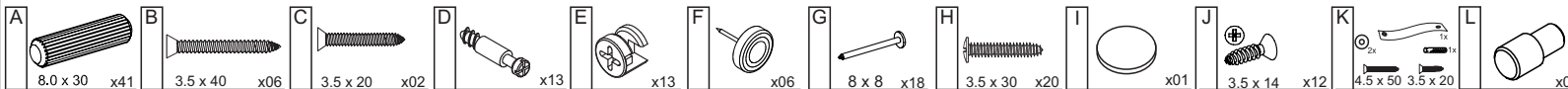

01

Dividir a corredeira 12 em duas partes H1 e H2  
H1 - Fixar nas laterais do móvel.  
H2 - Fixar na lateral da gaveta.

Abriu a corredeira conforme desenho e inclinar levemente a chave (conforme detalhe) para retirar a parte interna H2 que será fixada na gaveta.

Divide slide 12 into two parts H1 and H2  
H1 - Attach to the sides of the unit.  
H2 - Attach to the side of the drawer.

Open the slide as shown in the drawing and tilt it slightly the key (as detailed) to remove the internal part H2 that will be fixed in the drawer.

Divida la diapositiva 12 en dos partes H1 y H2.  
H1 - Fijar a los lados de la unidad.  
H2 - Fijar al lateral del cajón.

Abra la corredera como se muestra en el dibujo e inclínala ligeramente la llave (como se detalla) para quitar la parte interna H2 que se fijará en el cajón.

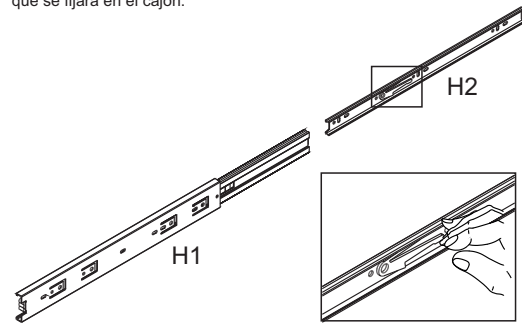

02

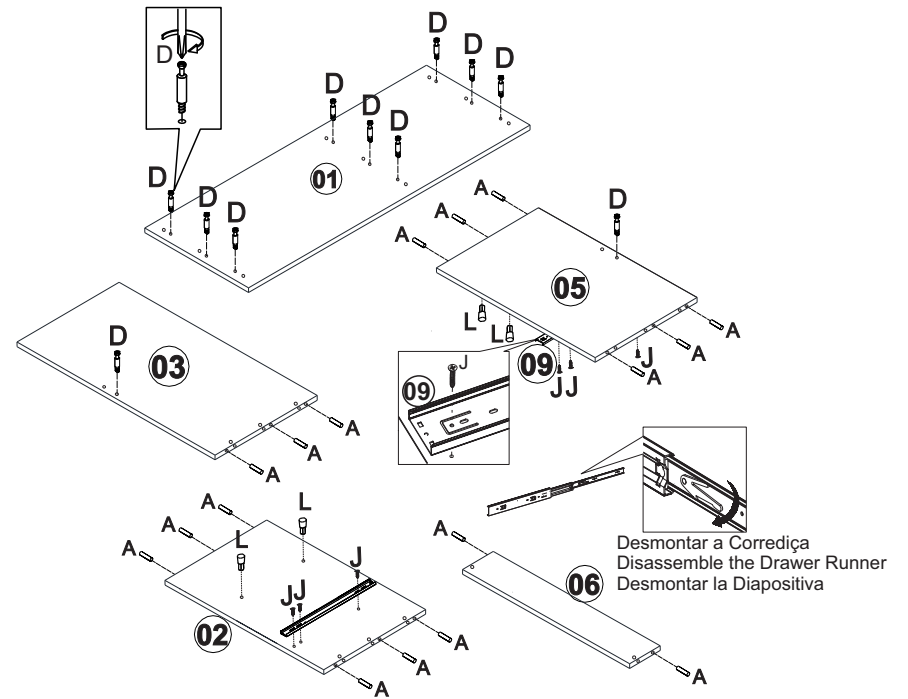

03

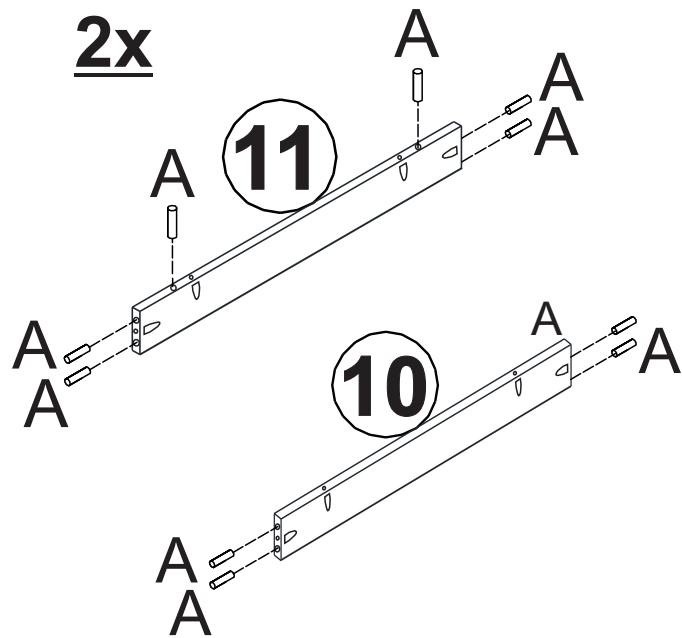

04

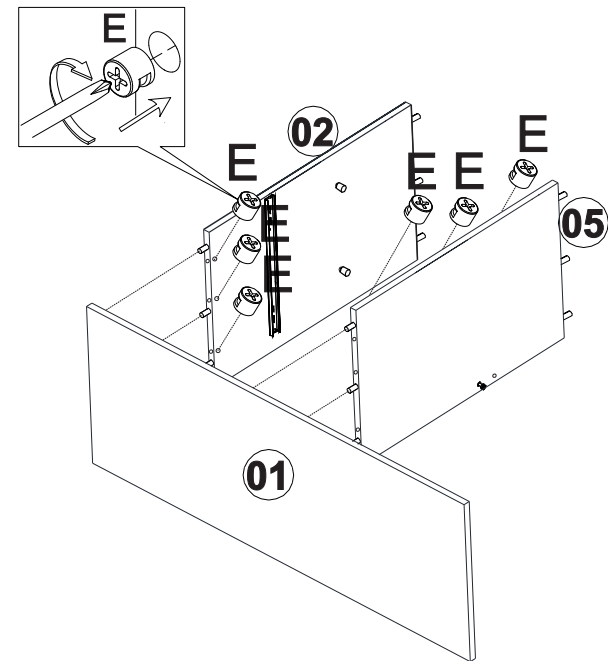

05

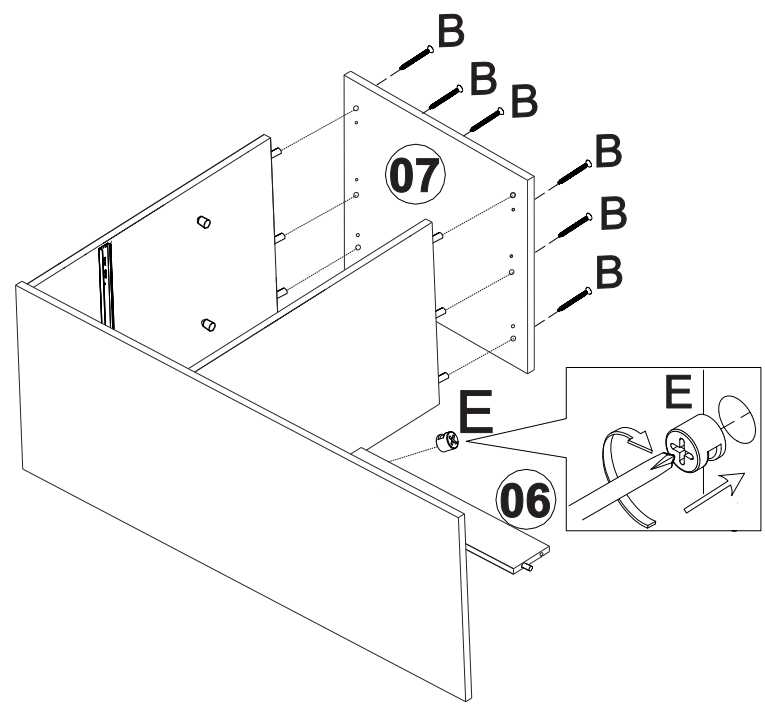

06

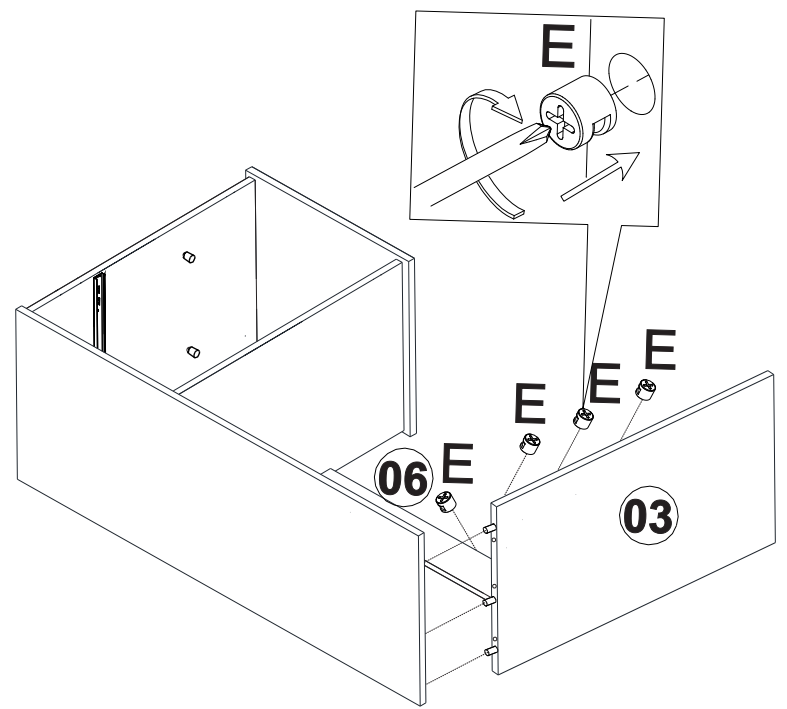

07

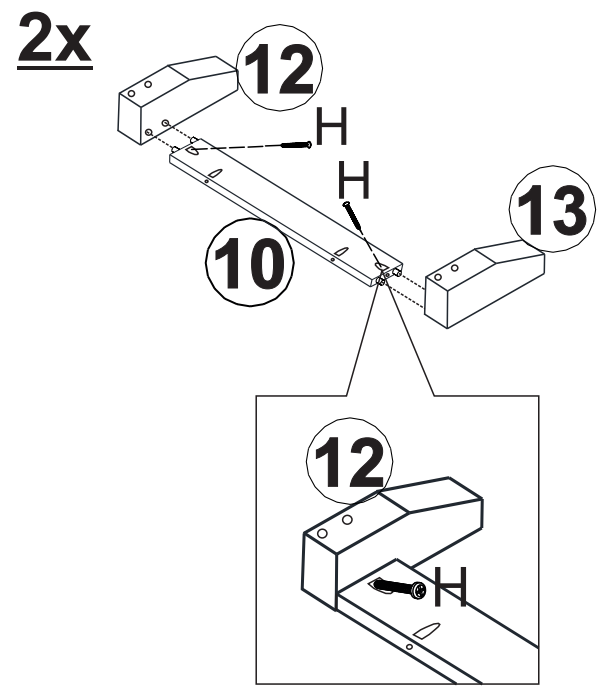

08

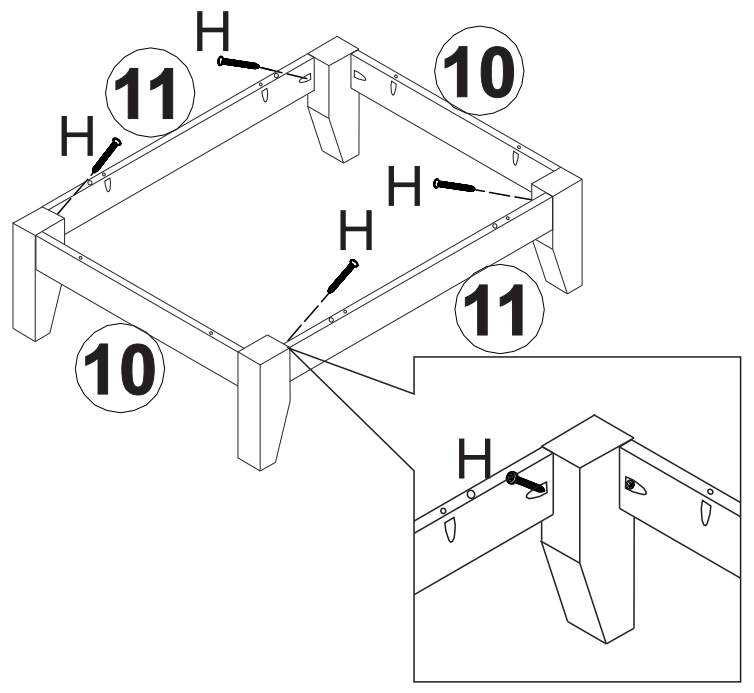

09

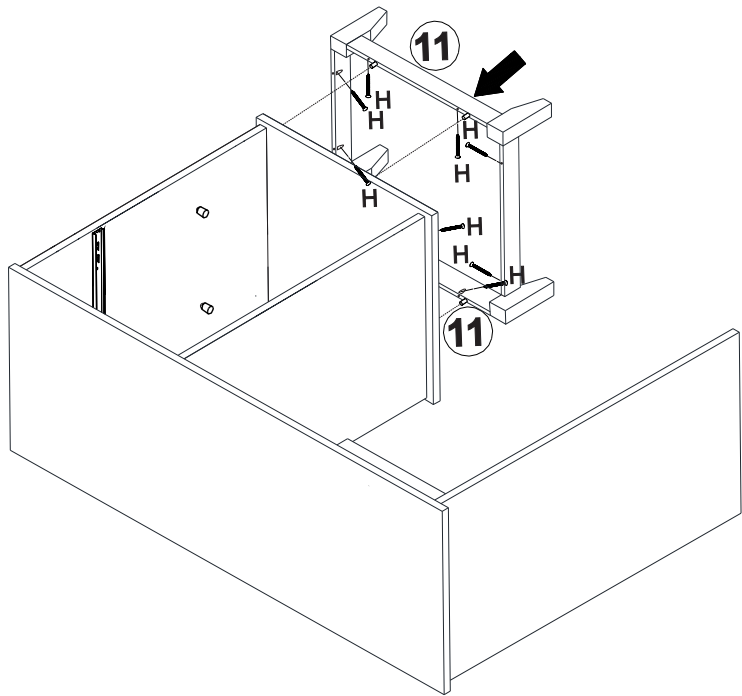

10

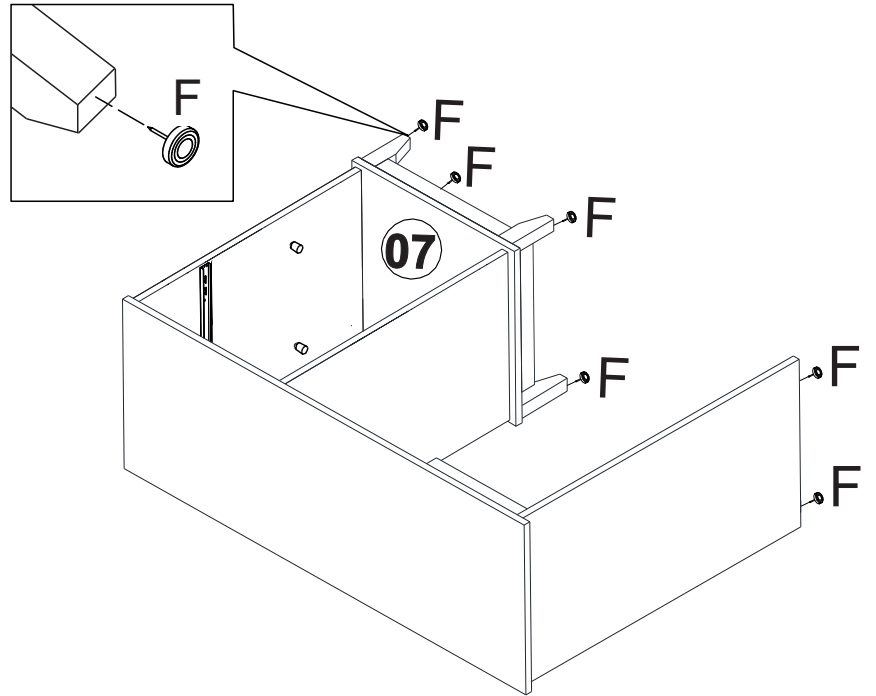

11

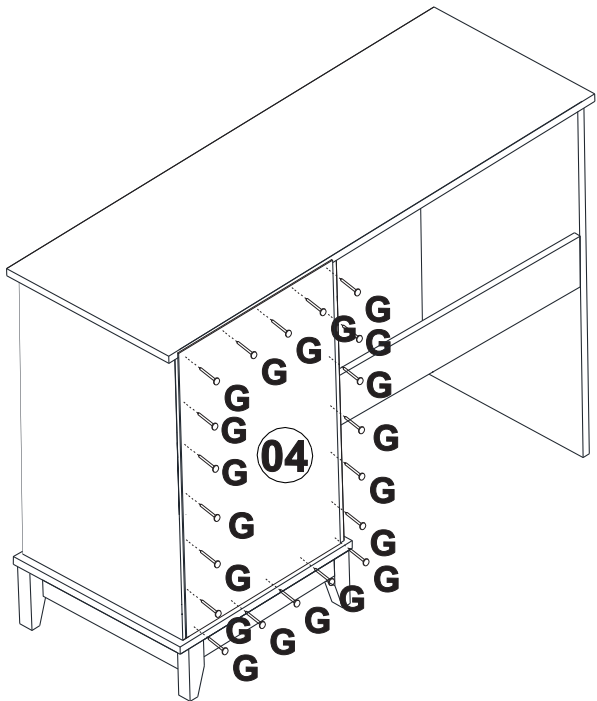

12

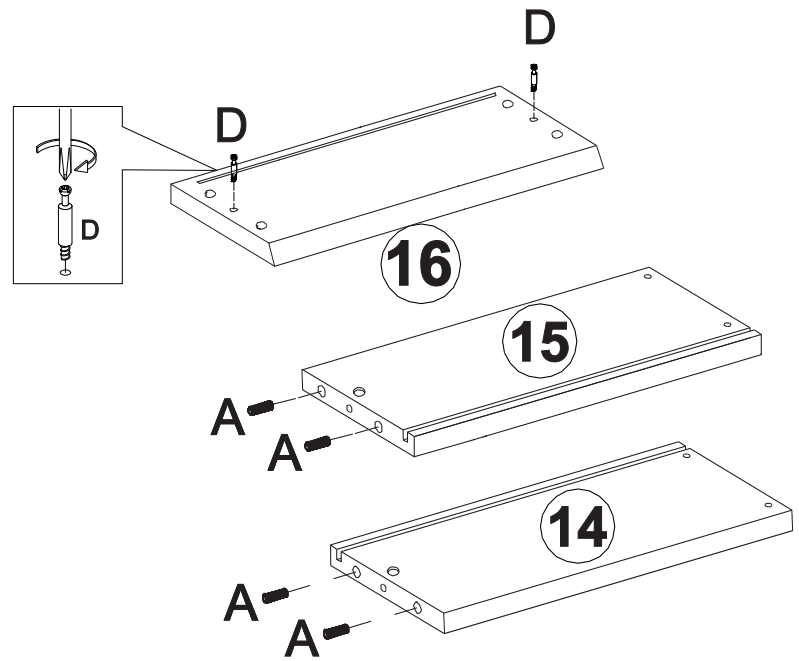

13

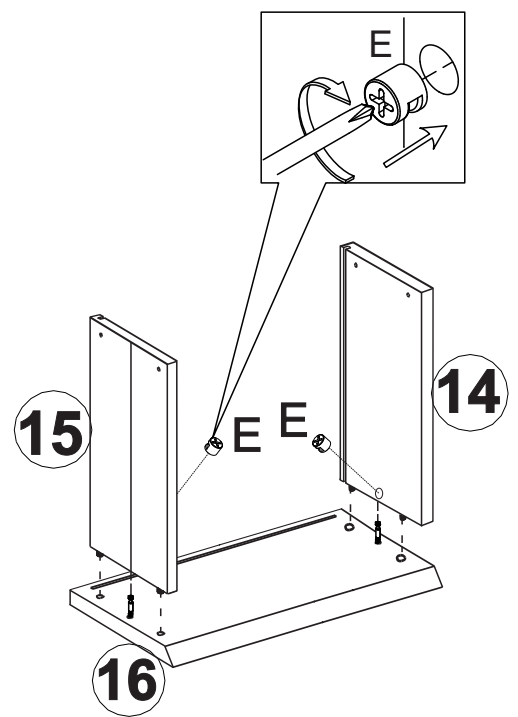

14

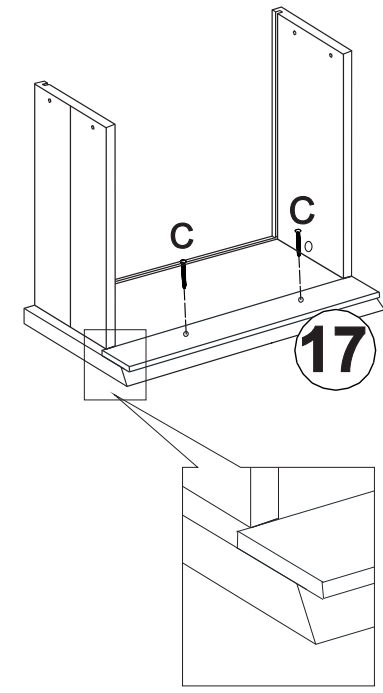

15

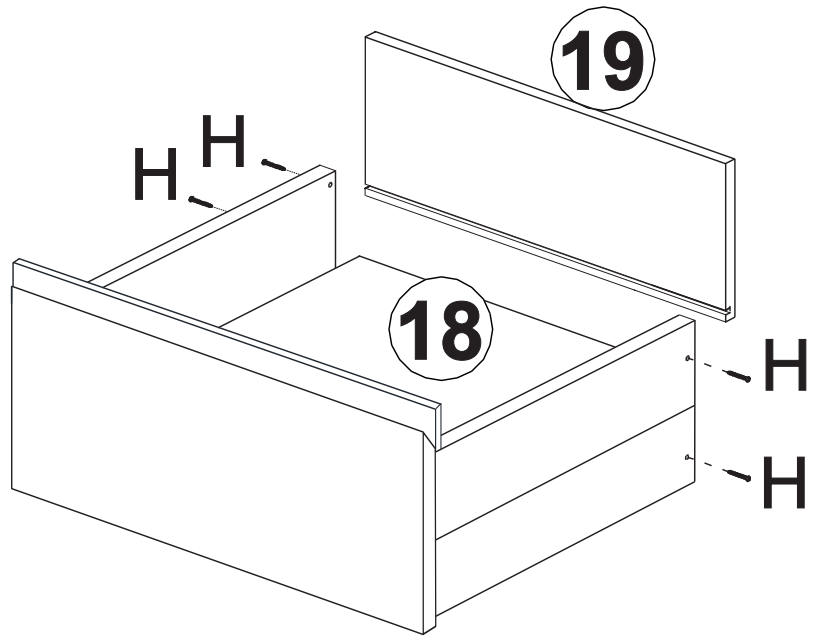

16

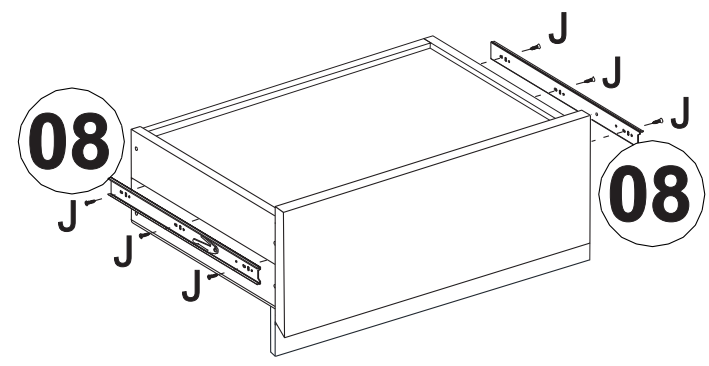

17

# ATENÇÃO

Risco de acidente grave ou sequelas permanentes se o móvel tombar. Para evitar e eliminar o risco, é essencial seguir as seguintes instruções.

- Nunca permita que as crianças subam ou se penduram nas gavetas, portas ou prateleiras do móvel;
- **Utilize a ferragem anti tombamento para reduzir ou eliminar o risco de tombamento deste produto.**

O tipo de parafusos para a fixação de mobiliário na parede, depende do material de parede e não são fornecidos. Em caso de dúvidas, consulte um especialista.

# ATTENTION

Risk of serious accident or permanent sequelae if the mobile topple over. To avoid and eliminate the risk, it is essential follow the following instructions.

- Never allow children to climb or hang from the furniture drawers, doors or shelves;
- **Use anti-tip hardware to reduce or eliminate the risk of this product tipping over.**

The type of screws for fixing furniture to the wall, depends on wall material and are not provided. If in doubt, consult an expert.

# ATENCIÓN

Riesgo de accidente grave o secuelas permanentes si el caído del móvil. Para evitar y eliminar el riesgo, es fundamental siga las siguientes instrucciones.

- Nunca permita que los niños trepen o se cuelgan del muebles cajones, puertas o estantes;
- **Utilice herrajes antivuelco para reducir o elimine el riesgo de que este producto se vuelque.**

El tipo de tornillos para fijar muebles a la pared, depende del material de la pared y no se proporcionan. En caso de duda, consulte a un experto.

18

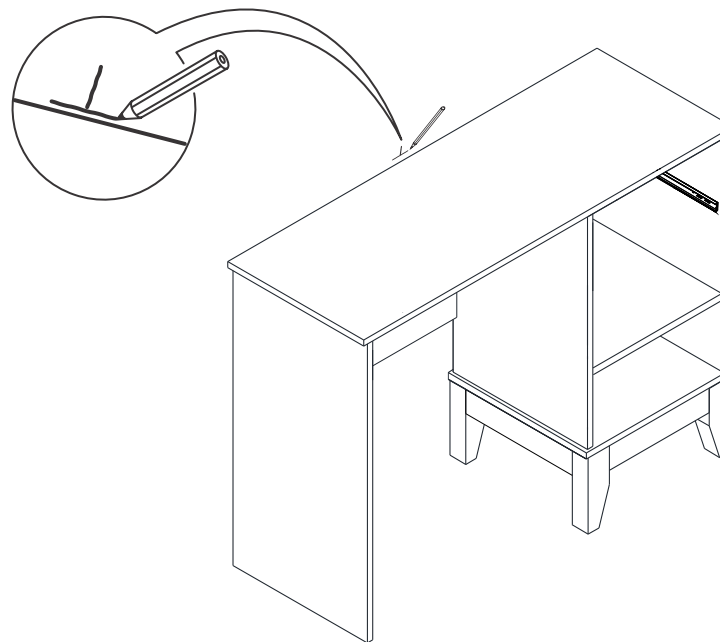

19

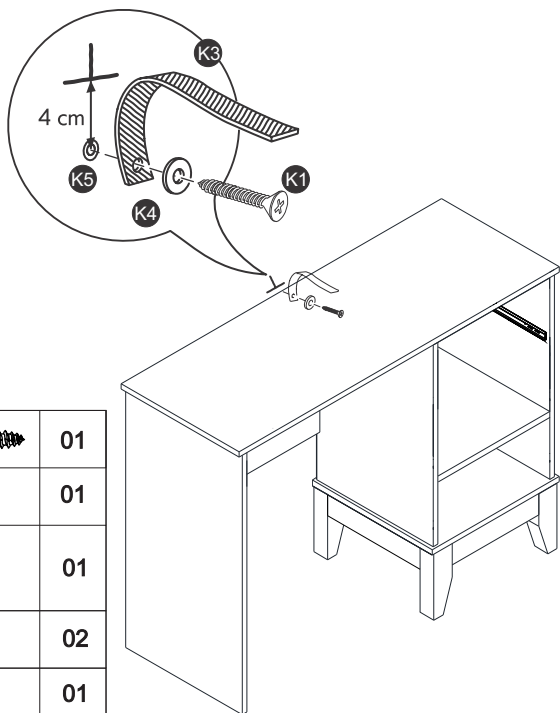

K	K1		01
	K2		01
	K3		01
	K4		02
	K5		01

20

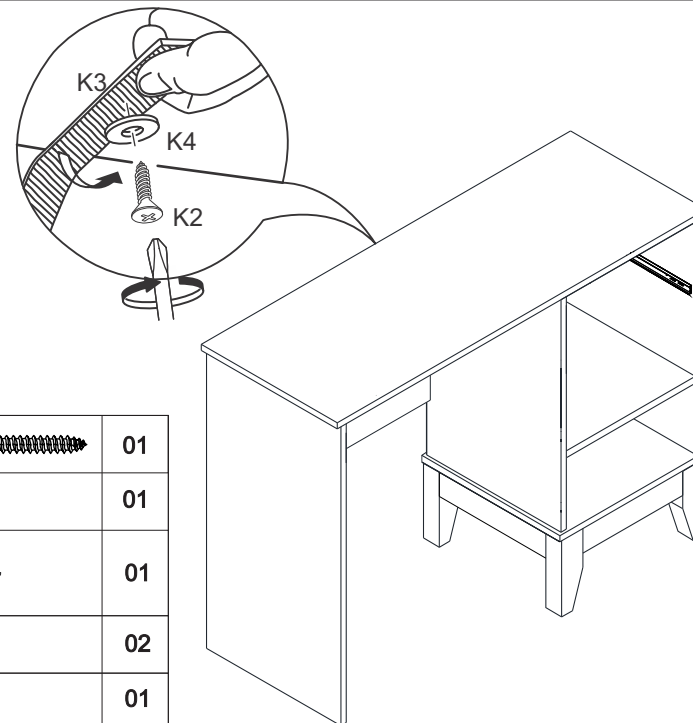

K	K1		01
	K2		01
	K3		01
	K4		02
	K5		01

21

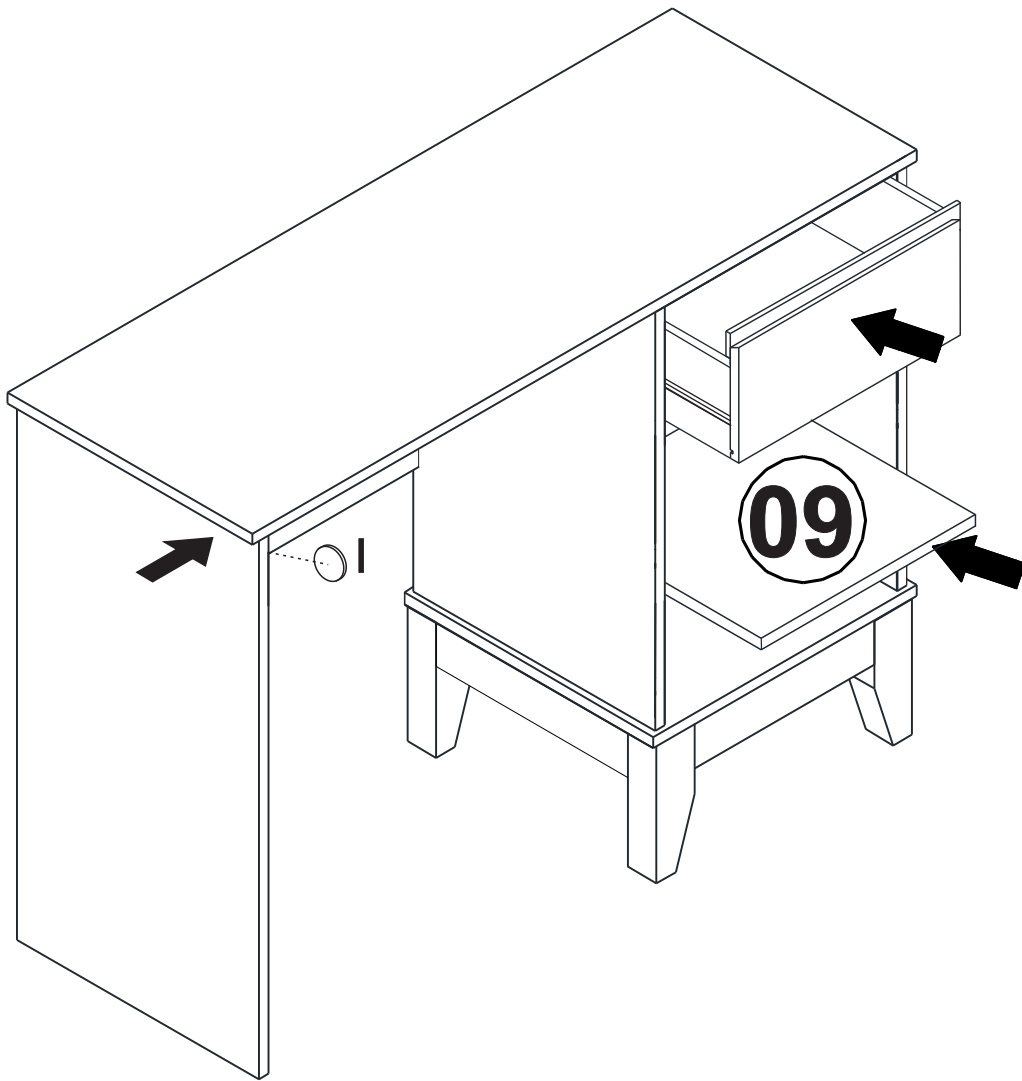

22

